

20 STERN AVE.  
 SPRINGFIELD, NEW JERSEY 07081  
 U.S.A.

TELEPHONE: (201) 376-2  
 (212) 227-6  
 FAX: (201) 376-8

PARAMETERS

2N4126  
 SI PNP LP HF BJT

Description: Si PNP LP HF BJT  
 Manufacturer.....  
 Mil/High-Rel? (Y/N).....  
 Vbr CEO..... 25  
 Trans. Freq (Hz) Min..... 250M  
 hfe.....  
 @VCE (test) (V).....  
 @Ic (A).....  
 Ic Max. (A)..... 200m  
 C(ob) (F).....  
 Icbo Max. @Vcb Max. (A)..... 50nX  
 t(on) Delay (S)..... 43nB.  
 Tr Max. (s).....  
 t(stor) Max. (S).....  
 t(f) Max. (S).....  
 Max. PD (W)..... 350m  
 Derate (Amb) (W/xC)..... 2.8m  
 Vbr CBO..... 25  
 Oper. Temp (xC) Max..... 150u  
 @ Temp (derating) test xC...  
 Oper. Temp (xC) Min.....  
 Pkg Style..... TO-92  
 Surface Mounted (Y/N)..... N  
 Pinout Equivalence Number..... 3-12

$t_j$  - Junction Temperature . B Typical 2 It(rms) X @ Below Vcb(max)  
 . T(on) = td + tr

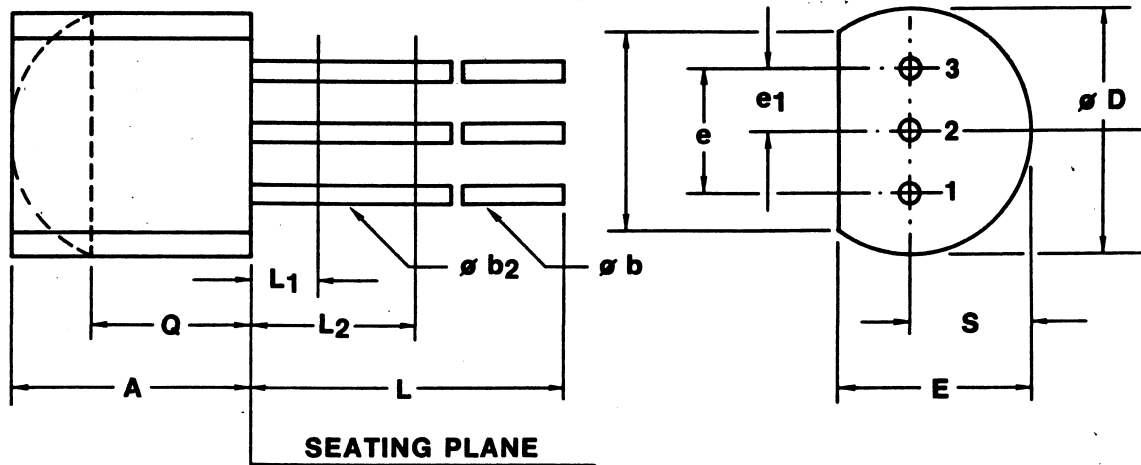

SEATING PLANE

SYMBOL	INCHES		MILLIMETERS		NOTES
	MIN.	MAX.	MIN.	MAX.	
A	.170	.210	4.58	5.33	
Ob	.016	.021	.407	.533	1, 3
Ob2	.016	.019	.407	.482	3
OD	.175	.205	4.98	5.20	
E	.125	.165	3.94	4.19	
e	.095	.105	2.42	2.66	
e1	.045	.055	1.15	1.39	
j	.135		3.43		
L	.500		12.70		1, 3
L1		.050		1.27	3
L2	.250		6.35		3
Q	.115		2.93		2
S	.080	.105	2.42	2.66	

NOTES:

1. Three leads
2. Contour of the package beyond this zone is uncontrolled.
3. (Three leads) Ob2 applies between L1 and L2. Ob applies between L1 and L2 and .5" (12.70 mm) from seating plane. Diameter is uncontrolled in L2 and .5" (12.70 mm) from seating plane.

