

Nut Torque: 5 ~ 14Nm

Operating Pressure: 500gf ±150gf

Operating Stroke: 2.2mm±0.5mm

Protection Grade: IP67, IK08

Function: ON-OFF

Contact: Silver Alloy

Base: PA66

Shell: SUS

Button: SUS

Lamp Type: LED

Forward current : 20mA

Lamp Life: 50000H

Rating(Resistive load): 5A 250V AC

Contact Resistance: 50mΩ MAX

Insulation Resistance: 100MΩ MIN

Dielectric Strength: 1500VAC 1 minute

Electrical life: 50,000 cycles

Mechanical life : 200,000 cycles

Operating Temperature: -20°C~80°C

Relative Air Humidity: 45%~85%

Safety Approval:

CUT-OUT

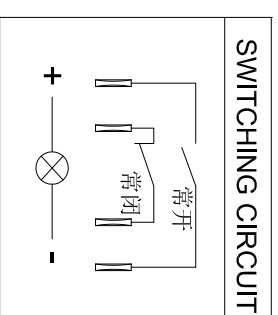
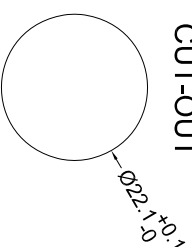

公差 TOLERANCES .X±0.3 .XX±0.15 角度 ANGLE ±1°

单位 DIMENSION UNIT mm.



DSWITCH
东莞市德松电子有限公司
D-SWITCH ELECTRONICS CO.,LTD.

版本 VER	变更说明 CHANGE DESCRIPTION	日期 DATE	ECN NO.	核准 APPROVED BY	核对 CHECKED BY	绘图 DRAWN BY	品名 TITLE	图号 DRAWING NO
							PBM-22232-FT-R1-Q24-S7S-A3	PBM-22232-FT-R1-Q24-S7S-A3_A0