

PLEASE CHECK WWW.MOLEX.COM FOR LATEST PART INFORMATION

Part Number: [0908580477](#)
Status: **Active**
Overview: [rast 5 connector system](#)
Description: 5.00mm (.197") Pitch Appli-Mate RAST 5 Header, Vertical, 2 Circuits, Silver Plating, Reference K12

Documents:

[3D Model](#) [Packaging Specification \(PDF\)](#)
[Drawing \(PDF\)](#) [RoHS Certificate of Compliance \(PDF\)](#)

Agency Certification

CSA LR19980
 UL E29179

General

Product Family PCB Headers
 Series [90858](#)
 Application Wire-to-Board
 Overview [rast 5 connector system](#)
 Product Name RAST 5

Physical

Breakaway No
 Circuits (Loaded) 2
 Circuits (maximum) 2
 Color - Resin Natural
 Durability (mating cycles max) 10
 First Mate / Last Break No
 Flammability 94V-0
 Glow-Wire Compliant No
 Guide to Mating Part No
 Keying to Mating Part None
 Lock to Mating Part None
 Material - Metal Brass
 Material - Plating Mating Silver
 Material - Plating Termination Silver
 Number of Rows 1
 Orientation Vertical
 PC Tail Length (in) 0.138 In
 PC Tail Length (mm) 3.50 mm
 PCB Locator Yes
 PCB Retention None
 PCB Thickness Recommended (in) 0.055 In
 PCB Thickness Recommended (mm) 1.40 mm
 Packaging Type Bag
 Pitch - Mating Interface (in) 0.197 In
 Pitch - Mating Interface (mm) 5.00 mm
 Polarized to PCB Yes
 Shrouded Fully
 Stackable Yes
 Surface Mount Compatible (SMC) No
 Temperature Range - Operating -20°C to +85°C
 Termination Interface: Style Through Hole

Electrical

Current - Maximum per Contact 16A

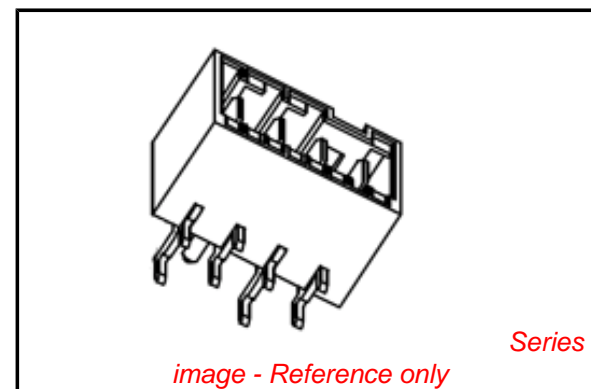

image - Reference only

EU RoHS

ELV and RoHS Compliant
REACH SVHC Contains SVHC: No
Halogen-Free
Status Not Reviewed

China RoHS



Need more information on product environmental compliance?

Email productcompliance@molex.com
 For a multiple part number RoHS Certificate of Compliance, [click here](#)

Please visit the [Contact Us](#) section for any non-product compliance questions.

Search Parts in this Series

[90858Series](#)

Mates With

Appli-Mate 5.0 IDT Connector System
 Female Receptacle [90835](#) , [90833](#)

Voltage - Maximum

250V

Material Info

Reference - Drawing Numbers

Packaging Specification

PK-90858-001

Sales Drawing

SD-90858-001

This document was generated on 06/08/2010

PLEASE CHECK WWW.MOLEX.COM FOR LATEST PART INFORMATION

13 12 11 10 9 8 7 6 5 4 3 2 1

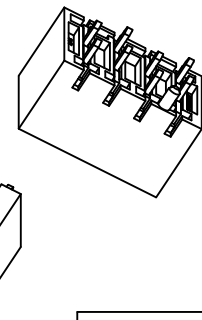
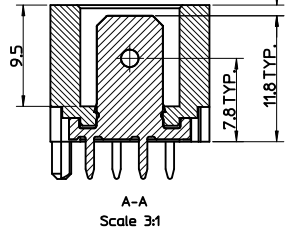
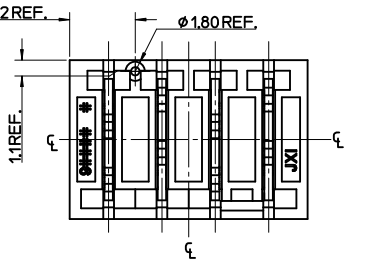
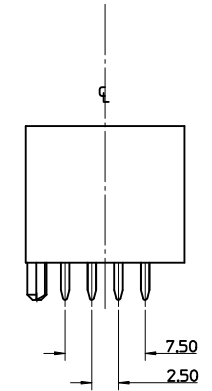
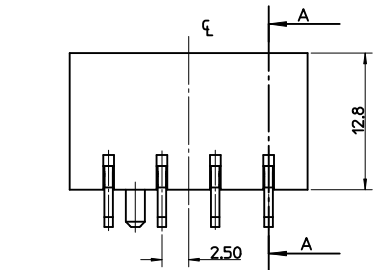
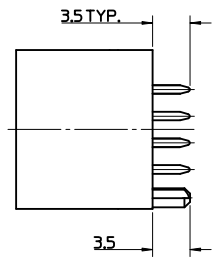
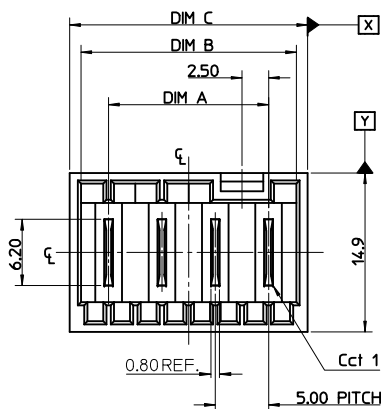

HOLES ON SOME TOOLED VERSIONS

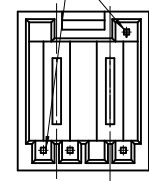

| CCT | DIM A | DIM B | DIM C | TOL |
|-----|-------|-------|-------|---------|
| 2 | 5.00 | 10.20 | 12.30 | |
| 3 | 10.00 | 15.20 | 17.30 | |
| 4 | 15.00 | 20.20 | 22.30 | |
| 5 | 20.00 | 25.20 | 27.30 | |
| 6 | 25.00 | 30.20 | 32.30 | +/-0.30 |
| 7 | 30.00 | 35.20 | 37.30 | |
| 8 | 35.00 | 40.20 | 42.30 | |
| 9 | 40.00 | 45.20 | 47.30 | |
| 10 | 45.00 | 50.20 | 52.30 | |
| 11 | 50.00 | 55.20 | 57.30 | |
| 12 | 55.00 | 60.20 | 62.30 | |

RECOMMENDED PCB LAYOUT

P.C.B. POLARISATION OPTION 'B'

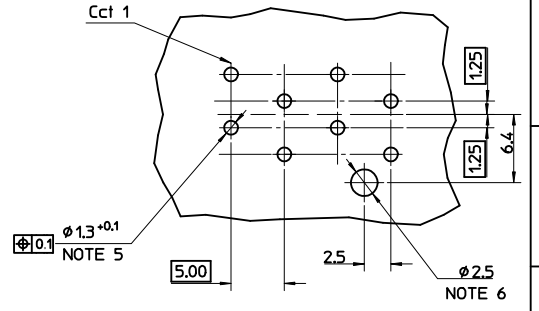
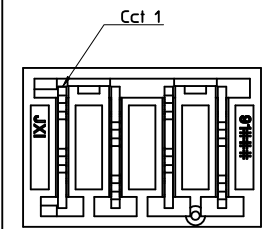

P.C.B. POLARISATION OPTION 'A'

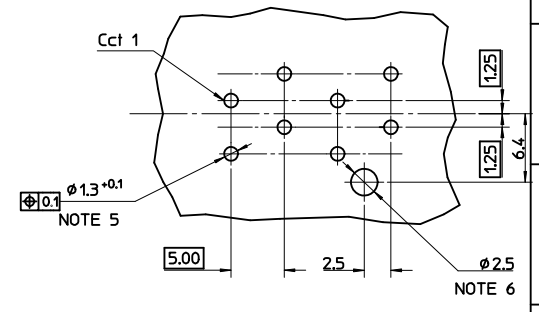
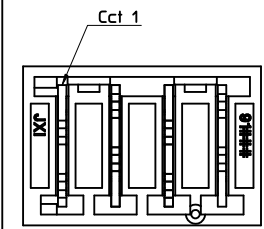

- NOTES:
- MATERIALS
HOUSING: 30% GLASS-FILLED PBT, UL94 V-0
TERMINAL: BRASS 0.80REF. THICK
PLATING: OPTIONAL (SEE CHARTS SHEETS 2-9)
5µm TIN OVER
2.5µm NICKEL ALLOVER
SELECTIVE SILVER
2µm MIN SILVER
2.5µm NICKEL ALLOVER
 - PRODUCT CONFORMS TO SPECIFICATION PS-99020-0037
 - MATES WITH MOLEX 91338, 90833, 90835, 91777, 91778 & 91779
 - PARTS PACKAGED LOOSE IN PLASTIC BAGS
 - PLATED THRU HOLE
 - NON-PLATED THRU HOLE
 - RECOMMENDED PCB THICKNESS: 1.4±0.1mm
 - PCB VIEW IS FROM SOLDER SIDE

| | | | | | | | |
|---|---------------------|---|--|-----------------------------------|---------------------|---------------------------------|---------------------------|
| MOULD PROCESS CHANGE EC NO: E2010-0370 DRAWN: BRUTTLE 2010/05/13 CHKD: IDENEY 2004/05/27 APPR: BMAGUIRE 2010/06/08 | QUALITY SYMBOLS | GENERAL TOLERANCES (UNLESS SPECIFIED) | | DIMENSION STYLE MM ONLY | SCALE 1:1 | DESIGN UNITS METRIC | THIRD ANGLE PROJECTION |
| | | 4 PLACES ± --- ± --- 3 PLACES ± 0.1 ± --- 2 PLACES ± 0.2 ± --- 1 PLACE ± 0.2 ± --- | mm INCH ± --- ± --- ± 0.1 ± --- ± 0.2 ± --- | DRAWN BY NMCNAMAR | DATE 2004/05/26 | TITLE RAST 5 VERT HDR | MOLEX INCORPORATED |
| MATERIAL NO. SD-90858-001 | SHEET NO. 1 OF 7 | THIS DRAWING CONTAINS INFORMATION THAT IS PROPRIETARY TO MOLEX INCORPORATED AND SHOULD NOT BE USED WITHOUT WRITTEN PERMISSION | | | | | |

12 11 10 9 8 7 6 5 4 3 2 1

| 2 CIRCUIT | | SEE CODE DESIGNATION TABLE FOR NUMBERING FORMAT WHEN ADDING NEW PART NUMBERS | | | | | | P.C.B. POLARISATION OPTION |
|-------------------|---------|---|--------------------------|-------------------|------------------------------|-----|----------------------|----------------------------------|
| PART NO. (TIN) | CLOUR | UNBLOCKED POSITION KEYS | UNBLOCKED CODING KEYS | LATCH POSITION | CONFIGURATION (SEE NOTES) | REF | PART NO. (SILVER) | |
| 90858-0003 | NATURAL | 1b 2a | 01c d20 | 1/2 | | K01 | 90858-0499 | A |
| 90858-0004 | NATURAL | 1a 2b | 01c | 1/2 | | K02 | 90858-0482 | A |
| 90858-0007 | NATURAL | 1b 2b | 01c | 1/2 | | K09 | 90858-0497 | A |
| 90858-0018 | NATURAL | 2a | 01c, d20 | 1/2 | | K03 | 90858-0495 | A |
| 90858-0019 | NATURAL | 1a 2b | d20 | 1/2 | | K05 | 90858-0478 | A |
| 90858-0021 | NATURAL | 1b | 01c, d20 | 1/2 | | K16 | 90858-0492 | A |
| 90858-0022 | NATURAL | 1a 2b | NONE | 1/2 | | K06 | 90858-0491 | A |
| 90858-0027 | NATURAL | 2b | NONE | 1/2 | | K11 | 90858-0487 | A |
| 90858-0029 | NATURAL | 1a 1b | d20 | 1/2 | | K13 | 90858-0486 | A |
| 90858-0030 | NATURAL | 2a 2b | NONE | 1/2 | | K31 | 90858-0485 | A |
| 90858-0032 | NATURAL | 2b | d20 | 1/2 | | K38 | 90858-0484 | A |
| 90858-0047 | NATURAL | 1a 2a | 01c d20 | 1/2 | | K44 | 90858-0483 | A |
| 90858-0055 | NATURAL | 1a 1b | NONE | 1/2 | | K40 | 90858-0480 | A |
| 90858-0020 | NATURAL | 1a 1b | 01c | 1/2 | | K04 | 90858-0475 | A |
| 90858-0054 | NATURAL | 2b | 01c d20 | 1/2 | | K15 | 90858-0476 | A |
| 90858-0057 | NATURAL | 1a | 01c d20 | 1/2 | | K12 | 90858-0477 | A |
| 90858-0058 | NATURAL | 1a 2a | 01c | 1/2 | | K10 | 90858-0472 | A |
| 90858-0059 | NATURAL | ALL | d20 | 1/2 | | K34 | 90858-0474 | A |
| 90858-0060 | NATURAL | 1b 2a 2b | d20 | 1/2 | | K07 | 90858-0473 | A |
| 90858-0061 | NATURAL | 1b 2a | 01c d20 | 1/2 | | K01 | 90858-0471 | B |
| | | | | | | | | |
| | | | | | | | | |
| | | | | | | | | |

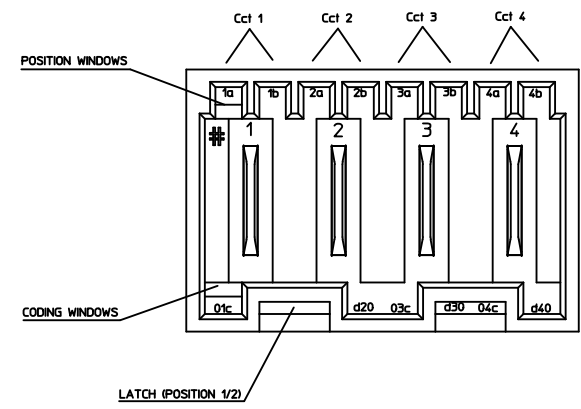

KEYING, CODING & LATCH POSITION
(4CCT EXAMPLE SHOWN)
VIEW INMATING DIRECTION

| | | | | | | | |
|---|--|--|---|------------------------------------|---------------------|--|--|
| SEE SHEET 1 EC NO: E2010-0370 DRN:BRUTLE 2010/05/13 CHKD:JDENNEY 2004/05/27 APPR:BMAGUIRE 2010/06/08 | QUALITY SYMBOLS | GENERAL TOLERANCES (UNLESS SPECIFIED) | DIMENSION STYLE | SCALE | DESIGN UNITS | THIRD ANGLE PROJECTION | |
| | $\nabla=0$ $\nabla=0$ | mm INCH 4 PLACES ± --- ± --- 3 PLACES ± --- ± --- 2 PLACES ± 0.1 ± --- 1 PLACE ± 0.2 ± --- ANGULAR ± 2 ° | MM ONLY DRAWN BY DATE NMCNAR 2004/05/26 CHECKED BY DATE JDENNEY 2004/05/27 APPROVED BY DATE BMAGUIRE 2004/05/28 | 1:1 | METRIC | <input checked="" type="checkbox"/> THIRD ANGLE PROJECTION | |
| | DRAFT WHERE APPLICABLE MUST REMAIN WITHIN DIMENSIONS | SEE CHART | MATERIAL NO. SD-90858-001 | MOLEX INCORPORATED DOCUMENT NO. | SHEET NO. 2 OF 7 | RAST 5 VERT HDR | |
| | THIS DRAWING CONTAINS INFORMATION THAT IS PROPRIETARY TO MOLEX INCORPORATED AND SHOULD NOT BE USED WITHOUT WRITTEN PERMISSION | | | | | | |

3 CIRCUIT

SEE CODE DESIGNATION TABLE FOR NUMBERING
FORMAT WHEN ADDING NEW PART NUMBERS

| PART NO. (TIN) | COLOUR | UNBLOCKED POSITION KEYS | UNBLOCKED CODING KEYS | LATCH POSITION | CONFIGURATION (SEE NOTES) | REF | PART NO. (SILVER) | P.C.B. POLARISATION OPTION |
|-------------------|---------|----------------------------|--------------------------|-------------------|------------------------------|-----|----------------------|----------------------------------|
| 90858-0502 | NATURAL | 1b | 01c, d20 | 1/2 | | K01 | 90858-1249 | A |
| 90858-0508 | NATURAL | 1a | 03c | 1/2 | | K04 | 90858-1248 | A |
| 90858-0511 | NATURAL | 1a 1b | d30 | 1/2 | | K05 | 90858-1247 | A |
| 90858-0512 | NATURAL | 1a 3b | 01c | 1/2 | | K06 | 90858-1246 | A |
| 90858-0513 | NATURAL | 1b | d20 03c | 1/2 | | K09 | 90858-1245 | A |
| 90858-0524 | NATURAL | 1b 2a 2b | d30 | 1/2 | | K33 | 90858-1244 | A |
| 90858-0525 | NATURAL | 2b | d20 | 1/2 | | K56 | 90858-1243 | A |
| 90858-0528 | NATURAL | ALL | d10 d30 | 2/3 | | K38 | 90858-1242 | A |
| 90858-0527 | NATURAL | ALL | d20 | 1/2 | | K40 | 90858-1240 | A |
| 90858-0526 | NATURAL | 2b 3b | d10 02c | 2/3 | | K02 | 90858-1241 | A |
| 90858-0529 | NATURAL | 1b | 01c d20 | 1/2 | | | 90858-1239 | A |
| 90858-0530 | NATURAL | 3b | d10, d30 | 2/3 | | | 90858-1238 | A |
| 90858-0531 | NATURAL | 3b | 01c, d30 | 2/3 | | | 90858-1237 | A |
| 90858-0532 | NATURAL | 3b | d10, 02c | 2/3 | | | 90858-1236 | A |
| | | | | | | | | |
| | | | | | | | | |

4 CIRCUIT

SEE CODE DESIGNATION TABLE FOR NUMBERING
FORMAT WHEN ADDING NEW PART NUMBERS

| PART NO. (TIN) | COLOUR | UNBLOCKED POSITION KEYS | UNBLOCKED CODING KEYS | LATCH POSITION | CONFIGURATION (SEE NOTES) | REF | PART NO. (SILVER) | P.C.B. POLARISATION OPTION |
|-------------------|---------|----------------------------|--------------------------|-------------------|------------------------------|-----|----------------------|----------------------------------|
| 90858-1254 | NATURAL | 1b | 03c d40 | 1/2 3/4 | | K01 | 90858-1999 | A |
| 90858-1264 | NATURAL | 1a 4b | d40 | 1/2 3/4 | | K03 | 90858-1998 | A |
| 90858-1265 | NATURAL | 2a 4b | d20 | 1/2 3/4 | | K07 | 90858-1996 | A |
| 90858-1267 | NATURAL | 1b 2a 3a 4b | 01c d40 | 1/2 3/4 | | K37 | 90858-1994 | A |
| 90858-1270 | NATURAL | 1a 2b 4b | 01c 03c d40 | 1/2 3/4 | | K44 | 90858-1993 | A |
| 90858-1274 | NATURAL | 1a 3a 3b | 01c d20 d40 | 1/2 3/4 | | K32 | 90858-1992 | A |
| 90858-1275 | NATURAL | 1b 2a 4b | 01c d20 03c | 1/2 3/4 | | K61 | 90858-1991 | A |
| 90858-1278 | NATURAL | 1a 3a | d40 | 1/2 3/4 | | K06 | 90858-1987 | A |
| 90858-1280 | NATURAL | 1a 2b 3b 4a | 01c 03c d40 | 1/2 3/4 | | K65 | 90858-1988 | A |
| 90858-1281 | NATURAL | 2a 4b | d20 03c | 1/2 3/4 | | K30 | 90858-1986 | A |
| 90858-1282 | NATURAL | 3b | d30 | 2/3 | | K04 | 90858-1985 | A |
| 90858-1283 | NATURAL | 1b 2a 4b | 01c d20 03c d40 | 1/2 3/4 | | N/A | 90858-1984 | A |
| 90858-1284 | NATURAL | 2a 3a 3b 4b | 01c d20 03c d40 | 1/2 3/4 | | N/A | 90858-1983 | A |
| | | | | | | | | |
| | | | | | | | | |
| | | | | | | | | |

| | | | | | | | | | | |
|--|-------------------------|--|--|--|--|---|------------------------|----------------------------|---------------------------------|--|
| SEE SHEET 1 EEC NO: E2010-0370 DRAWN BY: DRWNBRUTLE CHECKED BY: CHKD.DENNEHY APPROVED BY: APPR.BMAGUIRE 2010/05/13 2004/05/27 2010/06/08 | QUALITY SYMBOLS | GENERAL TOLERANCES (UNLESS SPECIFIED) mm INCH 4 PLACES ± --- ± --- 3 PLACES ± --- ± --- 2 PLACES ± 0.1 ± --- 1 PLACE ± 0.2 ± --- ANGULAR ± 2 ° | | DIMENSION STYLE MM ONLY DRAWN BY DATE NMCNAMAR 2004/05/26 CHECKED BY DATE JDENNEHY 2004/05/27 APPROVED BY DATE BMAGUIRE 2004/05/28 | | SCALE 1:1 | DESIGN UNITS METRIC | THIRD ANGLE PROJECTION | TITLE RAST 5 VERT HDR | |
| | | DRAFT WHERE APPLICABLE MUST REMAIN WITHIN DIMENSIONS | | SEE CHART | | MATERIAL NO. DOCUMENT NO. SD-90858-001 | | MOLEX INCORPORATED | | |
| | | | | | | | | SHEET NO. 3 OF 7 | | |
| | | THIS DRAWING CONTAINS INFORMATION THAT IS PROPRIETARY TO MOLEX INCORPORATED AND SHOULD NOT BE USED WITHOUT WRITTEN PERMISSION | | | | | | | | |

5 CIRCUIT

SEE CODE DESIGNATION TABLE FOR NUMBERING
FORMAT WHEN ADDING NEW PART NUMBERS

| PART NO. (TIN) | COLOUR | UNLOCKED POSITION KEYS | UNLOCKED CODING KEYS | LATCH POSITION | CONFIGURATION (SEE NOTES) | REF | PART NO. (SILVER) | P.C.B. POLARISATION OPTION |
|-------------------|---------|---------------------------|-------------------------|-------------------|------------------------------|-----|----------------------|----------------------------------|
| 90858-2000 | NATURAL | 1a 5b | 01c d30 | 1/2 2/3 | | K01 | 90858-2749 | A |
| 90858-2001 | NATURAL | 1a 3a | 01c d30 | 1/2 4/5 | | K30 | 90858-2748 | A |
| 90858-2002 | NATURAL | 1a 5b | 01c d20 03c d50 | 1/2 3/4 | | K31 | 90858-2747 | A |
| 90858-2003 | NATURAL | 1b 2a 3b 5a | 01c 03c | 1/2 3/4 | | K35 | 90858-2746 | A |
| 90858-2004 | NATURAL | 1a 2a 2b 4b 5b | 01c d30 04c d50 | 1/2 2/3 4/5 | | K36 | 90858-2745 | A |
| 90858-2006 | NATURAL | 2a | 01c d50 | 2/3 4/5 | | K43 | 90858-2742 | A |
| 90858-2012 | NATURAL | 2a 4b | 01c d20 d40 | 1/2 3/4 | | K44 | 90858-2743 | A |
| 90858-2013 | NATURAL | 2b | d20 | 1/2 4/5 | | K02 | 90858-2741 | A |
| 90858-2014 | NATURAL | 4b 5a | 01c d30 04c d50 | 1/2 4/5 | | K45 | 90858-2740 | A |
| 90858-2015 | NATURAL | NONE | 01c d40 | 1/2 3/4 | | K46 | 90858-2739 | A |
| 90858-2017 | NATURAL | 1a 4a | d30 | 1/2 4/5 | | K04 | 90858-2737 | A |
| 90858-2024 | NATURAL | 1a 5b | d20 d40 | 1/2 3/4 | | K77 | 90858-2732 | A |
| 90858-2025 | NATURAL | 2b | d20 d50 | 1/2 3/4 | | K95 | 90858-2733 | A |
| 90858-2026 | NATURAL | 1a 5b | 01c d20 03c d50 | 1/2 3/4 | | | 90858-2734 | A |
| 90858-2027 | NATURAL | 1a 3a 4b 5a | 03c 04c | 1/2 4/5 | | K73 | 90858-2735 | A |
| 90858-2028 | NATURAL | 2b | d20 | 1/2 4/5 | | | 90858-2731 | A |
| 90858-2029 | NATURAL | 1b 2a 4a | 01c 04c d50 | 1/2 4/5 | | K51 | 90858-2730 | A |
| 90858-2030 | NATURAL | 2b 3b 4a | 01c d20 d40 | 1/2 3/4 | | K52 | 90858-2729 | A |
| 90858-2031 | NATURAL | 1a 5b | 01c d20 03c d50 | 1/2 4/5 | | K86 | 90858-2728 | A |
| 90858-2032 | NATURAL | 1a 1b 4a | d30 04c d50 | 1/2 4/5 | | K64 | 90858-2727 | A |
| 90858-2033 | NATURAL | 1a 5b | 01c d20 03c d50 | 1/2 3/4 | | | 90858-2726 | B |

6 CIRCUIT

SEE CODE DESIGNATION TABLE FOR NUMBERING
FORMAT WHEN ADDING NEW PART NUMBERS

| PART NO. (TIN) | COLOUR | UNLOCKED POSITION KEYS | UNLOCKED CODING KEYS | LATCH POSITION | CONFIGURATION (SEE NOTES) | REF | PART NO. (SILVER) | P.C.B. POLARISATION OPTION |
|-------------------|---------|---------------------------|-------------------------|-------------------|------------------------------|-----|----------------------|----------------------------------|
| 90858-2753 | NATURAL | 1b | 03c d60 | 1/2 4/5 | | K01 | 90858-3499 | A |
| 90858-2754 | NATURAL | 1a 3b 4b | 01c d50 06c | 1/2 4/5 | | K30 | 90858-3498 | A |
| 90858-2755 | NATURAL | 1a 1b 2b 3a 3b 4b | d30 04c d50 | 1/2 2/3 4/5 | | K37 | 90858-3497 | A |
| 90858-2756 | NATURAL | 1a 1b 4a 4b | d10 d50 | 2/3 4/5 | | K39 | 90858-3496 | A |
| 90858-2757 | NATURAL | 2a 4b 5a 6b | d20 03c 05c | 1/2 3/4 5/6 | | K42 | 90858-3495 | A |
| 90858-2758 | NATURAL | 1a 2b 3a 3b 5b 6b | 01c d40 d60 | 1/2 3/4 5/6 | | K43 | 90858-3494 | A |
| 90858-2759 | NATURAL | 1b 2a 3a 4b 5a 5b 6b | 01c 03c d60 | 1/2 3/4 5/6 | | K44 | 90858-3493 | A |
| 90858-2761 | NATURAL | 2b | d20 d60 | 1/2 5/6 | | K46 | 90858-3492 | A |
| 90858-2762 | NATURAL | 2b 3b 4a | 01c d50 06c | 1/2 4/5 | | K36 | 90858-3491 | A |
| 90858-2768 | NATURAL | 1b 4b | d20 03c d50 06c | 1/2 4/5 | | K58 | 90858-3486 | A |
| 90858-2769 | NATURAL | 1a 2b 3b 4a 6b | 01c 03c d40 05c d60 | 1/2 3/4 5/6 | | K59 | 90858-3485 | A |
| 90858-2770 | NATURAL | 1a 2b 4a 6b | 01c d40 | 1/2 3/4 5/6 | | K62 | 90858-3484 | A |
| 90858-2771 | NATURAL | 1b 6b | d40 | 1/2 5/6 | | K04 | 90858-3483 | A |
| 90858-2772 | NATURAL | 1b 2a 3a 4b 5a 5b 6b | 01c d60 | 2/3 5/6 | | K15 | 90858-3482 | A |
| | | | | | | | | |
| | | | | | | | | |

| | | | | | | | | | |
|--|--|-------------------------------|---------------------------------------|----------------------|---|---------------------|------------------------------|---|------------------------|
| SEE SHEET 1 EC NO: E2010-0370 DRAWN BY: DRW/BRUTTLE CHKD: JDENNEY APPR: BMAGUIRE | 2010/05/13 2004/05/27 2010/06/08 | QUALITY SYMBOLS ▽=0 ▽=0 | GENERAL TOLERANCES (UNLESS SPECIFIED) | | DIMENSION STYLE MM ONLY | | SCALE 1:1 | DESIGN UNITS METRIC | THIRD ANGLE PROJECTION |
| | | | m | INCH | DRAWN BY DATE NMCNAMAR 2004/05/26 | | TITLE RAST 5 VERT HDR | | |
| | | | 4 PLACES ± --- ± --- | 3 PLACES ± --- ± --- | CHECKED BY DATE JDENNEY 2004/05/27 | | MOLEX INCORPORATED | | |
| | | | 2 PLACES ± 0.1 ± --- | 1 PLACE ± 0.2 ± --- | APPROVED BY DATE BMAGUIRE 2004/05/28 | | DOCUMENT NO. SD-90858-001 | | |
| DRAFT WHERE APPLICABLE MUST REMAIN WITHIN DIMENSIONS | | SEE CHART | | MATERIAL NO. | | SHEET NO. 4 OF 7 | | THIS DRAWING CONTAINS INFORMATION THAT IS PROPRIETARY TO MOLEX INCORPORATED AND SHOULD NOT BE USED WITHOUT WRITTEN PERMISSION | |

7 CIRCUIT

SEE CODE DESIGNATION TABLE FOR NUMBERING
FORMAT WHEN ADDING NEW PART NUMBERS

P.C.B.
POLARISATION
OPTION

Table with 8 columns: PART NO. (TIN), COLOUR, UNBLOCKED POSITION KEYS, UNBLOCKED CODING KEYS, LATCH POSITION, CONFIGURATION (SEE NOTES), REF, PART NO. (SILVER). Rows include part numbers like 90858-3511, 90858-3512, etc.

8 CIRCUIT

SEE CODE DESIGNATION TABLE FOR NUMBERING
FORMAT WHEN ADDING NEW PART NUMBERS

P.C.B.
POLARISATION
OPTION

Table with 8 columns: PART NO. (TIN), COLOUR, UNBLOCKED POSITION KEYS, UNBLOCKED CODING KEYS, LATCH POSITION, CONFIGURATION (SEE NOTES), REF, PART NO. (SILVER). Rows include part numbers like 90858-4252, 90858-4253, etc.

Technical drawing metadata including: SEE SHEET 1, DIMENSION STYLE MM ONLY, SCALE 1:1, DESIGN UNITS METRIC, THIRD ANGLE PROJECTION, RAST 5 VERT HDR, MOLEX INCORPORATED, SHEET NO. 5 OF 7.

9 CIRCUIT

| SEE CODE DESIGNATION TABLE FOR NUMBERING FORMAT WHEN ADDING NEW PART NUMBERS | | | | | | | P.C.B. POLARISATION OPTION | |
|---|---------|----------------------------------|--------------------------|------------------------|------------------------------|-----|----------------------------------|---|
| PART NO. (TIN) | COLOUR | UNBLOCKED POSITION KEYS | UNBLOCKED CODING KEYS | LATCH POSITION | CONFIGURATION (SEE NOTES) | REF | | |
| 90858-5002 | NATURAL | 1a 2a 2b 3a 3b 6a 7a 8b 9b | d20 03c d40 d50 d90 | 1/2 3/4 6/7 7/8 8/9 | | K30 | 90858-5997 | A |
| 90858-5003 | NATURAL | 1b 2a 3b 5a 6a 7b 8a 8b | 01c 03c d70 08c | 1/2 3/4 6/7 8/9 | | K31 | 90858-5996 | A |
| 90858-5004 | NATURAL | 1b 2a 3a 5a 6a 7b 8b | 01c 03c d70 08c d90 | 1/2 3/4 6/7 8/9 | | K32 | 90858-5995 | A |
| 90858-5005 | NATURAL | 1a 1b 3a 4b 5a 6b 7a | 01c d40 09c | 1/2 3/4 5/6 7/8 | | K37 | 90858-5994 | A |
| 90858-5006 | NATURAL | 1b 5a 8a 9a | 03c d40 d60 08c | 1/2 3/4 5/6 8/9 | | K38 | 90858-5993 | A |
| 90858-5007 | NATURAL | 2a 4b 5a 6b 7a 9a | d20 05c 07c | 1/2 3/4 5/6 7/8 | | K39 | 90858-5992 | A |
| 90858-5009 | NATURAL | 5b | d30 d70 | 1/2 6/7 | | K04 | 90858-5989 | A |
| 90858-5012 | NATURAL | 2b 3b 4a 5a 6b | d10 02c 04c 08c d90 | 2/3 4/5 6/7 8/9 | | K40 | 90858-5988 | A |
| 90858-5011 | NATURAL | 2b 5a | d80 | 2/3 7/8 | | K03 | 90858-5987 | A |
| 90858-5010 | NATURAL | 2b 3b 4b 6a | 01c d20 d40 05c d90 | 1/2 3/4 6/7 8/9 | | K49 | 90858-5986 | A |
| 90858-5013 | NATURAL | 1b 2a 4b 5a 8b 9b | 01c d20 d70 08c | 1/2 4/5 6/7 8/9 | | K58 | 90858-5985 | A |
| | | | | | | | | |
| | | | | | | | | |
| | | | | | | | | |
| | | | | | | | | |
| | | | | | | | | |

10 CIRCUIT

| SEE CODE DESIGNATION TABLE FOR NUMBERING FORMAT WHEN ADDING NEW PART NUMBERS | | | | | | | P.C.B. POLARISATION OPTION | |
|---|---------|--|-----------------------------------|-------------------------|------------------------------|-----|----------------------------------|---|
| PART NO. (TIN) | COLOUR | UNBLOCKED POSITION KEYS | UNBLOCKED CODING KEYS | LATCH POSITION | CONFIGURATION (SEE NOTES) | REF | | |
| 90858-6002 | NATURAL | 2a 3b 6a 9a | 03c d80 | 1/2 4/5 6/7 9/10 | | K30 | 90858-6997 | A |
| 90858-6003 | NATURAL | 1a 3b 7b 9b | 01c d20 d40 05c 07c | 1/2 3/4 5/6 7/8 9/10 | | K35 | 90858-6996 | A |
| 90858-6009 | NATURAL | 1b 2a 2b 4a 5b 6a 8a 9a 10a | d30 04c 06c 09c | 1/2 4/5 6/7 9/10 | | K41 | 90858-6988 | A |
| 90858-6010 | NATURAL | 1a 3b 4b 8a 10a 10b | 01c d50 06c 07c d80 09c | 1/2 4/5 7/8 9/10 | | K42 | 90858-6987 | A |
| 90858-6012 | NATURAL | 2a 4b 8a 10a | d20 05c d70 08c | 1/2 3/4 5/6 8/9 | | K44 | 90858-6986 | A |
| 90858-6015 | NATURAL | 1b 2a 3a 4b 5b 9a | 01c d40 d60 07c 09c d100 | 1/2 3/4 5/6 7/8 9/10 | | K48 | 90858-6983 | A |
| 90858-6016 | NATURAL | 1a 4b 6b 9a | 03c 04c d50 06c d70 08c d90 | 1/2 4/5 6/7 8/9 | | K36 | 90858-6982 | A |
| 90858-6021 | NATURAL | 1a 3b 7b 8a | 01c d20 d40 05c d100 | 1/2 3/4 5/6 7/8 9/10 | | K33 | 90858-6977 | A |
| 90858-6022 | NATURAL | 10a | d20 08c | 1/2 9/10 | | K56 | 90858-6976 | A |
| 90858-6023 | NATURAL | 1b 3b 5b 9a | 01c d60 07c 09c d100 | 1/2 3/4 5/6 7/8 9/10 | | K36 | 90858-6975 | A |
| 90858-6024 | NATURAL | 1b 2b 4a 7a 9a 9b | d20 d30 d50 06c d70 d80 | 1/2 4/5 6/7 9/10 | | K43 | 90858-6974 | A |
| 90858-6025 | NATURAL | 1a 2a 2b 3a 4a 4b 5a 6a 6b 7a 8a 8b 9a 10a 10b | NONE | 1/2 3/4 5/6 7/8 9/10 | | K45 | 90858-6973 | A |
| 90858-6026 | NATURAL | 2a 2b 3a 4a 5a 9a 10a | d20 d40 07c d70 08c d100 | 1/2 3/4 5/6 8/9 | | K46 | 90858-6972 | A |
| 90858-6027 | NATURAL | 1b 2a 3a 4b 6a 7a 8a 8b | 01c d40 d60 d80 | 1/2 3/4 5/6 9/10 | | K49 | 90858-6971 | A |
| 90858-6028 | NATURAL | 1b 5a 8b 9a 10b | 03c d40 d80 09c | 1/2 3/4 5/6 7/8 9/10 | | K50 | 90858-6970 | A |
| 90858-6029 | NATURAL | 1b 3a 4a 4b 6b 9a 9b | 01c d50 06c d70 09c | 1/2 4/5 6/7 9/10 | | K51 | 90858-6969 | A |
| 90858-6030 | NATURAL | 1b 4a 7a 9a | 01c d20 06c d80 09c | 1/2 4/5 7/8 9/10 | | K52 | 90858-6968 | A |

| | | | | | | | | |
|---|--|-------------------------------|---|----------------------------|--------------------|------------------------------|------------------------|--|
| SEE SHEET 1 EC NO: E2010-0370 DRWN: BRUTTE CHKD: JENNEHY APPR: BMAGUIRE | 2010/05/13 2004/05/27 2010/06/08 | QUALITY SYMBOLS ∇=0 ∇=0 | GENERAL TOLERANCES (UNLESS SPECIFIED) mm INCH 4 PLACES ± --- ± --- 3 PLACES ± --- ± --- 2 PLACES ± 0.1 ± --- 1 PLACE ± 0.2 ± --- ANGULAR ± 2 ° | DIMENSION STYLE MM ONLY | SCALE 1:1 | DESIGN UNITS METRIC | THIRD ANGLE PROJECTION | |
| | DRAWN BY NMCNAMAR | DATE 2004/05/26 | TITLE RAST 5 VERT HDR | | MOLEX INCORPORATED | | | |
| | CHECKED BY JDENNEHY | DATE 2004/05/27 | DRAFT WHERE APPLICABLE MUST REMAIN WITHIN DIMENSIONS | | SEE CHART | DOCUMENT NO. SD-90858-001 | SHEET NO. 6 OF 7 | |
| | APPROVED BY BMAGUIRE | DATE 2004/05/28 | THIS DRAWING CONTAINS INFORMATION THAT IS PROPRIETARY TO MOLEX INCORPORATED AND SHOULD NOT BE USED WITHOUT WRITTEN PERMISSION | | | | | |

| 11 CIRCUIT | | | | | | | | SEE CODE DESIGNATION TABLE FOR NUMBERING FORMAT WHEN ADDING NEW PART NUMBERS | | | | P.C.B. POLARISATION OPTION | | |
|-------------------|---------|--|--|------------------------------|------------------------------|-----|----------------------|---|--------------------------|-------------------|------------------------------|----------------------------------|-----|----------------------|
| PART NO. (TIN) | COLOUR | UNBLOCKED POSITION KEYS | UNBLOCKED CODING KEYS | LATCH POSITION | CONFIGURATION (SEE NOTES) | REF | PART NO. (SILVER) | UNBLOCKED POSITION KEYS | UNBLOCKED CODING KEYS | LATCH POSITION | CONFIGURATION (SEE NOTES) | | REF | PART NO. (SILVER) |
| 90858-7001 | NATURAL | 1a 2b 3c 4a 4b 5a 7a 8a 9a 10a 11a | 01c d40 05c 08c 010c | 3/4 8/9 | | K33 | 90858-7998 | | | | | | | A |
| 90858-7002 | NATURAL | 1a 1b 6b 7a 10a 11b | 03c d40 d90 | 1/2 3/4 5/6 7/8 8/9 10/11 | | K30 | 90858-7997 | | | | | | | A |
| 90858-7003 | NATURAL | 1a 2b 3c 4a 4b 5a 7a 8a 9a 10a 11a | 01c d40 05c 08c 010c | 1/2 3/4 5/6 8/9 10/11 | | K31 | 90858-7996 | | | | | | | A |
| 90858-7004 | NATURAL | 2a 3b 4a 4b 5a 6b 7a 10a 11b | 01c d20 d40 d60 07c d90 010c | 1/2 3/4 5/6 7/8 10/11 | | K32 | 90858-7995 | | | | | | | A |
| 90858-7005 | NATURAL | 2a 3b 4a 4b 6a 6b 8b 10a 11b | 01c d20 d40 d60 07c d90 010c | 1/2 3/4 6/7 8/9 10/11 | | K34 | 90858-7994 | | | | | | | A |
| 90858-7007 | NATURAL | 2a 4b 5b 7b 8a 11b | d10 d30 d50 d80 010c d110 | 2/3 4/5 7/8 10/11 | | K36 | 90858-7992 | | | | | | | A |
| 90858-7008 | NATURAL | 1b 3a 4b 6a 7b 9b | 01c d20 d40 d60 07c d90 d80 09c d100 | 1/2 3/4 5/6 7/8 9/10 | | K37 | 90858-7991 | | | | | | | A |
| 90858-7009 | NATURAL | 2a 6a 8a 11b | 01c d50 d90 d110 | 2/3 4/5 6/7 8/9 10/11 | | K38 | 90858-7990 | | | | | | | A |
| 90858-7010 | NATURAL | 1a 4a 6a 8a 11b | d30 d90 d110 | 1/2 4/5 6/7 8/9 10/11 | | K39 | 90858-7989 | | | | | | | A |
| 90858-7014 | NATURAL | 1a 1b 2b 4a 5a 8b 9b | 02c d80 09c d100 | 2/3 5/6 7/8 9/10 | | K46 | 90858-7985 | | | | | | | A |
| 90858-7015 | NATURAL | 1b 5b 6b 8b 9b 10a 10b | 01c d20 d40 05c d70 08c 010c | 1/2 5/6 8/9 10/11 | | K47 | 90858-7984 | | | | | | | A |
| 90858-7016 | NATURAL | 1a 2b 3b 5a 6b 8a 9b | d20 03c 06c 09c d100 | 1/2 3/4 6/7 9/10 | | K44 | 90858-7983 | | | | | | | A |
| 90858-7017 | NATURAL | 1b 4a 7b 9b 10b | 01c d20 04c d80 09c 011c d110 | 1/2 4/5 6/7 9/10 | | K45 | 90858-7982 | | | | | | | A |
| 90858-7013 | NATURAL | 1b 11b | 03c d90 | 3/4 8/9 | | K43 | 90858-7986 | | | | | | | A |
| 90858-7018 | NATURAL | 1b 2a 3a 4b 6b | 01c d40 d60 011c | 1/2 3/4 5/6 7/8 9/10 | | K35 | 90858-7981 | | | | | | | A |
| 90858-7019 | NATURAL | 1b 3a 4b 7a 10b | 01c 04c d50 07c | 1/2 4/5 7/8 9/10 | | K40 | 90858-7980 | | | | | | | A |
| 90858-7020 | NATURAL | 1b 2a 3a 4b 6b 7a 8a 8b | 01c d40 d60 d80 011c | 1/2 3/4 5/6 9/10 | | K42 | 90858-7979 | | | | | | | A |

| 12 CIRCUIT | | | | | | | | SEE CODE DESIGNATION TABLE FOR NUMBERING FORMAT WHEN ADDING NEW PART NUMBERS | | | | P.C.B. POLARISATION OPTION | | |
|-------------------|---------|---|-------------------------------------|-------------------------------|------------------------------|-----|----------------------|---|--------------------------|-------------------|------------------------------|----------------------------------|-----|----------------------|
| PART NO. (TIN) | COLOUR | UNBLOCKED POSITION KEYS | UNBLOCKED CODING KEYS | LATCH POSITION | CONFIGURATION (SEE NOTES) | REF | PART NO. (SILVER) | UNBLOCKED POSITION KEYS | UNBLOCKED CODING KEYS | LATCH POSITION | CONFIGURATION (SEE NOTES) | | REF | PART NO. (SILVER) |
| 90858-8002 | NATURAL | 1b 7a 8b 12b | d10 06c 09c d100 d120 | 2/3 4/5 7/8 11/12 | | K30 | 90858-8997 | | | | | | | A |
| 90858-8003 | NATURAL | 2a 4b 5b 6b 7a 10b 12a 12b | d10 d30 d50 d70 09c d100 d120 | 2/3 4/5 6/7 9/10 11/12 | | K34 | 90858-8996 | | | | | | | A |
| 90858-8004 | NATURAL | 1a 3b 7b 9b 11b 12a | 01c d20 d40 05c 07c 011c | 1/2 3/4 5/6 7/8 9/10 11/12 | | K44 | 90858-8995 | | | | | | | A |
| 90858-8005 | NATURAL | 1b 2a 2b 4a 5b 6a 8a 9a 10a 11a 12b | d30 04c 06c 09c 011c | 1/2 4/5 6/7 9/10 11/12 | | K46 | 90858-8994 | | | | | | | A |
| 90858-8007 | NATURAL | 2b 3b 4a 8b 9b 11a | 01c d20 d40 d90 d100 d120 | 1/2 3/4 8/9 11/12 | | K49 | 90858-8992 | | | | | | | A |
| 90858-8008 | NATURAL | 1a 2b 3a 5b 11b 12a | 01c 03c d40 d60 07c 09c | 1/2 3/4 5/6 7/8 9/10 11/12 | | K47 | 90858-8991 | | | | | | | A |
| 90858-8009 | NATURAL | 1a 5b 7b | 01c d30 04c d70 012c | 2/3 4/5 6/7 8/9 10/11 | | K50 | 90858-8990 | | | | | | | A |
| | | | | | | | | | | | | | | |
| | | | | | | | | | | | | | | |
| | | | | | | | | | | | | | | |
| | | | | | | | | | | | | | | |
| | | | | | | | | | | | | | | |
| | | | | | | | | | | | | | | |
| | | | | | | | | | | | | | | |
| | | | | | | | | | | | | | | |
| | | | | | | | | | | | | | | |
| | | | | | | | | | | | | | | |

| <p>SEE SHEET 1</p> <p>EC NO: E2010-0370</p> <p>DRWN:BRUTLE</p> <p>CHKD:JENNEY</p> <p>APPR:BMAGUIRE</p> <p>2010/05/13</p> <p>2004/05/27</p> <p>2010/06/08</p> | <p>QUALITY SYMBOLS</p> <p>▽=0</p> <p>▽=0</p> | <p>GENERAL TOLERANCES (UNLESS SPECIFIED)</p> <table border="1"> <tr> <th></th> <th>mm</th> <th>INCH</th> </tr> <tr> <td>4 PLACES ±</td> <td>---</td> <td>---</td> </tr> <tr> <td>3 PLACES ±</td> <td>---</td> <td>---</td> </tr> <tr> <td>2 PLACES ±</td> <td>0.1</td> <td>---</td> </tr> <tr> <td>1 PLACE ±</td> <td>0.2</td> <td>---</td> </tr> </table> <p>ANGULAR ± 2 °</p> | | mm | INCH | 4 PLACES ± | --- | --- | 3 PLACES ± | --- | --- | 2 PLACES ± | 0.1 | --- | 1 PLACE ± | 0.2 | --- | <p>DIMENSION STYLE</p> <p>MM ONLY</p> | <p>SCALE</p> <p>1:1</p> | <p>DESIGN UNITS</p> <p>METRIC</p> | <p>THIRD ANGLE PROJECTION</p> |
|--|--|---|---------------------------|--------------------------------|------|------------|-----|-----|------------|-----|-----|------------|-----|-----|-----------|-----|-----|--|-------------------------|-----------------------------------|-------------------------------|
| | | mm | INCH | | | | | | | | | | | | | | | | | | |
| | 4 PLACES ± | --- | --- | | | | | | | | | | | | | | | | | | |
| | 3 PLACES ± | --- | --- | | | | | | | | | | | | | | | | | | |
| 2 PLACES ± | 0.1 | --- | | | | | | | | | | | | | | | | | | | |
| 1 PLACE ± | 0.2 | --- | | | | | | | | | | | | | | | | | | | |
| <p>DRAWN BY</p> <p>DATE</p> <p>CHECKED BY</p> <p>DATE</p> <p>APPROVED BY</p> <p>DATE</p> | <p>MATERIAL NO.</p> <p>DOCUMENT NO.</p> | <p>RAST 5 VERT HDR</p> | <p>MOLEX INCORPORATED</p> | <p>SHEET NO.</p> <p>7 OF 7</p> | | | | | | | | | | | | | | | | | |
| <p>DRAFT WHERE APPLICABLE MUST REMAIN WITHIN DIMENSIONS</p> | <p>SEE CHART</p> | <p>THIS DRAWING CONTAINS INFORMATION THAT IS PROPRIETARY TO MOLEX INCORPORATED AND SHOULD NOT BE USED WITHOUT WRITTEN PERMISSION</p> | | | | | | | | | | | | | | | | | | | |