

- 备注:
1. 外壳镗雕A3;
 2. 拧螺母，配垫圈。

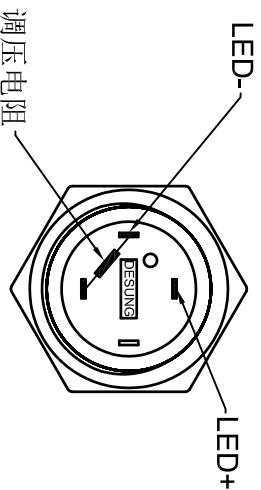

Nut Torque:5~14Nm
 Protection Grade:IP65,IK08
 Shell:Brass,Ni Plating
 Base:PBT+15%GF
 Lamp Type:LED
 Forward current : 20mA Max
 Lamp Life:50000H
 Beads Color:Red
 Lamp voltage:220V AC
 Operating Temperature:-20°C~80°C
 Relative Air Humidity:45%~85%
 Safety Approval:

CUT-OUT

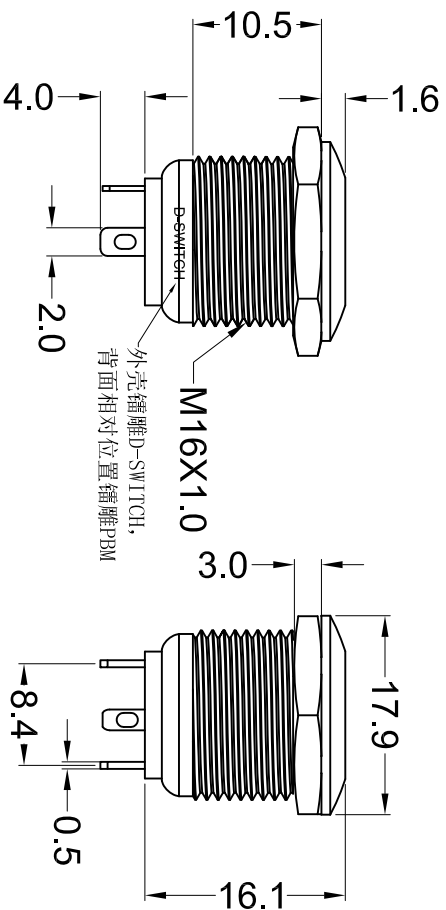
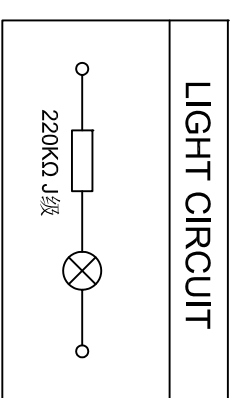
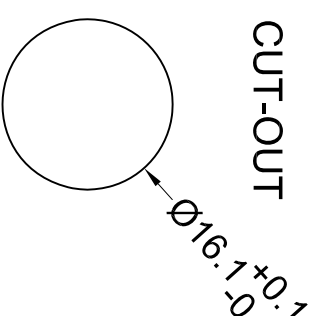

D·SWITCH
 东莞市德禄电子有限公司
 D-SWITCH ELECTRONICS CO.,LTD

公差 TOLERANCES: .X±0.5 .XX±0.3 角度 ANGLE ±1° 单位 DIMENSION UNIT mm.

版本 VER	变更说明 CHANGE DESCRIPTION	日期 DATE	ECON NO.	核准	核对	绘图	品名	TITLE	图号	DRAWING NO
				版本 VERSION	比例尺 SCALE	日期 DATE	日期 DATE			
				A0	1:1	2022.03.10	2022.03.10			
				APPROVED BY	CHECKED BY	DRAWN BY	PBM-16111-FS-R1-A220-B8S-A3-0004		1030429	