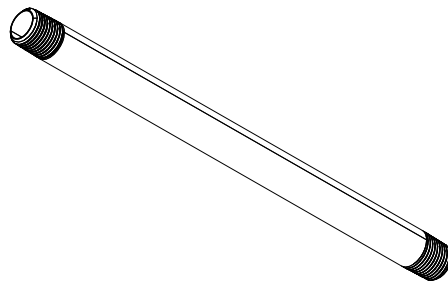
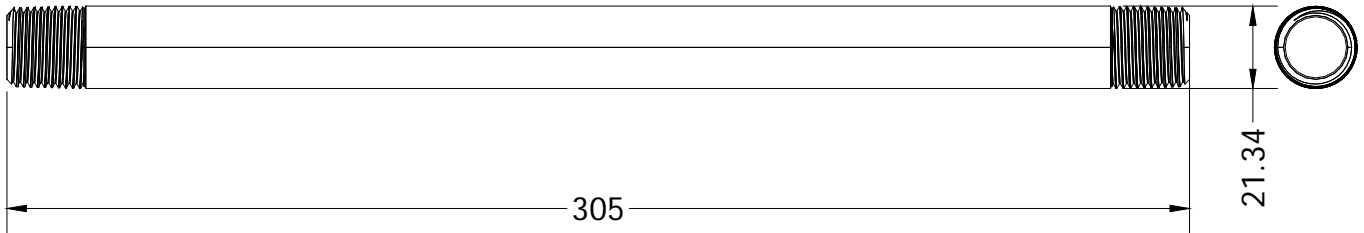

**Threaded Pipe Black Electroplated**

Dimensions: mm

**Assembly Procedure**

Thread one side into base of unit and the other side into the J-MOUNTINGBRACKET.

Material: Black Electroplated Stainless Steel SUS304

UL50, C22.2 No.94, NEMA Type 3R, 4X, & 12, and IP66 approved, RoHS compliant, Gasket.