

PCB LAYOUT

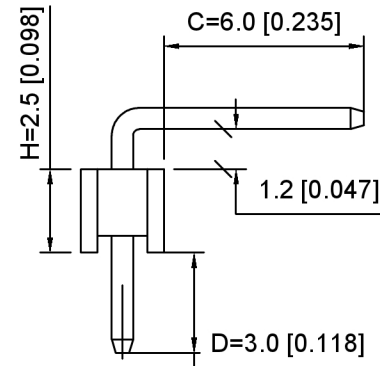

R1 TYPE

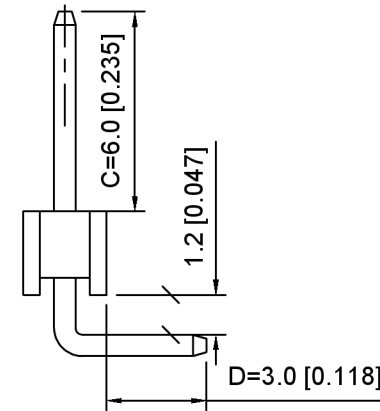

R2 TYPE

Specifications:  
 规格:  
 Voltage rating: 250V AC/DC  
 额定电压: 250V AC/DC  
 Current rating: 3A AC/DC  
 额定电流: 3A AC/DC  
 Withstanding voltage: 1000V AC/minute  
 耐受电压: 1000V AC/分钟  
 Temperature range: -40°C ~ +105°C  
 温度范围: -40°C ~ +105°C  
 Insulation resistance: ≥1000MΩ  
 绝缘电阻: ≥1000MΩ  
 Contact resistance: ≤20mΩ  
 接触电阻: ≤20mΩ  
 Material: PA6T UL94V-0  
 材质: PA6T UL94V-0  
 Plating Category: 1U"Gold  
 镀层: 1U"Gold  
 Wave soldering temperature: 255±5°C, 10S  
 波峰焊温度: 255±5°C, 10S

X6511 W R -XX H - C60 D30 X  
 ① ② ③ ④ ⑤ ⑥ ⑦ ⑧

1. Series No
2. Category: W-Wafer
3. Welding Board Angle: R-Straight 90°
4. Row No. Pin No: XX-02~40P
5. Plastic Height: H=2.5mm
6. Pin Length: C=6.0mm
7. Pin Length: D=3.0mm
8. Type: X-R1 ; R2

X6511WR-XXH-C60D30X	PA6T	Brass	X6511F
PART NO	Material	Material(Pin)	Suitable XKB Female

DSND	SCALE: N/A	MODEL TYPE: 2.54mm BTB Connector
DWN	VIEW:	PART NO.: X6511WR-XXH-C60D30X
CHKD	UNIT: mm/in	DWG NO.: X-X6511WR-XXH-C60D30X
APPD	SIZE: A4	WEIGHT SHEET REVISION 1/1 A0



XKB INDUSTRIAL PRECISION CO., LIMITED

广东星坤科技股份有限公司

ΔX	日期
ΔX	日期
ΔX	日期

MARK	DESCRIPTION	DATE	REVISED	APPROVED
------	-------------	------	---------	----------

REVISIONS

UNSPECIFIED TOLERANCES

文件工程章