

Rev	AWO #	Description	Date	Appr
-		RELEASED	6/8/05	
A		REDRAWN	4/5/12	
B		REVISED DIM.	12/26/12	

APPROVED: _____
 DATE: _____ TITLE: _____

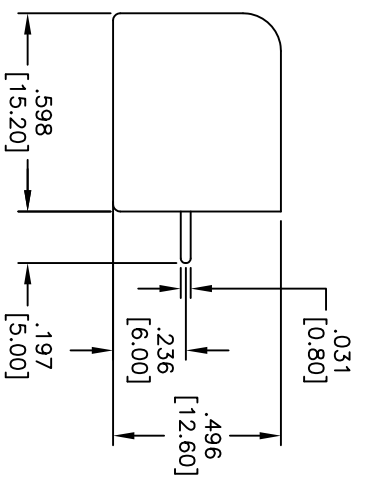
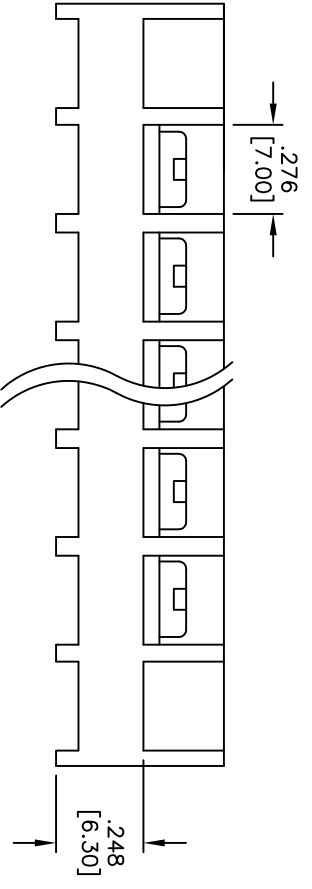
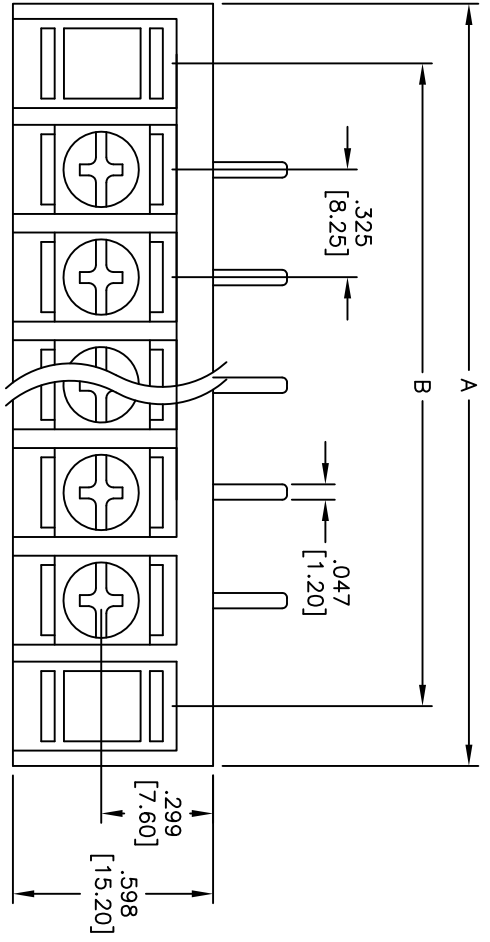

SPECIFICATIONS:
 Material: Insulator: Nylon 66, rated UL 94V-0
 Insulator color: Black
 Contact: Brass, Tin plated
 Screw: Brass, M3, Nickel plated
 Electrical:
 Operating voltage: 300 VAC max.
 Current rating: 15 Amps max.
 Insulation resistance: 1000 Mohms min.
 Dielectric withstanding voltage: 2000 VAC for 1 minut
 Mechanical:
 Screw Torque Value: 10 Kg-cm
 Wire range: 14 - 22 AWG
 Temperature Rating: Operating temperature: -40°C to +120°C
 Environmental: Lead free, RoHS compliant

Positions: 2 thru 32
 A = .325 [8.25] x No. of Spaces + (.404±.031 [10.25±0.80])
 B = .325 [8.25] x No. of Spaces

UNLESS OTHERWISE SPECIFIED ALL DIMENSIONS ARE INCHES [MM]	
TOLERANCES: EXCEPT AS NOTED	
INCHES	HOLDS
.X ± .10	Ø.X ± .10
.XX ± .020	Ø.XXX ± .015
.XXX ± .015	Ø.XXX ± .010
APPROVALS	DATE
DRAWN	SS
CHECKED	
APPROVED	

ADAM TECH
 909 Railway Avenue, Union, NJ 07083
 Phone: 908-687-5000 Fax: 908-687-5710

TITLE: .325 [8.25] TERMINAL BLOCK, CLOSED SIDE
 EXIT PCB TAILS, MOUNT ENDS

SIZE: X PART NO.: TBE-XX-02-M
 REF: S0003TT SCALE: NTS SHEET 1 OF 1

