

备注:

1. 外壳镗雕A3;
2. 拧螺母, 配垫圈。

Nut Torque:5~14Nm
 Operating Pressure:500gf ±200gf
 Operating Stroke:2.8mm±0.5
 Protection Grade:IP68 IK08
 Function:(ON)-OFF
 Contact:Silver Alloy
 Base:PA66
 Shell:SUS
 Button:Rubber,Gray
 Rating(Resistive load):3A 250V AC
 Contact Resistance:50mΩ Max.
 Insulation Resistance:100MΩ Min.
 Dielectric Strength:1500VAC 1 minute
 Electrical life:50,000 cycles
 Mechanical life:100,000 cycles
 Operating Temperature:-20°C~80°C
 Relative Air Humidity:45%~85%
 Safety Approval:

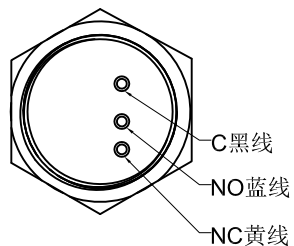
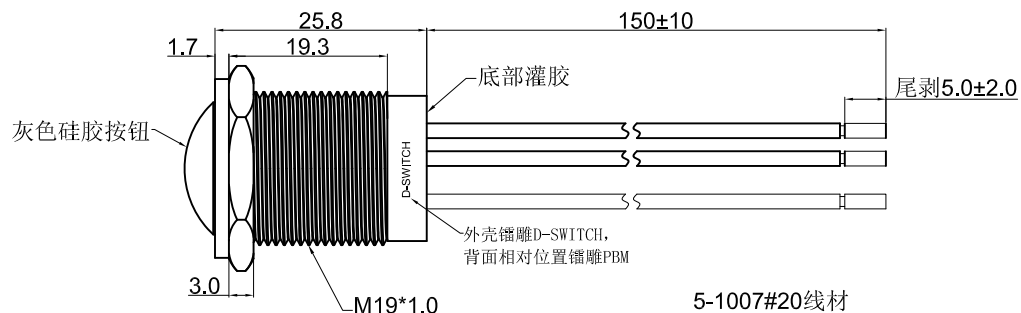

CUT-OUT

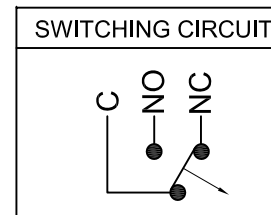
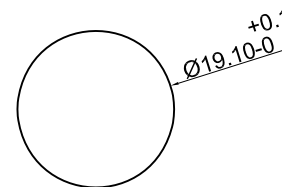

				 D-SWITCH 东莞市德崧电子有限公司 D-SWITCH ELECTRONICS CO.,LTD					
		公差 TOLERANCES		.X± 0.5	.XX± 0.3	角度 ANGLE ±1°		单位	
		版本 VERSION	A0	比例尺 SCALE	1:1	日期 DATE	2022.03.04	品名 TITLE	图号 DRAWING NO
		核准 APPROVED BY		核对 CHECKED BY		绘图 DRAWN BY	孙成	PBM-19M13-BA-N-NN-S7W-A3-0004 (L-150-1007#20-BUY)	1013274
版本 VER	变更说明 CHANGE DESCRIPTION	日期 DATE	ECN NO.	APPROVED BY	CHECKED BY	DRAWN BY	孙成		