

UNAUTHORIZED USE OF THIS  
DRAWING IS STRICTLY PROHIBITED

DAR	REV	DESCRIPTION	APPVD	DATE
1053	A	INITIAL RELEASE	TJD	1-06
1106	B	ADD COVER MATERIAL	TJD	5-06
1317	C	CHANGE TEMPERATURE TO 150 DEGREES	TP	7-07
1497	D	CHANGE FLANGE, LD HEIGHT & HEIGHT DIMS	DG	8-08
3545	E	SEE DAR	DG	3-12
5103	F	SEE DAR	DG	8-14

ELECTRICAL SPECIFICATIONS

PART NO.	VALUE	INPUT POWER	FREQUENCY	VSWR
IPP-TB201R-50	50 OHMS ±5%	30 WATT	DC-6.0 GHz	<1.13:1 DC-3.0 GHz <1.20:1 DC-4.0 GHz <1.50:1 DC-6.0 GHz
IPP-TB201R-100	100 OHMS ±5%	30 WATT	DC-4.0 GHz	2±0.2:1

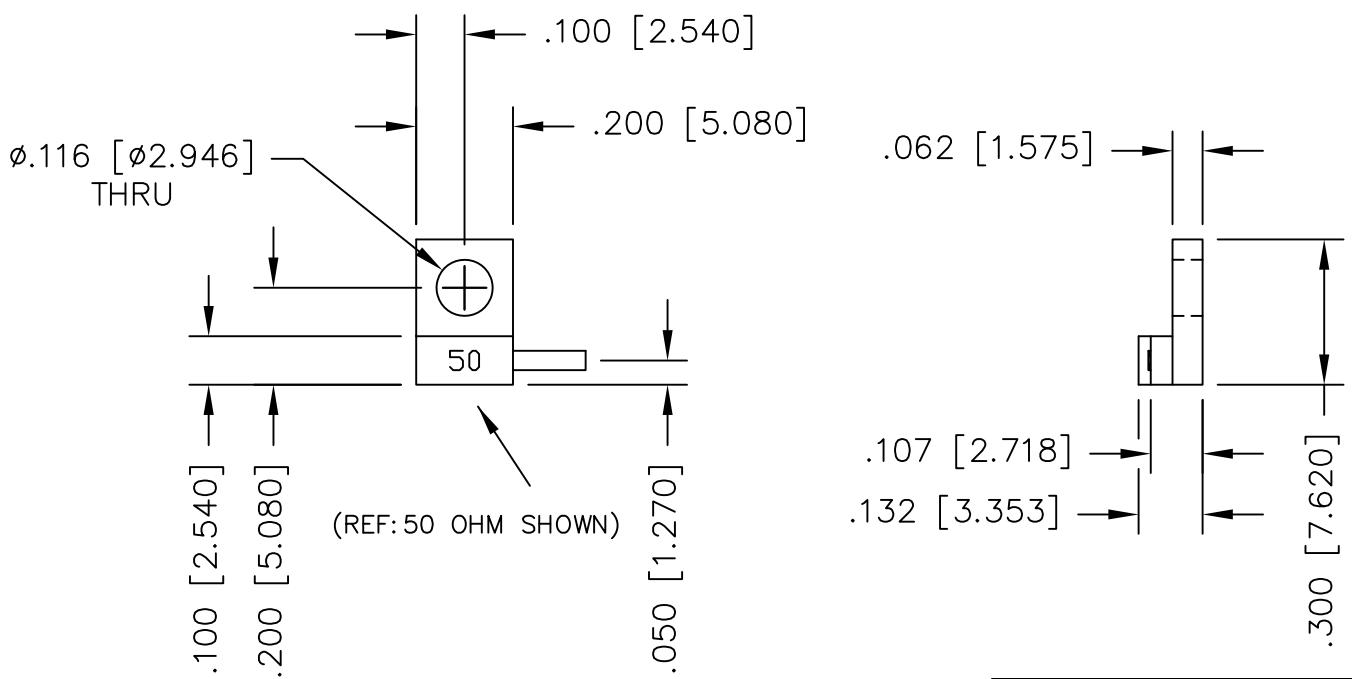

NOTES

- LEAD MATERIAL:  
99.99% PURE SILVER,  
.040 WIDE x .005 THICK
- LEAD LENGTH: .150 MIN.
- SUBSTRATE MATERIAL: BeO  
COVER MATERIAL: Al<sub>2</sub>O<sub>3</sub>
- FLANGE MATERIAL: COPPER  
PLATING: NICKEL
- DIMENSIONS: INCHES, [mm]
- RoHS COMPLIANT.

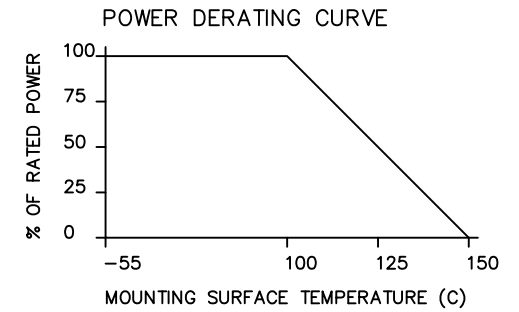

MATERIAL	<b>3</b> <b>4</b>	DWN DG	DATE 1/06	<b>Innovative Power Products</b>
FINISH	<b>4</b>	ENG TJD	DATE 1/06	
TOLERANCE	.xx ±.02 [.51] IN [MM] .xxx ±.010 [.254]	MANUF TP	DATE 1/06	TITLE
		CAGE CODE: 437R2		TERMINATION, 30 WATT, HALF FLANGE
		SHEET 1 OF 1	SCALE 4:1	SIZE B
				P/N IPP-TB201R-XXX
				REV. F