

备注:  
1. 外壳镗雕A3;  
2. 拧螺母, 配垫圈。

Nut Torque:5~14Nm  
Operating Pressure:500gf ±200gf  
Operating Stroke:2.8mm±0.5  
Protection Grade:IP68 IK08  
Function:(ON)-OFF  
Contact:Silver Alloy  
Base:PA66  
Shell:SUS  
Button:Rubber,Red  
Lamp Type:LED  
Lamp Life:50000H  
Forward current:20mA Max.  
Rating(Resistive load):3A 250V AC  
Contact Resistance:50mΩ Max.  
Insulation Resistance:100MΩ Min.  
Dielectric Strength:1500VAC 1 minute  
Electrical life:50,000 cycles  
Mechanical life:100,000 cycles  
Operating Temperature:-20°C~80°C  
Relative Air Humidity:45%~85%  
Safety Approval:

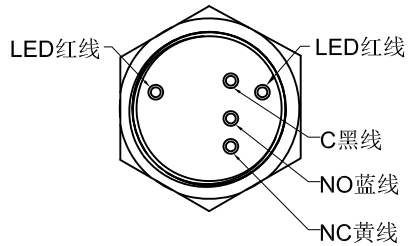

CUT-OUT

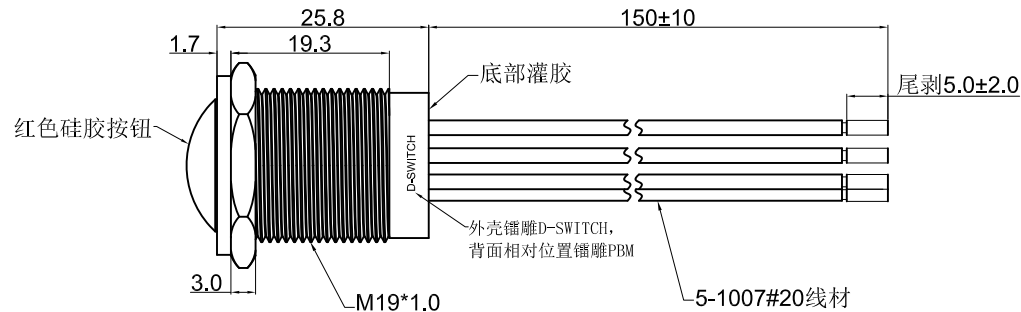
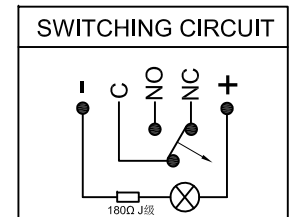
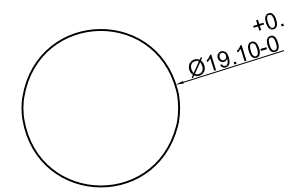

				<b>D-SWITCH</b> 东莞市德裕电子有限公司 D-SWITCH ELECTRONICS CO.,LTD			
		公差 TOLEANCES	.X± 0.5	.XX± 0.3	角度 ANGLE ±1°	单位	
版本 VERSION	A0	比例尺 SCALE	1:1	日期 DATE	2022.03.09	品名 TITLE	图号 DRAWING NO
版本 VER	变更说明 CHANGE DESCRIPTION	日期 DATE	ECN NO.	核准 APPROVED BY	核对 CHECKED BY	绘图 DRAWN BY 孙成	PBM-19M15-BR-R1-A6-S7W-A3-0004 (L-150-1007#20-RRBUY) 1013273