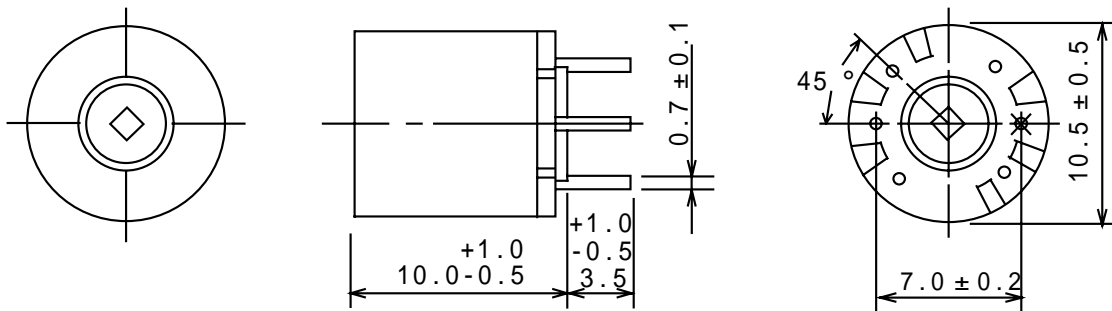

Type: MC-108
Product Description

- 11.0mm Max., 11.0mm Max. Height.
- Inductance: 18mH Max.
- Operating frequency: 400kHz Max.
- In addition to the standard versions of parameters shown here, custom designs are available to meet your exact requirements.

Feature

- High inductance variable shielded type of low leakage flux.
- Can be used as DC-DC converter transformer.
- RoHS Compliance.

Dimensions (mm)

* Dimension does not include solder used on coil.

* Pin pitch should be measured at the root of terminal.

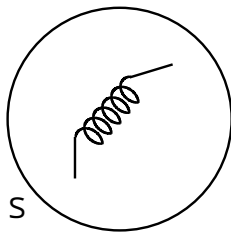
Connection (Bottom View)

“ S ” is winding start.

Type: MC-108
Specification

No.	Part No.	Stamp	Inductance [Variable] at 1kHz	Unloaded Q [Min.] at 50kHz	D.C.R.(Ω) [Ref.] (at = 20)	Rated current (m A) [Ref.] 1
01	MC1Ø8NP-1Ø2	102	1.0mH±8%	40	4.4	149
02	MC1Ø8NP-122	122	1.2mH±8%	40	5.1	130
03	MC1Ø8NP-152	152	1.5mH±8%	40	7.5	110
04	MC1Ø8NP-182	182	1.8mH±8%	40	8.3	92
05	MC1Ø8NP-222	222	2.2mH±8%	30	12.7	80
06	MC1Ø8NP-272	272	2.7mH±8%	35	14.2	70
07	MC1Ø8NP-332	332	3.3mH±8%	30	18.2	61
08	MC1Ø8NP-392	392	3.9mH±8%	35	20.5	55
09	MC1Ø8NP-472	472	4.7mH±8%	30	27.5	48
10	MC1Ø8NP-562	562	5.6mH±8%	35	31.6	43
11	MC1Ø8NP-682	682	6.8mH±8%	35	34.3	38
12	MC1Ø8NP-822	822	8.2mH±8%	30	48.9	34
13	MC1Ø8NP-1Ø3	103	10mH±8%	35	52.7	31
14	MC1Ø8NP-123	123	12mH±8%	35	59.5	28
15	MC1Ø8NP-153	153	15mH±8%	30	88.8	26
16	MC1Ø8NP-183	183	18mH±8%	30	106.0	24

1 Rated current: The D.C. current at which the inductance decreases to 95% of it's initial value or when $t=40$, whichever is lower($T_a=20$).