

Rev	AWG #	Description	Date	Appr
-		RELEASED	4/7/05	

APPROVED: \_\_\_\_\_  
 DATE: \_\_\_\_\_ TITLE: \_\_\_\_\_

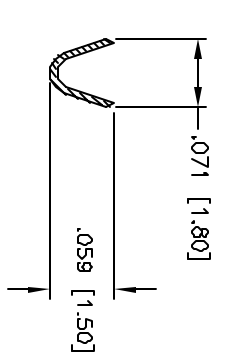
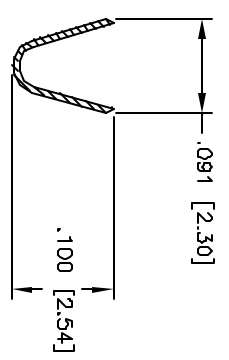
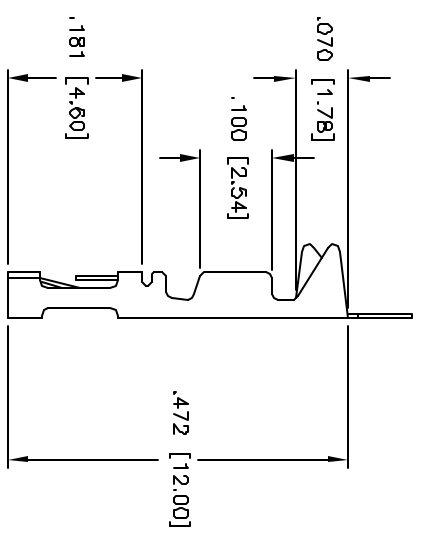
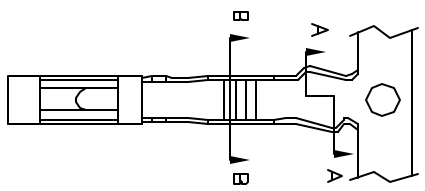

SECTION B-B

SECTION A-A

**SPECIFICATIONS:**

**Material:**  
 Contact: Phosphor Bronze  
 Plating:  
 Gold flash over Nickel underplate,  
 Tin over Copper underplate on crimp area  
**Electrical:**  
 Operating voltage: 250 VAC max  
 Wire range: 22-28 AWG  
 Current rating: 3 Amps max  
 Contact resistance: 20 mohms max  
 Temperature Rating:  
 Operating temperature: -65°C to +105°C  
**Packaging:**  
 R = 6,000 piece reel  
 B = 1,000 pieces loose cut  
 Environmental:  
 Lead free, RoHS compliant



UNLESS OTHERWISE SPECIFIED ALL DIMENSIONS ARE INCHES [MM] TOLERANCES: EXCEPT AS NOTED	
INCHES	HILES
.XX ± .010	ØXX ± .010
.XX ± .020	ØXXX ± .010
.XXX ± .015	ØXXX ± .010
APPROVALS	DATE
DRAWN SS	4/7/05
CHECKED	
APPROVED	

**ADAM TECH**  
 909 Rahway Avenue, Union, NJ 07083  
 Phone: 908-687-5000 Fax: 908-687-5710

TITLE		SIZE	PART NO.	SCALE	SHEET	OF
CRIMP CONTACT		X	MTEC-X	NIB	1	1
REV.						