

linear dimension (Tolerances Standard GB/T 14486-2008)										—		□		L					
variable range	6 to 6	over 10 to 10	over 30 to 30	over 60 to 60	over 100 to 100	over 160 to 160	over 10 to 10	over 100 to 100	tolerance	±0.20	±0.30	±0.50	±0.70	±1.00	±1.30	±1.60	0.10	0.30	0.60

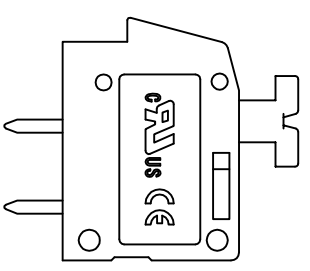
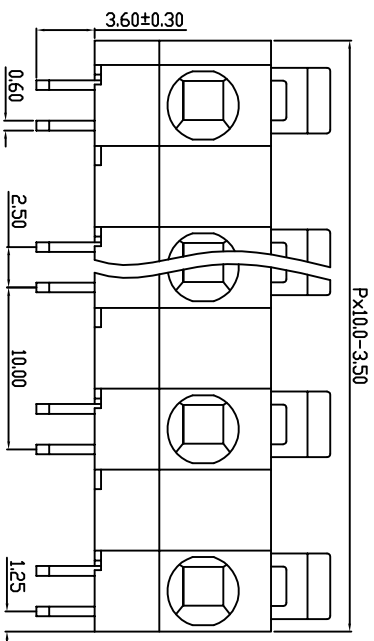
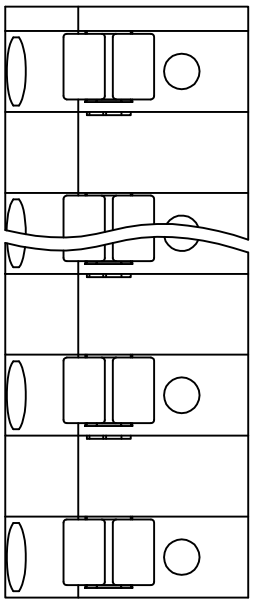
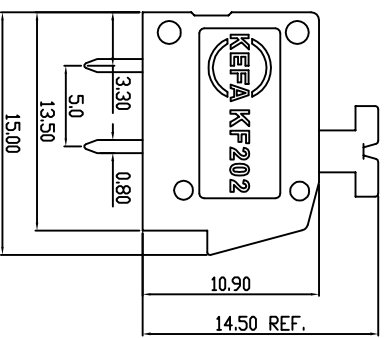
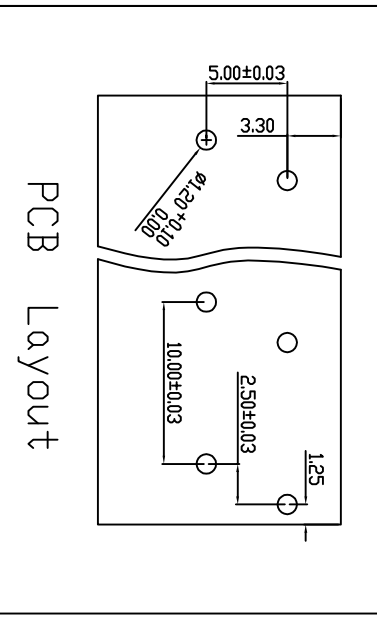

REVISION RECORD			
REV.	DESCRIPTION	ECN No.	APPROVED DATE

UL/CUL 技术参数			
UL/CUL Technical Data			
等级	Use Group	B	C D
额定电压	Rated Voltage	300	300
额定电流	Rated Current	12	10
接线范围	Wire Range	24-12	
单/多芯线	Solid/Stranded	AWG	
耐电压	Withstanding Voltage	1600V/1Min	

IEC 技术参数			
IEC Technical Data			
过电压类别	Overvoltage Category	III	III II
污染等级	Contamination Class	3	2 2
额定电压	Rated Voltage	320	320 630
额定电流	Rated Current	16	16 16
额定冲击电压	Rated impulse voltage	4	4 4
导线截面积	Conductor cross section	25	
硬质/柔性导线	Solid/flexible	[mm ²]	

材料	Material	PA66
绝缘材料	Insulation Material	PA66
阻燃等级	Inflammability	UL94V-0
导体材料	Contact Material	铜合金 Copper alloy
导体表面镀层	Contactive Coating	镀锡 Tin Plated
一般参数 Other Data		
间距 Pitch	[mm]	10.0
极数 Poles	[P]	02-XX
剥线长度 Stripping Length	[mm]	11
螺丝 Screw/扭矩 Torque(Max)	[Nm]	-
工作温度 Operating temperatur	[°C]	-40~105
引脚尺寸 Pin Dimensions	[mm]	3.6
PCB板孔径 PCB Hole Diameter	[mm]	1.2

DES.	DATE	单位 / UNITS	mm	尺寸 / SIZE	A4	比例 / SCALE	1:1	第三视图/THIRD ANGLE PROJECTION	版本 / REV	A
CHK.	DATE	APP.	DATE	慈溪市科发电子有限公司 CXI KEFA ELECTRONIC CO., LTD						
名称 / TITLE								KF202-10.0		