

- 备注:
1. 外壳镗雕灯颜色和电压; 镗雕A3;
 2. 拧螺母, 配垫圈。

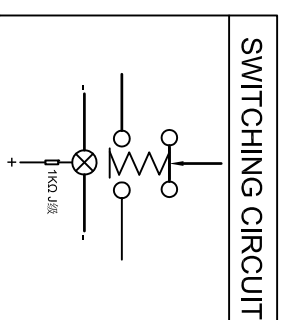

Nut Torque: 5 ~ 14Nm
 Operating Pressure: 400gf ± 100gf
 Operating Stroke: 2.0mm ± 0.3
 Protection Grade: IP65, IK08
 Function: (ON)-OFF
 Contact: Silver Alloy
 Base: PBT
 Shell: Brass, Ni Plating
 Button: SUS
 Terminal: Brass, silver
 Lamp Type: LED
 Lamp Life: 50000H
 Rating (Resistive load): 5A 250V AC
 Contact Resistance: 50mΩ MAX.
 Insulation Resistance: 100MΩ MIN.
 Dielectric Strength: 1500V AC 1 minute
 Electrical life: 50,000 cycles
 Mechanical life: 100,000 cycles
 Operating Temperature: -20°C ~ 80°C
 Relative Air Humidity: 45% ~ 85%
 Safety Approval:

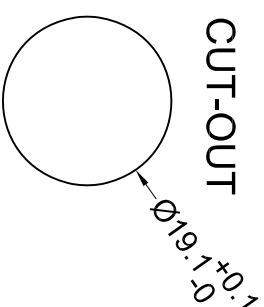
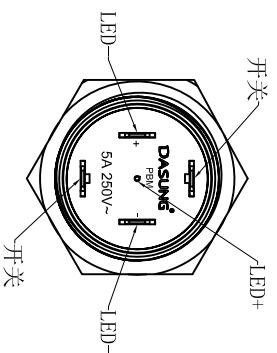
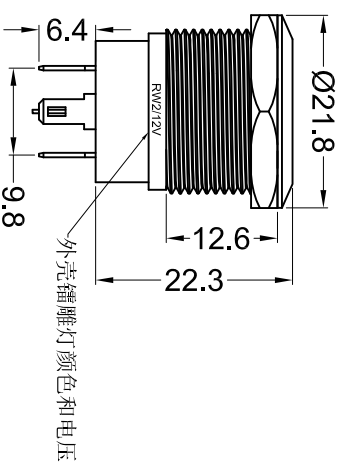
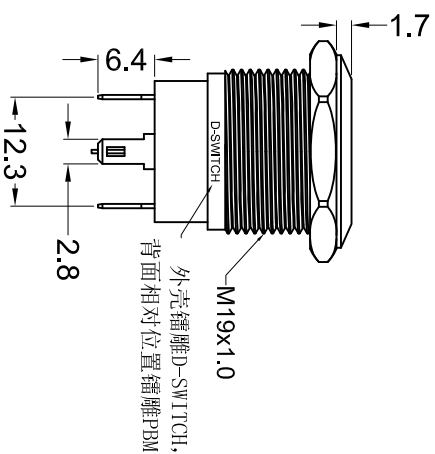

东莞市德松电子有限公司
 D-SWITCH ELECTRONICS CO.,LTD

公差 TOLERANCES .X±0.5 .XX±0.3 角度 ANGLE ±1° 单位 DIMENSION UNIT mm.

版本 VER	变更说明 CHANGE DESCRIPTION	日期 DATE	ECON NO.	版本 VERSION	比例尺 SCALE	日期 DATE	品名 TITLE	图号 DRAWING NO
				A0	1:1	2021.04.27	PBM-19M12-FT-RW2-R12-88S-LA3-0004	1013278
				核准 APPROVED BY	核对 CHECKED BY	绘图 DRAWN BY		
						孙成		