

Peak Emission Wavelength: 850nm

The 850nm high power infrared LED Series is designed for application requiring high accuracy and precision as well as uniform spectral emission. Custom package solutions and sorting are available.

FEATURES

- > Hermetically Sealed TO-18
- > High Output Power
- > Gold Plated Dome Lens
- > Narrow Beam Angle / High Reliability

APPLICATIONS

- > Optical Scanning
- > Linear & Rotary Encoder
- > Edge Sensing / Optical Sensors
- > Optical Switches / Security Systems

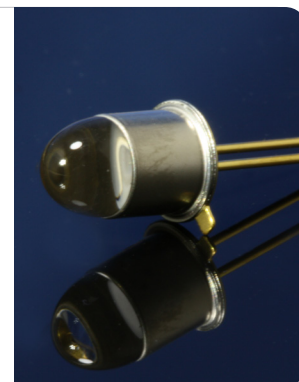

Absolute Maximum Ratings (Ta=25°C)



| ITEMS | SYMBOL | RATINGS | UNIT |
|-----------------------------|--------|------------|------|
| Forward Current (DC) | IF | 100 | mA |
| Forward Current (Pulse)*1 | IFP | 1 | A |
| Reverse Voltage | VR | 5 | V |
| Power Dissipation | PD | 200 | mW |
| Operating Temperature Range | Topr | -20 ~ +85 | °C |
| Storage Temperature Range | Tstg | -30 ~ +100 | °C |
| Junction Temperature | Tj | 260 | °C |

*1: Tw=10μsec, T=10msec.

Electrical & Optical Characteristics (Ta = 25°C)

| ITEMS | SYMBOL | CONDITIONS | MIN | TYP | MAX | UNIT |
|---------------------------|--------|------------|-----|-----|-----|------|
| Power Output | PO | IF=50mA | -- | 6.0 | -- | mW |
| Forward Voltage | VF | IF=50mA | -- | 1.5 | 2.0 | V |
| Reverse Current | IR | VR=5V | -- | -- | 10 | μA |
| Peak Emission Wavelength | λp | IF=50mA | -- | 850 | -- | nm |
| Spectral Line Half Width | Δλ | IF=50mA | -- | 45 | -- | nm |
| Half Intensity Beam Angle | Θ | IF=50mA | -- | ±3 | -- | deg |

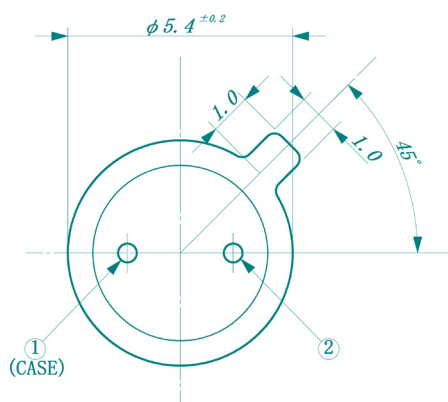
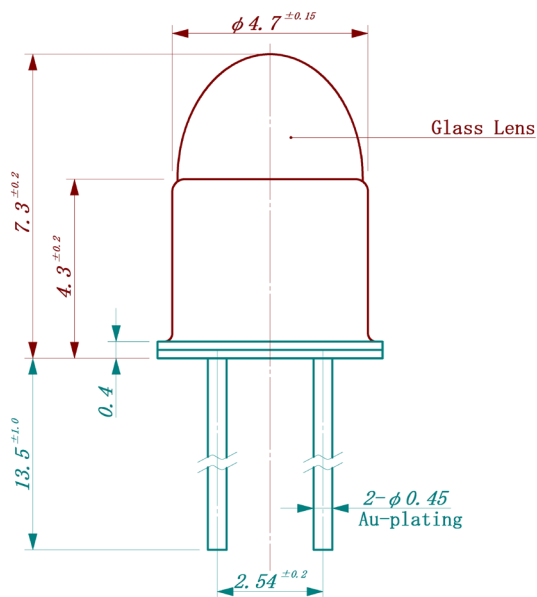

Unit: mm, Tolerance: ± 0.2

The information contained herein is subject to change without notice.

2011-09-28