

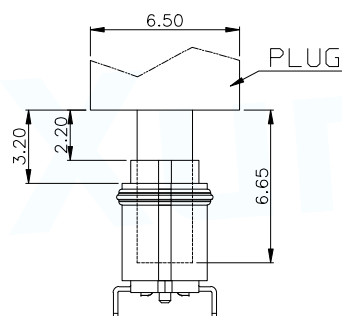

MAPX	MODIFICATION	DATE	DRAW	APPROVE

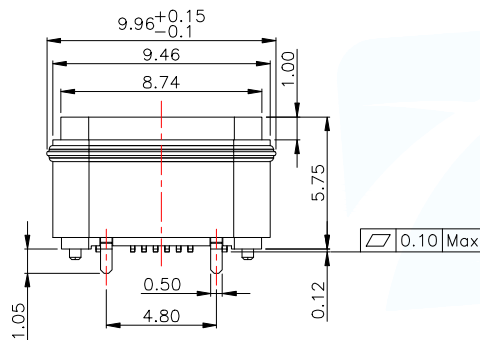

MATED CONDITION(REF.)

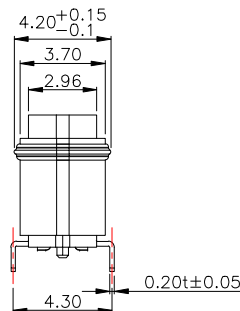
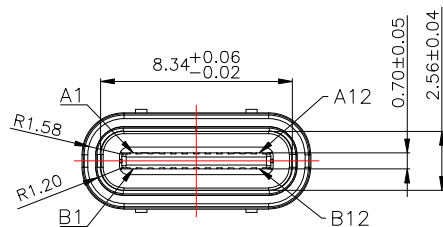
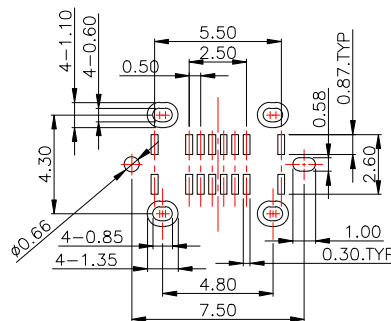
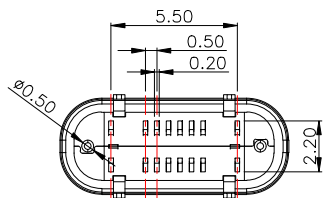

PCB LAYOUT ±0.05

NOTE:

- Material:
 - All Housing: PA46,Black,UL94V-0
 - Insulation Jacket: PA46,Black,UL94V-0
 - Contact: Copper Alloy
 - Mid Plate: Stainless Steel
 - Shell: Stainless Steel
 - O-Ring: silica gel
- FINISH:
 - Contact: Ni 50u" MIN. UNDERPLATED OVER ALL
 - Au PLATED ON THE FUNCTIONAL AREA OF CONTACT. (GOLD PLATING THICKNESS FOLLOW THE P/N)
 - PLATING SPECIFICATIONS OF THE SOLDER AREA FOLLOW THE P/N
 - Mid-Plate: CLEAR ONLY
 - Shell: 30u" MIN Nickel Over All
- Electrical Characteristics:
 - Current Rating: 5A For Pin(A4,A9,B4,B9)
 - 1.25A For Pin(B5)
 - 0.25A For Others Pin
 - Insulation Resistance: 100M Ω Min.
 - Contact Resistance: 50 m Ω Max.
 - Dielectric Withstanding Voltage: 100V/AC 1Minute
- Mechanical Characteristics:
 - Insertion Force: 5~20N
 - Extraction Force: Initial: 8~20N
 - After durability: 6~20N
 - Durability :10000 Cycles
- Operating Temperature: -30°C TO +85°C

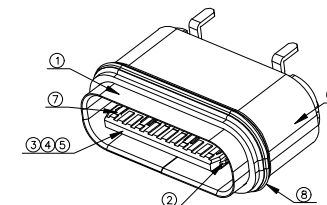

8	O-Ring		SILICA GEL		1PCS
7	Terminal		Copper alloys	1u" Au PLATED ON OF CONTACT	2SET
6	Insulation Jacket		PA46 UL 94V-0 , HF		1PCS
5	Triple Molding				1PCS
4	Second Molding				2PCS
3	Once Molding				1PCS
2	Mid-Plate		Stainless Steel		1PCS
1	Shell		Stainless Steel	Nickel Plating	1PCS

项次 NO.	品名 NAME	料号 PART NUMBER	材料 MATERIAL	表面处理 PLATING	备注 MARK
--------	---------	----------------	-------------	--------------	---------

MANUFACTURE DWG



UNLESS OTHERWISE SPECIFIED TOLERANCES



TITLE: USB TYPE C FEMALE 16PIN SMT TYPE H=5.90mm(IP-X7)

DECIMALS:	ANGLES:
.X:±0.30	X':±3°
.XX:±0.20	X.X':±2°
.XXX:±0.10	

PAR	TYPEC-315DSL-ACP16X7
DWN	
CHKD	
APVD	
SCALE:1:1	UNIT:MM
SIZE:A4	SHEET:1F1
CUSTOMER COPY	REV:A



MAPX	MODIFICATION	DATE	DRAW	APPROVE

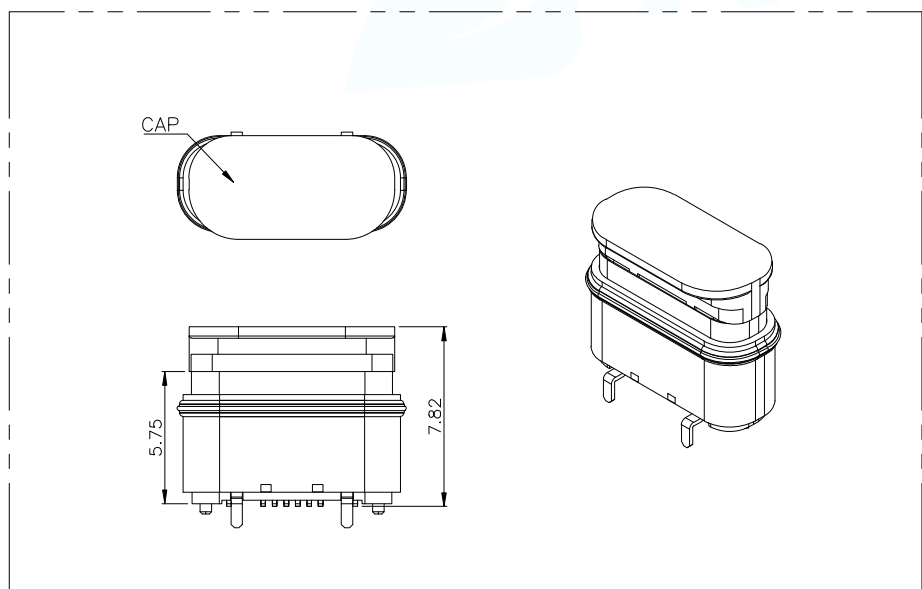
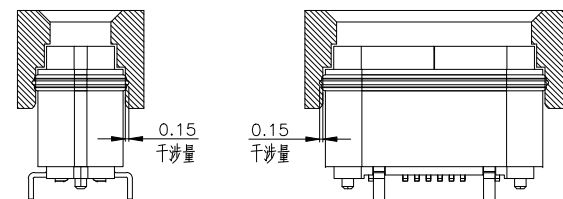
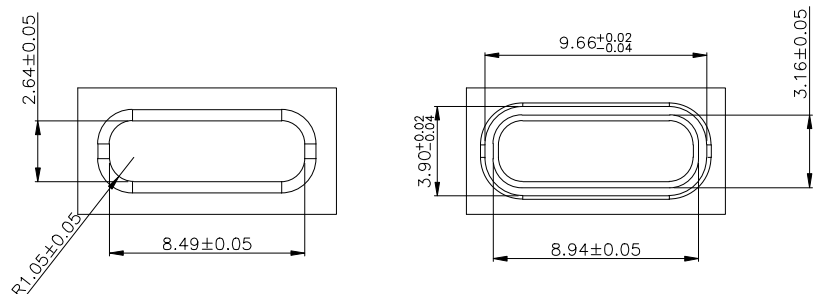

PIN ASSIGNMENT			
PIN NUMBER	SIGNAL NAME	PIN NUMBER	SIGNAL NAME
A1	GND	B12	GND
A2	TX1+	B11	RX1+
A3	TX1-	B10	RX1-
A4	VBUS	B9	VBUS
A5	CC1	B8	SBU2
A6	D+	B7	D-
A7	D-	B6	D+
A8	SBU1	B5	CC2
A9	VBUS	B4	VBUS
A10	RX2+	B3	TX2-
A11	RX2-	B2	TX2+
A12	GND	B1	GND

MANUFACTURE DWG			 东莞市讯普电子科技有限公司 DongGuan XunPu Electronics Co.,Ltd	
UNLESS OTHERWISE SPECIFIED TOLERANCES			TITLE: USB TYPE C FEMALE 16PIN SMT TYPE H=5.90mm(IP-X7)	
DECIMALS:	ANGLES:	PAR	TYPEC-315DSL-ACP16X7	
.X:±0.30	X°.±3'	DWN		
.XX:±0.20	X.X°.±2'	CHKD		
.XXX:±0.10		APVD		
CUSTOMER COPY		SCALE1:1	UNIT:MM	
		SIZE:A4	SHEET:1F1	REV:A

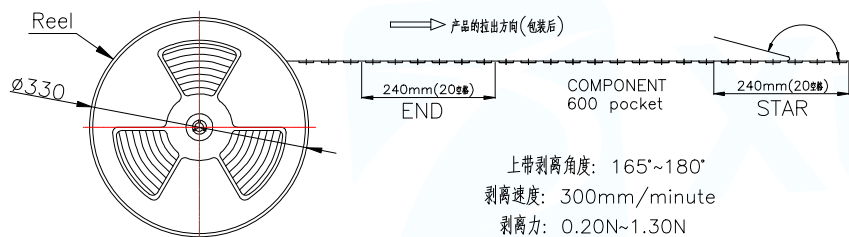
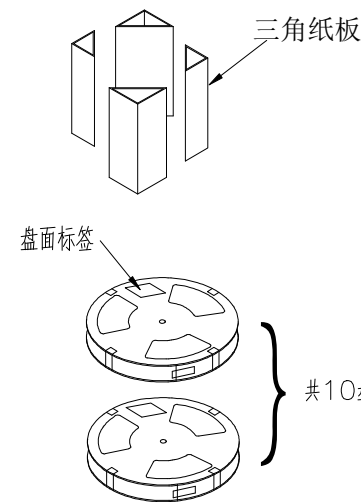
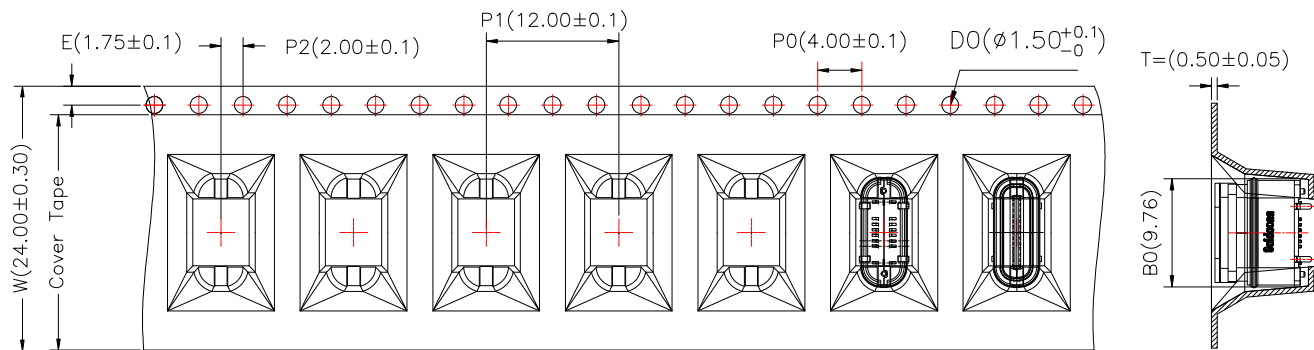

备注:

- 包材规格:
 蓝色卷盘: $\phi 330 * W24mm$
 三角纸板: $100 * 140 * 100 * H315mm$ $K=K$
 自粘上带: $W=21.3mm, T=0.08mm$
 PE袋: $650 * 650mm * 0.07mm$
 外箱: $350 * 350 * 325mm$ (内径) $K=K$
- 将产品依上图所示装入载带中, 载带前后各留20PCS.
 再将自粘上带与载带粘好, 注意不可封孔,
 然后用80-150mm美纹胶固定;
 600pcs/卷盘, 每卷盘都需贴卷盘物料标签.
- 将10个卷盘放入1个大PE防水袋, 装入外箱时需装入护角纸板.
- 每个外箱装10卷盘, 共计6000pcs/箱.
- 将装好产品外箱用透明胶带封成“工”形, 并在外箱左上角贴HF标签, 物料标识区分用的“外箱标签”.

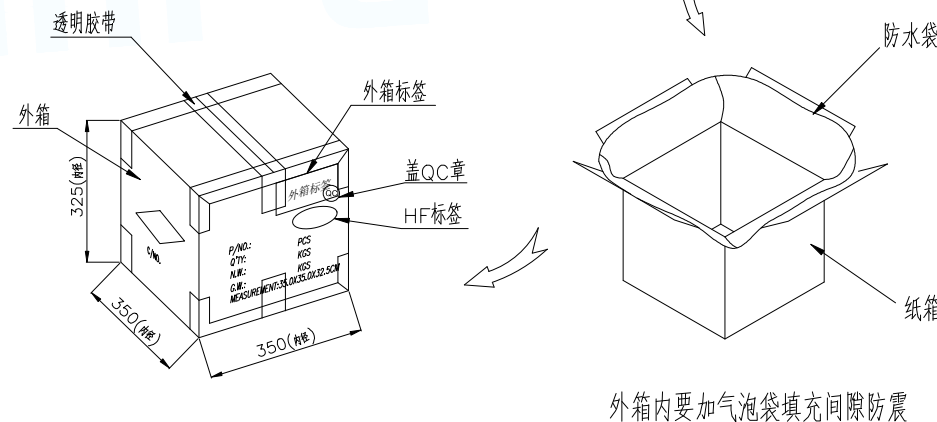

外箱内要加气泡袋填充间隙防震

MANUFACTURE DWG		东莞市讯普电子科技有限公司 DongGuan XunPu Electronics Co., Ltd	
UNLESS OTHERWISE SPECIFIED TOLERANCES			TITLE: USB TYPE C FEMALE 16PIN SMT TYPE H=5.90mm(IP-X7)
DECIMALS:	ANGLES:		PAR TYPEC-315DSL-ACP16X7
.X:±0.30	X'.:±3°		DWN
.XX:±0.20	X.X':±2°	CHKD	APVD
.XXX:±0.10		SCALE1:1	UNIT:MM
CUSTOMER COPY		SIZE:A4	SHEET:1F1
			REV:A