

# Swing clamp cylinder CLR-25-20-R-P-A-K11-R8

Part number: 535485

FESTO

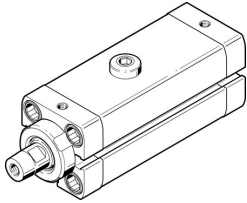

## Data sheet

Feature	Value
Complete stroke	33 mm
Piston diameter	25 mm
Piston rod thread	M6
Swivel angle	90 deg +/- 3 deg
Clamping stroke	20 mm
Type code	CLR
Cushioning	Elastic cushioning rings/pads at both ends
Mounting position	Any
Design	Piston rod Piston Cylinder barrel
Position sensing	For proximity sensor
Swivel direction	Right
Symbol	00991217
Variants	Welding splatter protection Dust protection
Operating pressure	2 bar ... 10 bar
Mode of operation	Double-acting
Operating medium	Compressed air as per ISO 8573-1:2010 [7:4:4]
Information on operating and pilot media	Operation with oil lubrication possible (required for further use)
Corrosion resistance class (CRC)	2 - Moderate corrosion stress
Ambient temperature	-10 °C ... 80 °C
Effective clamping force at 2 bar	63 N
Effective clamping force at 4 bar	127 N
Effective clamping force at 6 bar	188 N
Max. clamping finger screw tightening torque	12 Nm
Theoretical clamping force at 6 bar	227 N
Product weight	470 g
Type of mounting	With through-hole Optionally: With accessories With internal thread
Pneumatic connection	M5
Scraper material	PPS
Flange screws material	Steel Galvanized
Cover material	Coated Wrought aluminum alloy

Feature	Value
Seals material	NBR TPE-U(PU)
Housing material	Smooth anodized Wrought aluminum alloy
Piston rod material	High-alloy stainless steel Coated
Material of cylinder barrel	Wrought aluminum alloy Smooth anodized