

21P~30P
SCALE 0.8:1

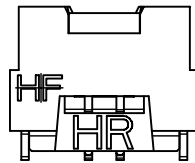

02P

P/N LEGEND

A1253 WVA-S-XP N X B XX X 02 L
① ② ③ ④ ⑤ ⑥ ⑦ ⑧ ⑨ ⑩ ⑪

- ① Series No.
- ② Connector type: WVA=Vertical A Type
- ③ Mounting type: S=SMT
- ④ No. of circuits
- ⑤ N=Halogen Free
- ⑥ Material: 6=Nylon 6T-V0; L=LCP-V0
- ⑦ Color: B=Black
- ⑧ Plating code for contacts:
G1=Gold-flash;T1=Matte Tin-plated
S5=Gold-plated 15u" on Contact Area;
Gold Flash on Solder Area
- ⑨ Plating code for contacts:
G=Gold-flash;T=Matte Tin-plated
- ⑩ Option code: 02=Cap Natural Type
- ⑪ Packing code: L=Tape&Reel(With cap)

SPECIFICATIONS

Current Rating: 1A AC,DC
Voltage Rating: 150V AC,DC
Temperature Range: -25°C ~ +85°C
Contact Resistance: 20mΩ Max.
Insulation Resistance: 500MΩ Min.
Withstanding Voltage: 500V AC/minute
Pin Material: Brass/Gold-flash
Solder Tabs: Brass/Gold-flash
Nickel-plated 30u"↑
Material: LCP/Nylon 6T,UL94V-0
Color: Black

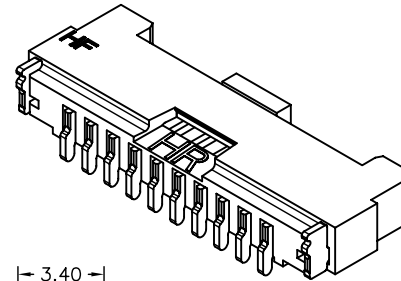
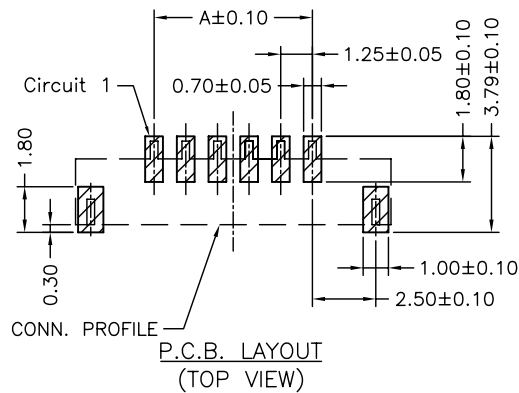
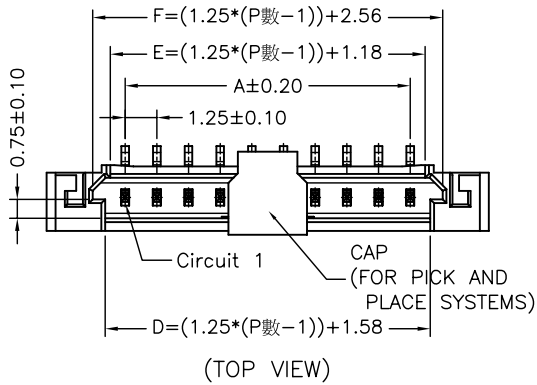

| Circuit No. | Dimensions | | |
|-------------|------------|-------|------|
| | A | B | C |
| 02P | 1.25 | 7.45 | 3.50 |
| 03P | 2.50 | 8.70 | 3.50 |
| 04P | 3.75 | 9.95 | 3.50 |
| 05P | 5.00 | 11.20 | 3.50 |
| 06P | 6.25 | 12.45 | 3.50 |
| 07P | 7.50 | 13.70 | 3.50 |
| 08P | 8.75 | 14.95 | 3.50 |
| 09P | 10.00 | 16.20 | 3.50 |
| 10P | 11.25 | 17.45 | 3.50 |
| 11P | 12.50 | 18.70 | 5.00 |
| 12P | 13.75 | 19.95 | 5.00 |
| 13P | 15.00 | 21.20 | 5.00 |
| 14P | 16.25 | 22.45 | 5.00 |
| 15P | 17.50 | 23.70 | 5.00 |
| 20P | 23.75 | 29.95 | 5.00 |
| 25P | 30.00 | 36.20 | 6.00 |
| 30P | 36.25 | 42.45 | 6.00 |

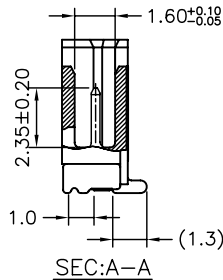
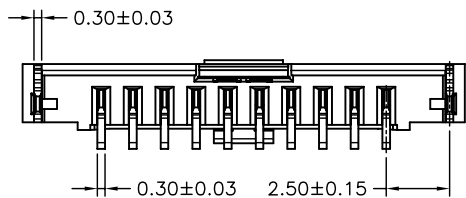
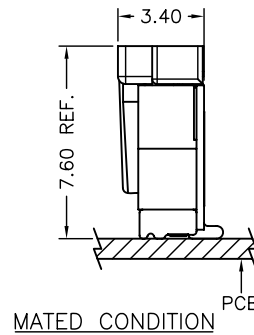
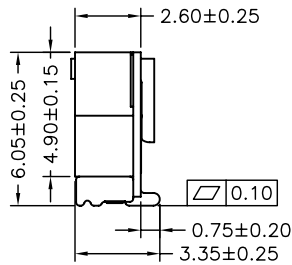
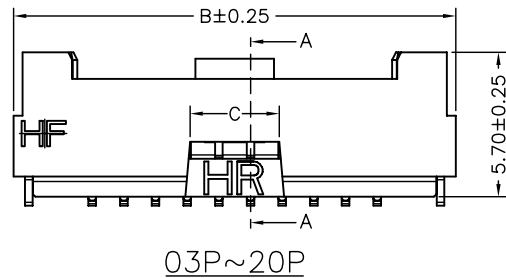

| | | | | | | | |
|-------------------|-------------|-------------|------|--|-------|--------|--------|
| | | | | UNIT | SCALE | SHEET | TITLE: |
| | | | | mm | 1 : 1 | 1 of 2 | |
| DRAWN BY | | APPROVED BY | | 1.25mm PITCH 180° WAFER-SMT TYPE, ULTRA LOW PROFILE, WITHOUT BOSS | | | |
| 周傑亮 | | 謝瑞清 | | | | | |
| 2016.08.03 | | 2016.08.03 | | DRAW NO.: | | | |
| GENERAL TOLERANCE | | | | A1253WVA-S-XPXXXXX02X | | | |
| X.X±0.25 | | ANGLE± | | REV. | | | |
| X.XX±0.15 | | ▽ | | A0 | | | |
| X.XXX±0.05 | | ◎ | | | | | |
| A0 | NEW RELEASE | 2016.08.03 | 周傑亮 | | | | |
| REV. | DESCRIPTION | DATE | NAME | | | | |



02~07 Contacts

08~30 Contacts

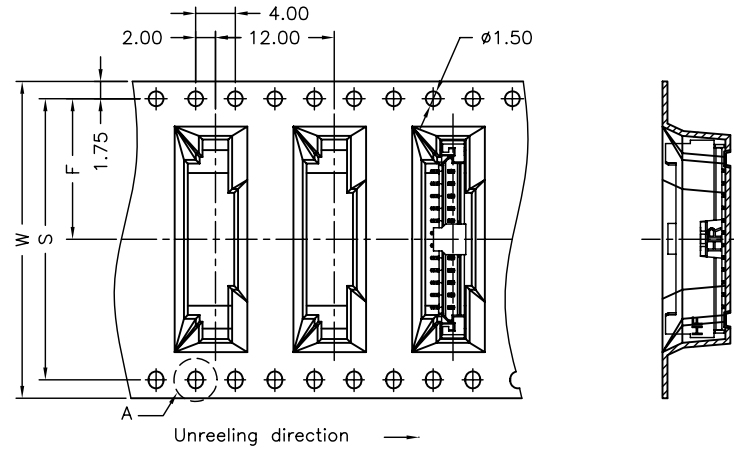
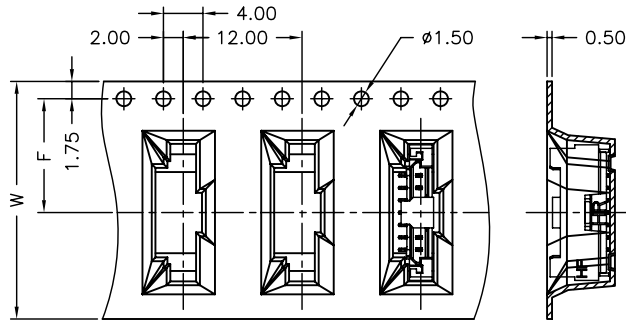

Unreeling direction →

Unreeling direction →

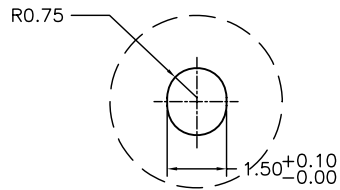
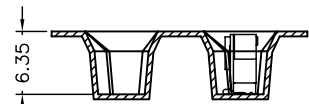

SCALE 4:1
DETAL A

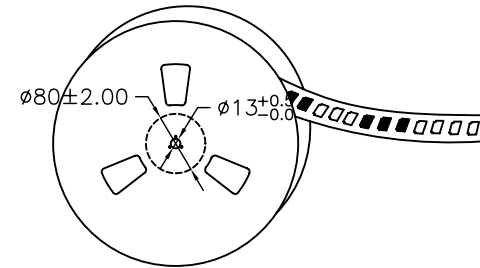
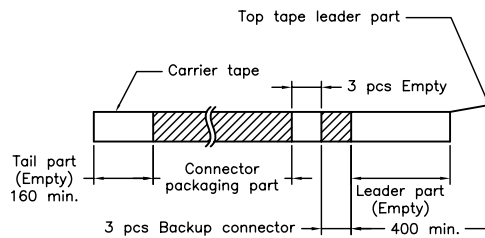

| Number of Contacts | W±0.3 | F±0.1 | S±0.1 | Q'ty/Reel |
|--------------------|-------|-------|-------|-----------|
| 02P | 24 | 11.50 | | 1,000 |
| 03P | 24 | 11.50 | | 1,000 |
| 04P | 24 | 11.50 | | 1,000 |
| 05P | 24 | 11.50 | | 1,000 |
| 06P | 24 | 11.50 | | 1,000 |
| 07P | 24 | 11.50 | | 1,000 |
| 08P | 32 | 14.20 | 28.40 | 1,000 |
| 09P | 32 | 14.20 | 28.40 | 1,000 |
| 10P | 32 | 14.20 | 28.40 | 1,000 |
| 11P | 32 | 14.20 | 28.40 | 1,000 |
| 12P | 44 | 20.20 | 40.40 | 1,000 |
| 13P | 44 | 20.20 | 40.40 | 1,000 |
| 14P | 44 | 20.20 | 40.40 | 1,000 |
| 15P | 44 | 20.20 | 40.40 | 1,000 |
| 20P | 44 | 20.20 | 40.40 | 1,000 |
| 25P | 56 | 26.20 | 52.40 | 1,000 |
| 30P | 56 | 26.20 | 52.40 | 1,000 |

NOTE:
Material:Transparent
Anti-static Polystyrene.

| | | | | | | | |
|--|-------------|-------------|------|-------------------|-------|--|--------|
| 燦達電子工業股份有限公司 JOINT TECH ELECTRONIC IND. CO., LTD. | | | | UNIT | SCALE | SHEET | TITLE: |
| | | | | mm | 1 : 1 | 2 of 2 | |
| DRAWN BY | | APPROVED BY | | GENERAL TOLERANCE | | 1.25mm PITCH 180° WAFER-SMT TYPE, WITHOUT BOSS TAPING SPEC. | |
| 周傑亮 | | 謝瑞清 | | | | | |
| 2016.08.03 | | 2016.08.03 | | X. X±0.25 | | DRAW NO. : | |
| | | | | X. XX±0.15 | | A1253WVA-S-XPNXXXXX02X | |
| | | | | X. XXX±0.05 | | REV. A0 | |
| A0 | NEW RELEASE | 2016.08.03 | 周傑亮 | | | | |
| REV. | DESCRIPTION | DATE | NAME | | | | |