

Rev	AWO #	Description	Date	Appr
-		RELEASED	2/06/10	

APPROVED: _____
 DATE: _____ TITLE: _____

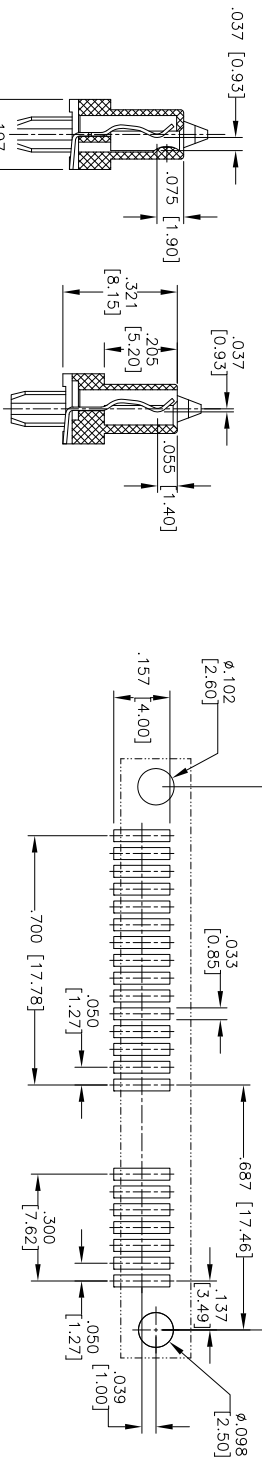

RECOMMENDED PCB LAYOUT

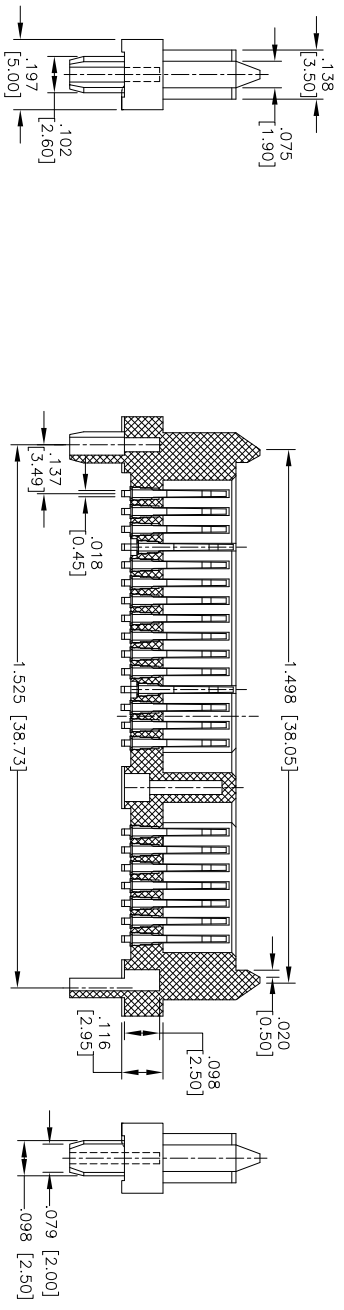
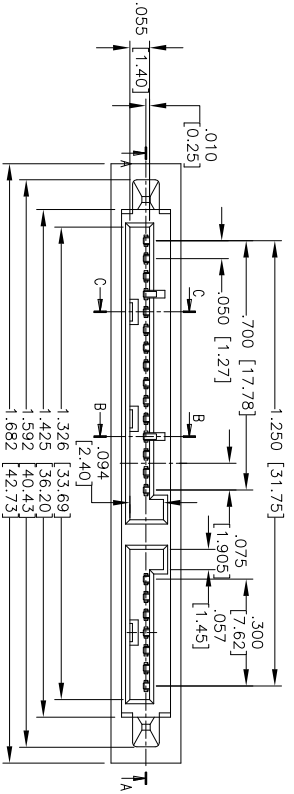
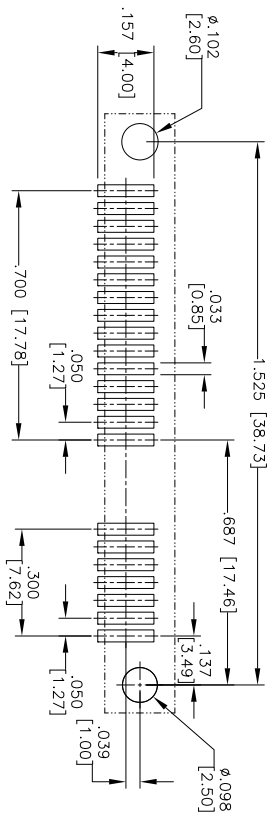

SPECIFICATIONS:
 Material:
 Insulator: LCP, rated UL 94V-0
 Insulator color: Black
 Contacts: Phosphor Bronze
 Plating:
 Gold Flash over Nickel underplate on contact area,
 Tin over Copper underplate on solder tails
 Electrical:
 Operating voltage: 100 VAC max
 Current rating: 1.5 Amps max
 Contact resistance: 30 mohms max
 Insulation resistance: 1,000 Mohms min @ 500 VDC
 Dielectric withstanding voltage: 500 VAC for 1 minute
 Temperature Rating:
 Operating temperature: -55°C to +125°C
 Environmental:
 Lead free, RoHS compliant
 Recommended soldering temp: 260°C for 5 sec.

SECTION A: Gold Flash over Nickel underplate on contact area, Tin over Copper underplate on solder tails

SECTION B: Operating voltage: 100 VAC max

SECTION C: Recommended soldering temp: 260°C for 5 sec.

UNLESS OTHERWISE SPECIFIED
 ALL DIMENSIONS ARE INCHES [MM]
 TOLERANCES: EXCEPT AS NOTED
 INCHES
 .X ± .10 Ø.X
 .XX ± .020 Ø.XX
 .XXX ± .015 Ø.XXX
 APPROVALS
 DRAWN DY 2/06/10
 CHECKED
 APPROVED

ADAM TECH
 909 Railway Avenue, Union, NJ 07083
 Phone: 908-687-5000 Fax: 908-687-5710

TITLE: SATA CONNECTOR, 7P + 15P, VERTICAL
 FEMALE, REVERSE SMT TYPE

SIZE PART NO. X SATA-A4-PM-VT-SMT
 REF: S00078T SCALE: NTS SHEET 1 OF 1