



## MS-228-5

### Mains switching Reed Sensor • M8 thread

#### Electrical Characteristics

Contact form		A
Contact rating max.	W / VA	10
Switching current max.	A	0.5
Carry current max.	A	1.5
Switching voltage max.	VDC	200
	VAC	260
Breakdown voltage min.	VDC	450
Contact resistance (initial) max.	mΩ	100
Insulation resistance min.	Ω	10 <sup>10</sup>
Capacitance typ.	pF	0.2

#### Magnetical Characteristics

Pull in range available <sup>1</sup>	AT	20-35
--------------------------------------	----	-------

<sup>1</sup> AT range stated for unmodified Reed Switch

#### Operating Characteristics

Operate time (incl. bounce) max.	ms	0.6
Release time max.	ms	0.2
Switching frequency max.	Hz	400
Resonant frequency typ.	Hz	3,900
Vibration (50-2000 Hz)	g	30
Shock (1/2 sin 11 ms)	g	100
Operating temperature	°C	-20 to +85

#### Dimensions

in mm

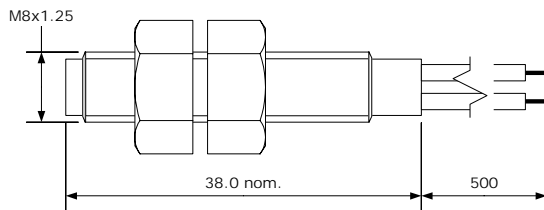

Wire: AWG 24, black, stripped and tinned

#### Ordering Information

Series	AT Range
MS-228-5	3 = 20-25 / 4 = 25-30 / 5 = 30-35

Ordering example: MS-228-5-3 describes MS-228-5 with 20-25 AT

Customized types available.

## MS-228-5

### Mains switching Reed Sensor • M8 thread



### Matching Actuator MSM-228

in mm

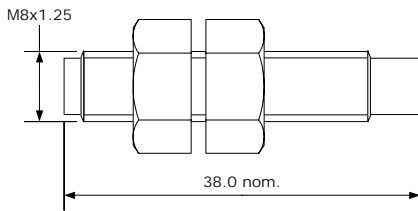

Customized types and other magnet orientations available.