

1N5624 1N5626
1N5625 1N5627

**SILICON
GLASS PASSIVATED RECTIFIERS
5.0 AMP, 200 THRU 800 VOLT**



Central
Semiconductor Corp.

www.centrasemi.com

DESCRIPTION:

The CENTRAL SEMICONDUCTOR 1N5624 series types are silicon rectifiers mounted in a hermetically sealed, glass passivated package, designed for general purpose applications where high reliability is required.

MARKING: FULL PART NUMBER

MAXIMUM RATINGS: ($T_A=25^\circ\text{C}$ unless otherwise noted)

	SYMBOL	1N5624	1N5625	1N5626	1N5627	UNITS
Peak Repetitive Reverse Voltage	V_{RRM}	200	400	600	800	V
DC Blocking Voltage	V_R	200	400	600	800	V
RMS Reverse Voltage	$V_{R(RMS)}$	140	280	420	560	V
Average Forward Current ($T_A=75^\circ\text{C}$)	I_O			3.0		A
Average Forward Current	I_O			5.0		A
Peak Forward Surge Current, $t_p=8.3\text{ms}$	I_{FSM}			100		A
Operating and Storage Junction Temperature	T_J, T_{stg}			-65 to +200		$^\circ\text{C}$

ELECTRICAL CHARACTERISTICS: ($T_A=25^\circ\text{C}$ unless otherwise noted)

SYMBOL	TEST CONDITIONS	MIN	MAX	UNITS
I_R	$V_R=\text{Rated } V_{RRM}$		5.0	μA
V_F	$I_F=3.0\text{A}$		1.0	V

1N5624 1N5626
1N5625 1N5627

SILICON
GLASS PASSIVATED RECTIFIERS
5.0 AMP, 200 THRU 800 VOLT



GPR-4AM CASE - MECHANICAL OUTLINE

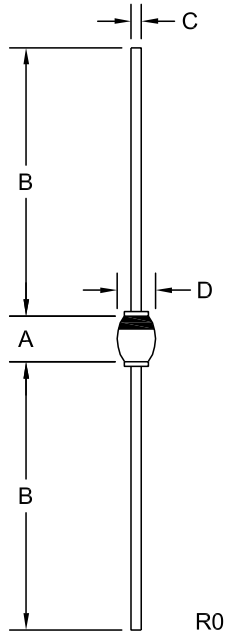

SYMBOL	INCHES		MILLIMETERS	
	MIN	MAX	MIN	MAX
A	0.165	0.189	4.20	4.80
B	1.024	--	26.00	--
C	0.037	0.042	0.95	1.06
D	0.130	0.175	3.30	4.45

GPR-4AM (REV: R0)

R1 (9-April 2013)