

# Binding Post with 4mm Banana Socket

### Features

- Nickel Plated Brass
- Accepts up to 14 Gauge Wire

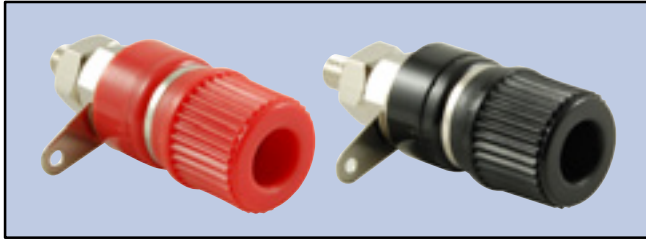

### 81-BP1

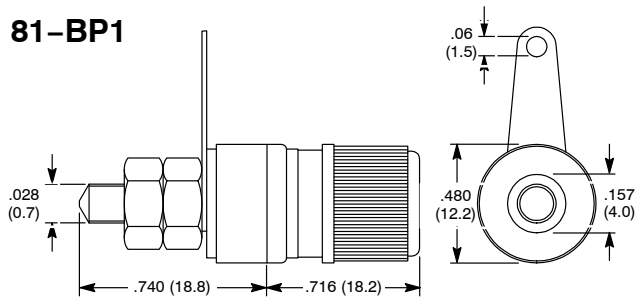

### Specifications

**Current Rating:** 10A  
**Insulation Resistance:** DC500V 100mΩ  
**Dielectric Strength:** AC 1000V 1 minute  
**Temperature Rating:** -20°C to +80°C  
**Insulation Material:** Nylon (UL Flame: 94V-2)  
**Mounting Hole:** 8.5(215.90)

	NTE Type No.	Description
NEW	81-BP1R	Binding Post Red 10A with 4mm Banana Socket Nickel Plated Brass with Nylon Insulation.
NEW	81-BP1B	Binding Post Black 10A with 4mm Banana Socket Nickel Plated Brass with Nylon Insulation.

# Binding Post with 4mm Banana Socket

### Features

- Nickel Plated Brass
- Accepts up to 14 Gauge Wire

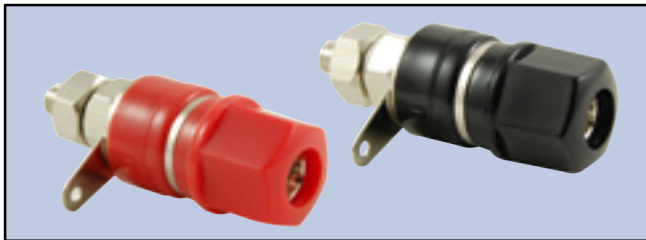

### 81-BP2

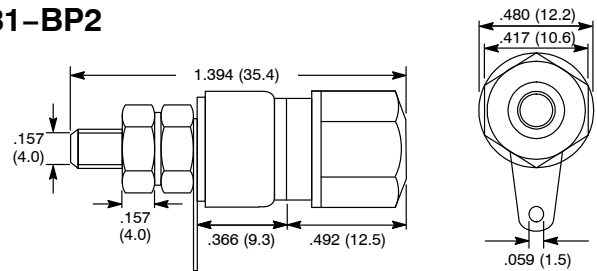

### Specifications

**Current Rating:** 10A  
**Insulation Resistance:** DC500V 100mΩ  
**Dielectric Strength:** AC 1000V 1 minute  
**Temperature Rating:** -20°C to +80°C  
**Insulation Material:** Nylon (UL Flame: 94V-2)  
**Mounting Hole:** 8.5(215.90)

	NTE Type No.	Description
NEW	81-BP2R	Binding Post Red 10A with 4mm Banana Socket Nickel Plated Brass with Nylon Insulation.
NEW	81-BP2B	Binding Post Black 10A with 4mm Banana Socket Nickel Plated Brass with Nylon Insulation.

# Banana Socket 4mm

### Features

- Nickel Plated Brass

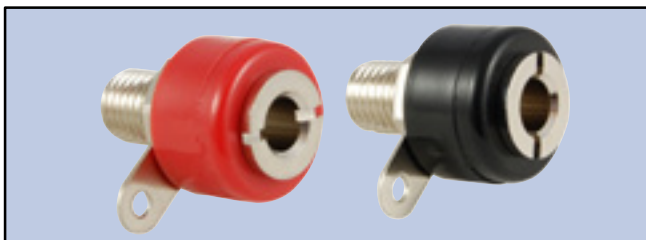

### 81-BP3

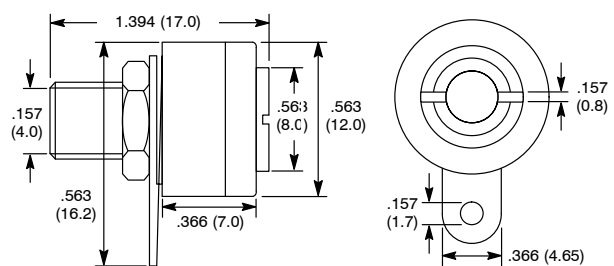

### Specifications

**Current Rating:** 10A  
**Insulation Resistance:** DC500V 100mΩ  
**Dielectric Strength:** AC 1000V 1 minute  
**Temperature Rating:** -20°C to +80°C  
**Insulation Material:** Nylon (UL Flame: 94V-2)  
**Mounting Hole:** 8.5(215.90)

	NTE Type No.	Description
NEW	81-BP3R	4mm Banana Socket Red 10A with Nickel Plated Brass with Nylon Insulation.
NEW	81-BP3B	4mm Banana Socket Black 10A with Nickel Plated Brass with Nylon Insulation.

# Binding Post with 4mm Banana Socket – 2.1mm Cross Hole

## Features

- Nickel Plated Brass
- Accepts up to 14 Gauge Wire

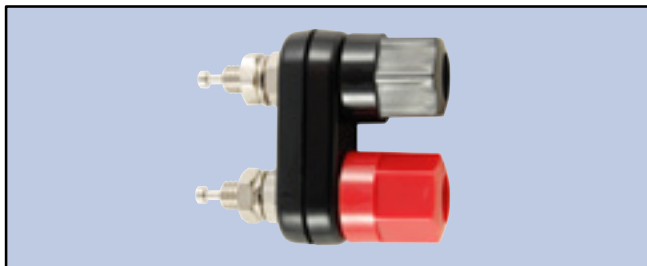

## 81-BP4

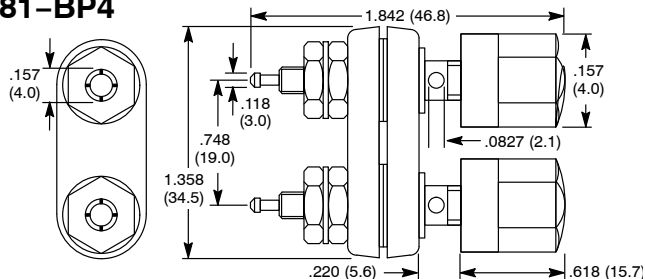

## Specifications

**Current Rating:** 10A  
**Insulation Resistance:** DC500V 100mΩ  
**Dielectric Strength:** AC 1000V 1 minute  
**Temperature Rating:** -10°C to +80°C  
**Insulation Material:** Nylon (UL Flame: 94V-2)  
**Mounting Hole:** 2 Places, 12.8(0.504)

NTE No.	Description
81-BP4BR	Binding Post Dual Black & Red 10A with 4mm Banana Sockets Nickel Plated Brass Nylon Insulation.

NEW

# Banana Socket 4mm

## Features

- Nickel Plated Brass

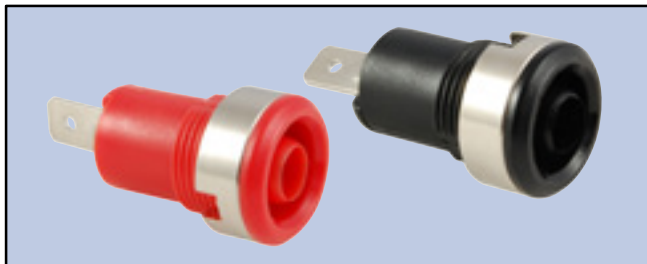

## 81-BS5

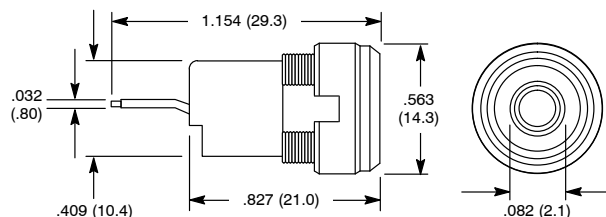

## Specifications

**Current Rating:** 10A  
**Insulation Resistance:** DC500V 100mΩ  
**Dielectric Strength:** AC 1000V 1 minute  
**Temperature Rating:** -20°C to +80°C  
**Insulation Material:** Nylon (UL Flame: 94V-2)  
**Mounting Hole:** 12.2(0.480)

NTE Type No.	Description
81-BS5R	Banana Socket Red 10A Nickel Plated Brass with Nylon Insulation .187 inch QC Terminals.
81-BS5B	Banana Socket Black 10A Nickel Plated Brass with Nylon Insulation .187 inch QC Terminals.

NEW

NEW

# Binding Post with 4mm Banana Socket – 2.2mm & 4mm Cross Hole

## Features

- Nickel Plated Brass
- Accepts up to 14 Gauge Wire



## 81-BP6

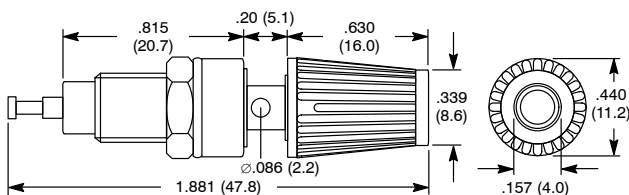

## Specifications

**Current Rating:** 10A  
**Insulation Resistance:** DC500V 100mΩ  
**Dielectric Strength:** AC 1500V 1 minute  
**Temperature Rating:** -20°C to +80°C  
**Insulation Material:** Nylon (UL Flame: 94V-2)  
**Mounting Hole:** 8.0(0.315) x 6.5(0.256)

NTE No.	Description
81-BP6R	Binding Post Red 10A with 4mm Banana Socket Nickel Plated Brass with Nylon Insulation.
81-BP6B	Binding Post Black 10A with 4mm Banana Socket Nickel Plated Brass with Nylon Insulation.

NEW

NEW

## Binding Post with 4mm Banana Socket – 2.2mm & 4mm Cross Hole

### Features

- Nickel Plated Brass
- Accepts up to 14 Gauge Wire

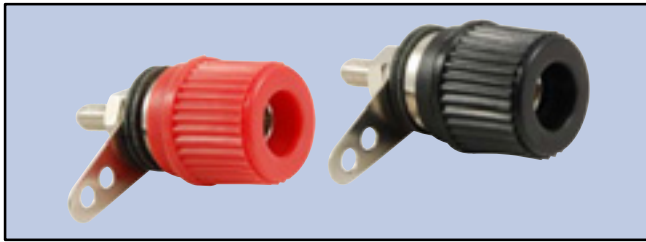

### 81-BP7

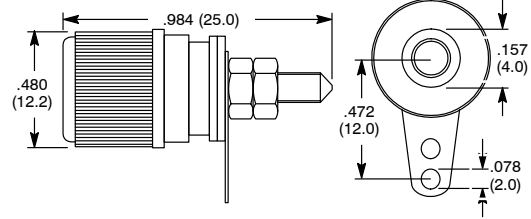

### Specifications

**Current Rating:** 10A  
**Insulation Resistance:** DC500V 100mΩ  
**Dielectric Strength:** AC 500V 1 minute.  
**Temperature Rating:** -20°C to +80°C  
**Insulation Material:** Nylon (UL Flame: 94V-2)  
**Mounting Hole:** 3.2(0.126)

NTE No.	Description
NEW 81-BP7R	Binding Post Red 10A with 4mm Banana Socket Nickel Plated Brass with Nylon Insulation.
NEW 81-BP7B	Binding Post Black 10A with 4mm Banana Socket Nickel Plated Brass with Nylon Insulation.

## Binding Post with 4mm Banana Socket – 2.1mm Cross Hole

### Features

- Nickel Plated Brass
- Accepts up to 14 Gauge Wire



### 81-BP8

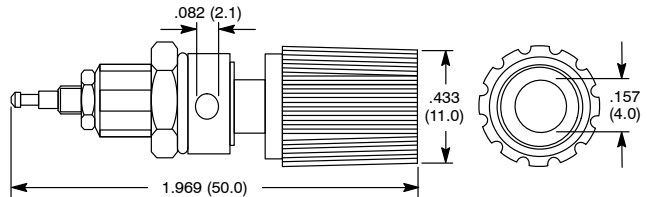

### Specifications

**Current Rating:** 10A  
**Insulation Resistance:** DC500V 100mΩ  
**Dielectric Strength:** AC 1000V 1 minute  
**Temperature Rating:** -20°C to +80°C  
**Insulation Material:** Nylon (UL Flame: 94V-2)  
**Mounting Hole:** 8.2(0.323) x 6.4(0.252)

NTE No.	Description
NEW 81-BP8R	Binding Post Red 10A with 4mm Banana Socket Nickel Plated Brass with Nylon Insulation.
NEW 81-BP8B	Binding Post Black 10A with 4mm Banana Socket Nickel Plated Brass with Nylon Insulation.

## Binding Post with 4mm Banana Socket – 2.2mm & 4mm Cross Hole

### Features

- Nickel Plated Brass
- Accepts up to 14 Gauge Wire



### 81-BP9

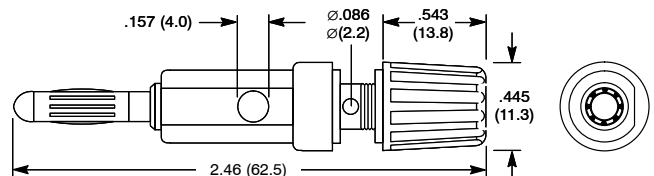

### Specifications

**Current Rating:** 10A  
**Insulation Resistance:** DC500V 100mΩ  
**Dielectric Strength:** AC 1000V 1 minute  
**Temperature Rating:** -20°C to +80°C  
**Insulation Material:** Nylon (UL Flame: 94V-2)  
**Mounting Hole:** N/A

NTE No.	Description
NEW 81-BP9R	Binding Post Red 10A with 4mm Banana Socket Nickel Plated Brass with Nylon Insulation.
NEW 81-BP9B	Binding Post Black 10A with 4mm Banana Socket Nickel Plated Brass with Nylon Insulation.

# Banana Socket 4mm

## Features

- Nickel Plated Brass

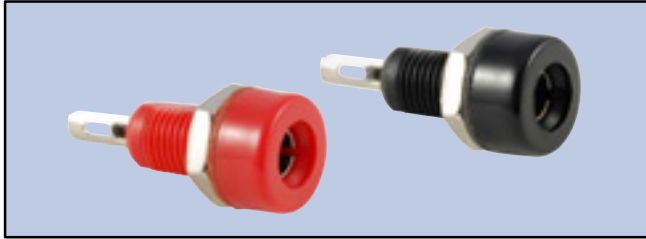

## 81-BS10

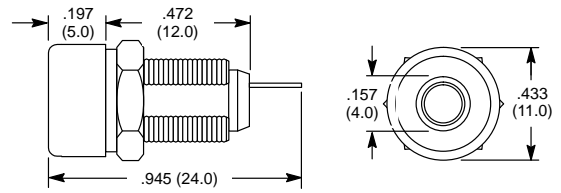

## Specifications

**Current Rating:** 10A

**Insulation Resistance:** DC500V 100mΩ

**Dielectric Strength:** AC 1000V 1 minute

**Temperature Rating:** -20°C to +80°C

**Insulation Material:** Nylon (UL Flame: 94V-2)

**Mounting Hole:** 8.2(0.323) x 6.2(0.244)

NTE Type No.	Description
81-BS10R	Banana Socket Red10A Nickel Plated Brass with Nylon Insulation Solder Terminals.
81-BS10B	Banana Socket Black10A Nickel Plated Brass with Nylon Insulation Solder Terminals.

NEW

NEW