

NOTES: UNLESS OTHERWISE SPECIFIED

1. FOR GENERAL SERIES SPECIFICATIONS, SEE SD10-0000.

2. MATERIAL SPECIFICATIONS:

SHELL: STEEL PER ASTM A568
 INSULATOR: GLASS-FILLED POLYESTER
 BRACKETS: COLD ROLLED STEEL PER A620
 CLINCH NUTS: BRASS PER ASTM B16
 CONTACT: SEE SPECIFICATION SHEET SD31-0000

3. FINISH SPECIFICATIONS:

SHELL: TIN PLATED PER ASTM B545
 INSULATOR: GREEN
 HARDWARE: TIN PLATED PER B545
 CONTACT: SEE SPECIFICATION SHEET SD31-0000

4. BOARDLOCK FORCES:

36 LBS. MAX INSERTION AND 28 LBS. MIN RETENTION FORCE

5 SEE CONTACT SALES DRAWING FOR CONTACT SPECIFICATION

REV	DESCRIPTION	BY DATE	APPD
A	EW707-ER4889	RDG 10/30/07	WPM 10/31/07

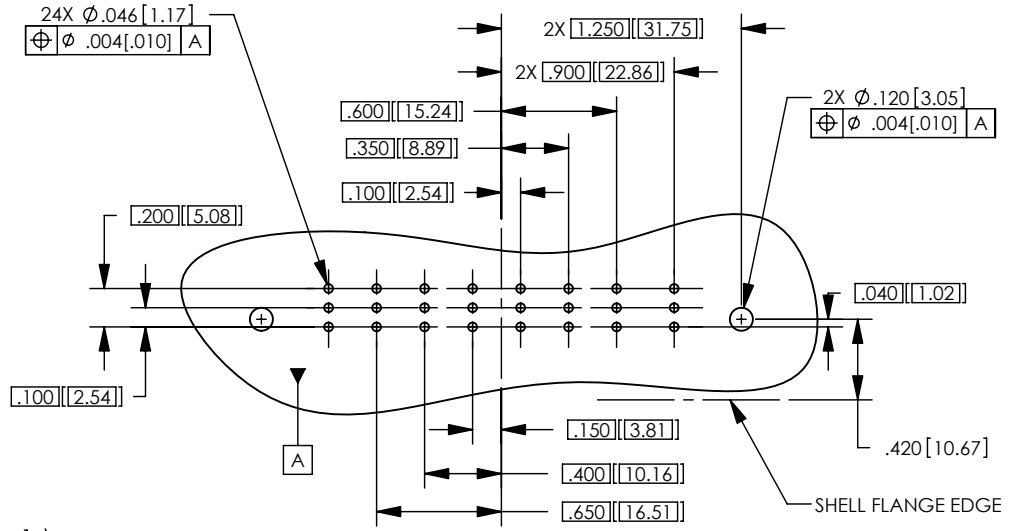

RECOMMENDED PCB LAYOUT;
 FOOTPRINT SHOWS COMPONENT SIDE

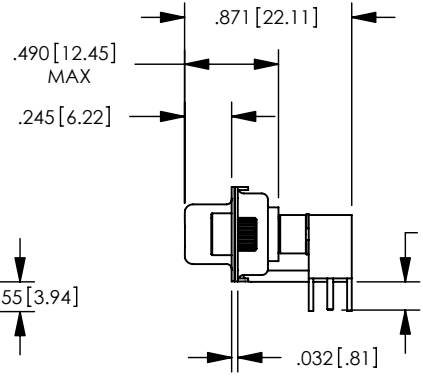
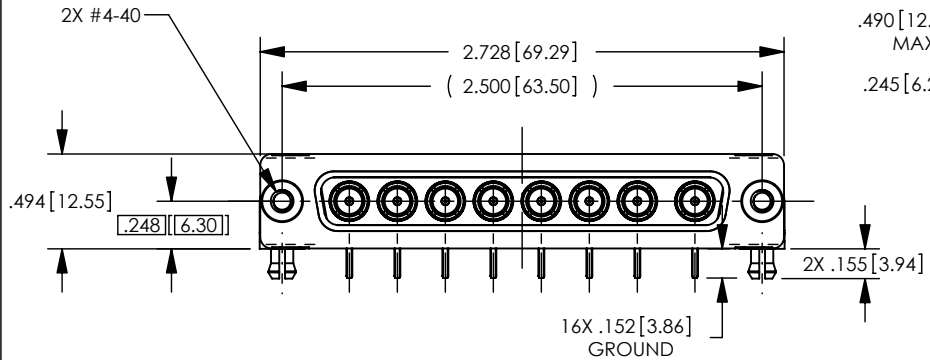
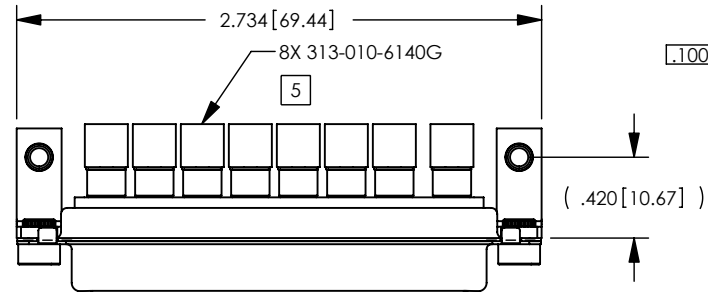

SOME HARDWARE
 REMOVED FOR
 CLARITY THIS VIEW

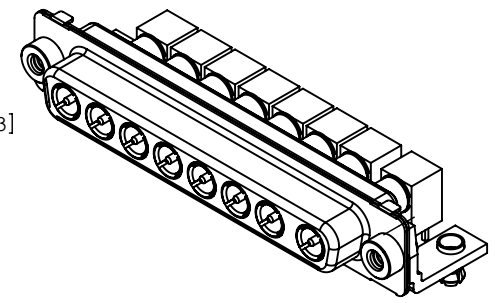

CATALOG P/N: RM8W8S-1044

PER ASME Y14.5M-1994 UNLESS OTHERWISE SPECIFIED: DIMENSIONS ARE IN INCHES [MM] TOLERANCES: DECIMAL: .XX [X.X] ± .01 [0.3] .XXX [X.XX] ± .005 [0.13] .XXXX [X.XXX] ± .0005		ANGLES: ± 2° SCALE: 1:1		 Winchester Electronics Corporation 62 Barnes Industrial Road North Wallingford, Connecticut 06492	
CUSTOMER DRAWING			RM8W8S RIGHT ANGLE D-SUB RECEPTACLE		
DRAWN RDG	DATE 10/30/07	APPROVED WPM	DATE 10/31/07	A SDRM8W8S-1044 SH1 1 OF 1	
APPROVED PM	DATE 10/31/07	APPROVED JB	DATE 10/31/07	REV A	