

# RL-7700-1C

## RL-7700-2C, RL-7700-3C, RL-7700-4C STANDARD CERAMIC WIREWOUND CHIP INDUCTORS

### DESCRIPTION

- Standard Chip Inductor

### ENVIRONMENTAL DATA

- Storage temperature range: -55°C to +130°C
- Operating temperature range: -40°C to +130°C

### PACKAGING INFORMATION

- Packaging information: pg. 490

### FEATURES & APPLICATIONS

- Ceramic core wirewound construction
- No batch-to-batch variations in inductance
- High reliability due to ceramic wirewound construction
- Widely used in the communication applications such as cellular phones and other high frequency electronic devices

Verify operation with sample in actual circuit. Order samples at [www.rencousa.com](http://www.rencousa.com).

### MECHANICAL DIMENSIONS

U.S. Standard (mm)

PART NUMBER	A (MAX.)	B (MAX.)	C (MAX.)	D (REF.)	E (MAX.)	F (MAX.)	G (MAX.)
RL-7700-1C	0.050 (1.27)	0.030 (0.76)	0.020 (0.61)	0.010 (0.15)	0.020 (0.51)	0.009 (0.23)	0.022 (0.56)
RL-7700-2C	0.070 (1.80)	0.040 (1.12)	0.040 (1.02)	0.014 (0.38)	0.030 (0.76)	0.012 (0.33)	0.030 (0.86)
RL-7700-3C	0.090 (2.29)	0.070 (1.73)	0.060 (1.52)	0.020 (0.51)	0.050 (1.27)	0.017 (0.44)	0.040 (1.02)
RL-7700-4C	0.120 (2.92)	0.110 (2.79)	0.080 (2.03)	0.030 (0.65)	0.080 (2.03)	0.020 (0.51)	0.060 (1.52)

PART NUMBER	PART WEIGHT
RL-7700-1C, 2C	0.12g (0.004oz)
RL-7700-3C, 4C	0.13g (0.005oz)

H (REF.)	I (REF.)	J (REF.)
0.030 (0.66)	0.019 (0.50)	0.018 (0.46)
0.040 (1.02)	0.030 (0.64)	0.030 (0.64)
0.070 (1.78)	0.040 (1.02)	0.030 (0.76)
0.100 (2.54)	0.040 (1.02)	0.050 (1.27)

BOTTOM VIEW

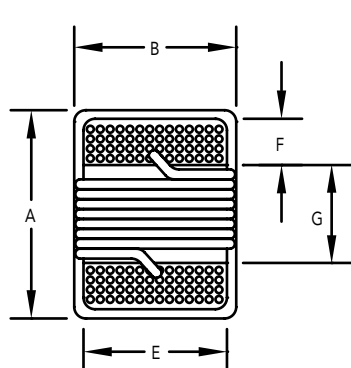

SIDE VIEW

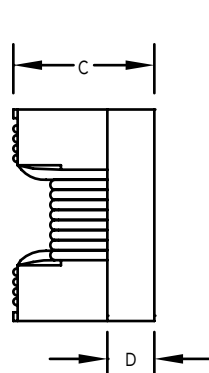

RECOMMENDED LAND PATTERN

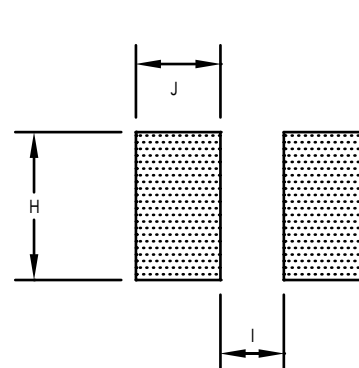

SCHEMATIC

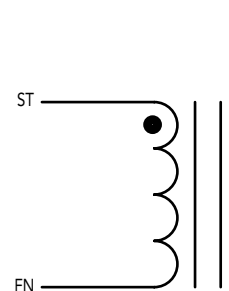

**RENCO ELECTRONICS INC.**

595 International Place, Rockledge, FL 32955-4200 USA • [www.rencousa.com](http://www.rencousa.com) • ISO 9001 Certified  
Toll Free Engineering Hot Line: 800.645.5828 • P: 321.637.1000 • F: 321.637.1600



# RL-7700-1C

Renco Part No. RL-7700-1C	Tolerance Available	L (nH)	DCR Max. (Ohms)	Q Min.	SRF Min. (MHz)	Q Typical 900 MHz	Q Typical 1.7GHz	Testing Frequency (MHz)	Irms (mA) Max.
RL-7700-1C-1N0	K	1.0	0.045	16.0	6000.0	77.0	69.0	250.0	1360.0
RL-7700-1C-2N0	K,J	2.0	0.070	16.0	6000.0	54.0	75.0	250.0	1040.0
RL-7700-1C-2N2	K,J	2.2	0.070	19.0	6000.0	59.0	100.0	250.0	960.0
RL-7700-1C-3N3	K,J	3.3	0.066	19.0	6000.0	65.0	87.0	250.0	840.0
RL-7700-1C-3N6	K,J	3.6	0.066	19.0	6000.0	45.0	71.0	250.0	840.0
RL-7700-1C-3N9	K,J	3.9	0.066	19.0	5800.0	50.0	75.0	250.0	840.0
RL-7700-1C-5N1	K,J	5.1	0.083	20.0	5800.0	56.0	82.0	250.0	800.0
RL-7700-1C-5N6	K,J	5.6	0.083	20.0	5800.0	54.0	81.0	250.0	760.0
RL-7700-1C-6N2	K,J	6.2	0.083	20.0	5800.0	52.0	76.0	250.0	760.0
RL-7700-1C-7N5	K,J	7.5	0.104	22.0	5800.0	60.0	88.0	250.0	680.0
RL-7700-1C-8N2	K,J	8.2	0.104	22.0	4400.0	57.0	84.0	250.0	680.0
RL-7700-1C-9N0	K,J	9.0	0.104	22.0	4160.0	62.0	78.0	250.0	680.0
RL-7700-1C-10N	K,J	10.0	0.195	21.0	3900.0	50.0	67.0	250.0	480.0
RL-7700-1C-11N	K,J	11.0	0.120	24.0	3680.0	52.0	78.0	250.0	640.0
RL-7700-1C-12N	K,J	12.0	0.120	24.0	3600.0	53.0	71.0	250.0	640.0
RL-7700-1C-15N	K,J	15.0	0.172	24.0	3280.0	55.0	77.0	250.0	560.0
RL-7700-1C-19N	K,J	19.0	0.202	24.0	3040.0	50.0	67.0	250.0	480.0
RL-7700-1C-23N	K,J	23.0	0.214	24.0	2720.0	49.0	64.0	250.0	400.0
RL-7700-1C-27N	K,J	27.0	0.298	24.0	2480.0	49.0	63.0	250.0	400.0
RL-7700-1C-36N	K,J	36.0	0.403	24.0	2320.0	44.0	53.0	250.0	320.0
RL-7700-1C-40N	K,J	40.0	0.500	24.0	2240.0	44.0	33.0	250.0	320.0
RL-7700-1C-47N	K,J	47.0	0.830	20.0	2100.0	38.0	-	250.0	250.0
RL-7700-1C-56N	K,J	56.0	1.117	25.0	2000.0	-	-	250.0	200.0

## NOTES:

### 1. ELECTRICAL SPECIFICATIONS MEASURED AT 25°C

2. Irms - CURRENT THAT CAUSES THE TEMPERATURE TO RISE APPROX. 40°C ABOVE AMBIENT OF 25°C

3. TEST EQUIPMENT: AGILENT / HP 4287 + AGILENT / HP 8753D OR HP 4291A

4. WHEN HAND SOLDERING, APPLY SOLDER IRON TO THE PRINTED CIRCUIT BOARD ONLY. TEMPERATURE OF THE IRON TIP SHOULD NOT EXCEED 260°C WITH SOLDERING TIME < 3 SECONDS

5. REFLOW SOLDERING CONDITION: 230°C FOR 10 SECONDS MAX

## PART NUMBER IDENTIFICATION

RL-7700 -2 C 4N7 K  
(1) (2) (3) (4) (5)

(1) SERIES NAME

(2) DIMENSIONS

(3) TYPE CODE C - CERAMIC

(4) INDUCTANCE CODE

(5) TOLERANCE CODE: G - ±2% J - ±5% K - ±10%



## RENCO ELECTRONICS INC.

595 International Place, Rockledge, FL 32955-4200 USA • [www.rencousa.com](http://www.rencousa.com) • ISO 9001 Certified  
Toll Free Engineering Hot Line: 800.645.5828 • P: 321.637.1000 • F: 321.637.1600



# RL-7700-2C

Renco Part No. RL-7700-2C	Tolerance Available	L (nH)	DCR Max. (Ohms)	Q Min.	SRF Min. (MHz)	Q Typical 900 MHz	Q Typical 1.7GHz	Testing Frequency (MHz)	Irms (mA) Max.
RL-7700-2C-1N6	K,J	1.6	0.040	16.0	6000.0	35.0	55.0	250.0	700.0
RL-7700-2C-1N8	K,J	1.8	0.040	16.0	6000.0	35.0	50.0	250.0	700.0
RL-7700-2C-3N3	K,J	3.3	0.080	22.0	6000.0	47.0	65.0	250.0	700.0
RL-7700-2C-3N6	K,J	3.6	0.063	22.0	5800.0	49.0	65.0	250.0	700.0
RL-7700-2C-3N9	K,J	3.9	0.080	22.0	6000.0	49.0	67.0	250.0	700.0
RL-7700-2C-4N3	K,J	4.3	0.063	22.0	5800.0	49.0	67.0	250.0	700.0
RL-7700-2C-4N7	K,J	4.7	0.120	25.0	5800.0	53.0	67.0	250.0	700.0
RL-7700-2C-5N1	K,J	5.1	0.160	20.0	5800.0	47.0	56.0	250.0	700.0
RL-7700-2C-5N6	K,J	5.6	0.170	20.0	5800.0	56.0	77.0	250.0	700.0
RL-7700-2C-6N8	K,J,G	6.8	0.110	27.0	5800.0	60.0	81.0	250.0	700.0
RL-7700-2C-7N5	K,J,G	7.5	0.110	27.0	4800.0	62.0	81.0	250.0	700.0
RL-7700-2C-8N2	K,J,G	8.2	0.110	27.0	4800.0	64.0	81.0	250.0	700.0
RL-7700-2C-8N7	K,J,G	8.7	0.110	27.0	4800.0	62.0	58.0	250.0	700.0
RL-7700-2C-9N5	K,J,G	9.5	0.130	27.0	4800.0	59.0	61.0	250.0	700.0
RL-7700-2C-10N	K,J,G	10.0	0.130	31.0	4800.0	66.0	83.0	250.0	700.0
RL-7700-2C-11N	K,J,G	11.0	0.086	31.0	4000.0	53.0	56.0	250.0	700.0
RL-7700-2C-12N	K,J,G	12.0	0.130	35.0	4000.0	72.0	83.0	250.0	700.0
RL-7700-2C-15N	K,J,G	15.0	0.170	35.0	4000.0	64.0	89.0	250.0	700.0
RL-7700-2C-16N	K,J,G	16.0	0.110	35.0	3300.0	55.0	52.0	250.0	700.0
RL-7700-2C-18N	K,J,G	18.0	0.170	35.0	3100.0	70.0	69.0	250.0	700.0
RL-7700-2C-22N	K,J,G	22.0	0.190	38.0	3000.0	73.0	71.0	250.0	700.0
RL-7700-2C-24N	K,J,G	24.0	0.130	38.0	2800.0	45.0	40.0	250.0	700.0
RL-7700-2C-27N	K,J,G	27.0	0.220	40.0	2800.0	74.0	65.0	250.0	600.0
RL-7700-2C-30N	K,J,G	30.0	0.153	40.0	2800.0	47.0	28.0	250.0	600.0
RL-7700-2C-33N	K,J,G	33.0	0.220	40.0	2300.0	67.0	42.0	250.0	600.0
RL-7700-2C-36N	K,J,G	36.0	0.250	40.0	2800.0	47.0	24.0	250.0	600.0
RL-7700-2C-39N	K,J,G	39.0	0.250	40.0	2200.0	60.0	40.0	100.0	600.0

RL-7700-2C TABLE CONTINUES ON FOLLOWING PAGE

**NOTES:**

1. ELECTRICAL SPECIFICATIONS MEASURED AT 25°C
2. I<sub>rms</sub> - CURRENT THAT CAUSES THE TEMPERATURE TO RISE APPROX. 40°C ABOVE AMBIENT OF 25°C
3. TEST EQUIPMENT: AGILENT / HP 4287 + AGILENT / HP 8753D OR HP 4291A
4. WHEN HAND SOLDERING, APPLY SOLDER IRON TO THE PRINTED CIRCUIT BOARD ONLY. TEMPERATURE OF THE IRON TIP SHOULD NOT EXCEED 260°C WITH SOLDERING TIME < 3 SECONDS
5. REFLOW SOLDERING CONDITION: 230°C FOR 10 SECONDS MAX

**PART NUMBER IDENTIFICATION**

RL-7700 -2 C 4N7 K  
 (1) (2) (3) (4) (5)

- (1) SERIES NAME
- (2) DIMENSIONS
- (3) TYPE CODE C - CERAMIC
- (4) INDUCTANCE CODE
- (5) TOLERANCE CODE: G - ±2% J - ±5% K - ±10%



**RENCO ELECTRONICS INC.**



595 International Place, Rockledge, FL 32955-4200 USA • www.rencousa.com • ISO 9001 Certified  
 Toll Free Engineering Hot Line: 800.645.5828 • P: 321.637.1000 • F: 321.637.1600

# RL-7700-2C

Renco Part No. RL-7700-2C	Tolerance Available	L (nH)	DCR Max. (Ohms)	Q Min.	SRF Min. (MHz)	Q Typical 900 MHz	Q Typical 1.7GHz	Testing Frequency (MHz)	Irms (mA) Max.
RL-7700-2C-43N	K,J,G	43.0	0.280	38.0	2000.0	44.0	21.0	200.0	600.0
RL-7700-2C-47N	K,J,G	47.0	0.280	38.0	2000.0	62.0	35.0	200.0	600.0
RL-7700-2C-56N	K,J,G	56.0	0.310	38.0	1900.0	56.0	26.0	200.0	600.0
RL-7700-2C-68N	K,J,G	68.0	0.340	37.0	1700.0	64.0	21.0	250.0	600.0
RL-7700-2C-72N	K,J,G	72.0	0.490	34.0	1700.0	53.0	20.0	150.0	400.0
RL-7700-2C-82N	K,J,G	82.0	0.540	34.0	1700.0	54.0	21.0	150.0	400.0
RL-7700-2C-R10	K,J,G	100.0	0.580	34.0	1400.0	49.0	-	150.0	400.0
RL-7700-2C-R11	K,J,G	110.0	0.610	32.0	1350.0	43.0	-	150.0	300.0
RL-7700-2C-R12	K,J,G	120.0	0.650	32.0	1300.0	39.0	-	150.0	300.0
RL-7700-2C-R15	K,J,G	150.0	0.950	32.0	1300.0	25.0	-	100.0	280.0
RL-7700-2C-R18	K,J,G	180.0	1.400	25.0	1250.0	20.0	-	100.0	250.0
RL-7700-2C-R22	K,J,G	220.0	1.600	25.0	1200.0	15.0	-	100.0	250.0
RL-7700-2C-R27	K,J,G	270.0	2.100	25.0	3900.0	12.0	-	100.0	200.0
RL-7700-2C-R33	K,J,G	330.0	3.800	25.0	1900.0	15.0	-	100.0	100.0
RL-7700-2C-R39	K,J,G	390.0	4.350	25.0	3900.0	12.0	-	100.0	100.0

## NOTES:

1. ELECTRICAL SPECIFICATIONS MEASURED AT 25°C
2. Irms - CURRENT THAT CAUSES THE TEMPERATURE TO RISE APPROX. 40°C ABOVE AMBIENT OF 25°C
3. TEST EQUIPMENT: AGILENT / HP 4287 + AGILENT / HP 8753D OR HP 4291A
4. WHEN HAND SOLDERING, APPLY SOLDER IRON TO THE PRINTED CIRCUIT BOARD ONLY. TEMPERATURE OF THE IRON TIP SHOULD NOT EXCEED 260°C WITH SOLDERING TIME < 3 SECONDS
5. REFLOW SOLDERING CONDITION: 230°C FOR 10 SECONDS MAX

## PART NUMBER IDENTIFICATION

RL-7700 -2 C 4N7 K  
 (1) (2) (3) (4) (5)

- (1) SERIES NAME
- (2) DIMENSIONS
- (3) TYPE CODE C - CERAMIC
- (4) INDUCTANCE CODE
- (5) TOLERANCE CODE: G - ±2% J - ±5% K - ±10%



# RL-7700-3C

Renco Part No. RL-7700-3C	Tolerance Available	L (nH)	DCR Max. (Ohms)	Q Min.	SRF Min. (MHz)	Q Testing Frequency (MHz)	L Testing Frequency (MHz)	Irms (mA) Max.
RL-7700-3C-2N8	K,J	2.8	0.060	80.0	7900.0	1500.0	250.00	800.0
RL-7700-3C-3N0	K,J	3.0	0.060	65.0	7900.0	1500.0	250.00	800.0
RL-7700-3C-3N3	K,J	3.3	0.080	50.0	6000.0	1500.0	250.00	600.0
RL-7700-3C-5N6	K,J	5.6	0.080	65.0	5500.0	1000.0	250.00	600.0
RL-7700-3C-6N8	K,J	6.8	0.110	50.0	5500.0	1000.0	250.00	600.0
RL-7700-3C-7N5	K,J	7.5	0.140	50.0	4500.0	1000.0	250.00	600.0
RL-7700-3C-8N2	K,J	8.2	0.120	50.0	4700.0	1000.0	250.00	600.0
RL-7700-3C-10N	K,J,G	10.0	0.100	60.0	4200.0	500.0	250.00	600.0
RL-7700-3C-12N	K,J,G	12.0	0.150	50.0	4000.0	500.0	250.00	600.0
RL-7700-3C-15N	K,J,G	15.0	0.170	50.0	3400.0	500.0	250.00	600.0
RL-7700-3C-18N	K,J,G	18.0	0.200	50.0	3300.0	500.0	250.00	600.0
RL-7700-3C-22N	K,J,G	22.0	0.220	55.0	2600.0	500.0	250.00	500.0
RL-7700-3C-24N	K,J,G	24.0	0.220	50.0	2000.0	500.0	250.00	500.0
RL-7700-3C-27N	K,J,G	27.0	0.250	55.0	2500.0	500.0	250.00	500.0
RL-7700-3C-33N	K,J,G	33.0	0.270	60.0	2050.0	500.0	250.00	500.0
RL-7700-3C-36N	K,J,G	36.0	0.270	55.0	1700.0	500.0	250.00	500.0
RL-7700-3C-39N	K,J,G	39.0	0.290	60.0	2000.0	500.0	250.00	500.0
RL-7700-3C-43N	K,J,G	43.0	0.340	60.0	1650.0	500.0	200.00	500.0
RL-7700-3C-47N	K,J,G	47.0	0.310	60.0	1650.0	500.0	200.00	500.0

RL-7700-3C TABLE CONTINUES ON FOLLOWING PAGE

**NOTES:**

1. ELECTRICAL SPECIFICATIONS MEASURED AT 25°C
2. Irms - CURRENT THAT CAUSES THE TEMPERATURE TO RISE APPROX. 40°C ABOVE AMBIENT OF 25°C
3. TEST EQUIPMENT: AGILENT / HP 4287 + AGILENT / HP 8753D OR HP 4291A
4. WHEN HAND SOLDERING, APPLY SOLDER IRON TO THE PRINTED CIRCUIT BOARD ONLY. TEMPERATURE OF THE IRON TIP SHOULD NOT EXCEED 260°C WITH SOLDERING TIME < 3 SECONDS
5. REFLOW SOLDERING CONDITION: 230°C FOR 10 SECONDS MAX

**PART NUMBER IDENTIFICATION**

RL-7700 -2 C 4N7 K  
 (1) (2) (3) (4) (5)

- (1) SERIES NAME
- (2) DIMENSIONS
- (3) TYPE CODE C - CERAMIC
- (4) INDUCTANCE CODE
- (5) TOLERANCE CODE: G - ±2% J - ±5% K - ±10%



**RENCO ELECTRONICS INC.**

595 International Place, Rockledge, FL 32955-4200 USA • www.rencousa.com • ISO 9001 Certified  
 Toll Free Engineering Hot Line: 800.645.5828 • P: 321.637.1000 • F: 321.637.1600



# RL-7700-3C

Renco Part No. RL-7700-3C	Tolerance Available	L (nH)	DCR Max. (Ohms)	Q Min.	SRF Min. (MHz)	Q Testing Frequency (MHz)	L Testing Frequency (MHz)	Irms (mA) Max.
RL-7700-3C-56N	K,J,G	56.0	0.340	60.0	1550.0	500.0	200.00	500.0
RL-7700-3C-68N	K,J,G	68.0	0.380	60.0	1450.0	500.0	200.00	500.0
RL-7700-3C-82N	K,J,G	82.0	0.420	65.0	1300.0	500.0	150.00	400.0
RL-7700-3C-91N	K,J,G	91.0	0.480	65.0	1200.0	500.0	150.00	400.0
RL-7700-3C-R10	K,J,G	100.0	0.460	65.0	1200.0	500.0	150.00	400.0
RL-7700-3C-R11	K,J,G	110.0	0.480	50.0	1000.0	250.0	150.00	400.0
RL-7700-3C-R12	K,J,G	120.0	0.510	50.0	1100.0	250.0	150.00	400.0
RL-7700-3C-R15	K,J,G	150.0	0.560	50.0	920.0	250.0	100.00	400.0
RL-7700-3C-R18	K,J,G	180.0	0.640	50.0	870.0	250.0	100.00	400.0
RL-7700-3C-R22	K,J,G	220.0	0.700	50.0	850.0	250.0	100.00	400.0
RL-7700-3C-R24	K,J,G	240.0	1.000	44.0	690.0	250.0	100.00	350.0
RL-7700-3C-R27	K,J,G	270.0	1.000	48.0	650.0	250.0	100.00	350.0
RL-7700-3C-R33	K,J,G	330.0	1.400	48.0	600.0	250.0	100.00	310.0
RL-7700-3C-R39	K,J,G	390.0	1.500	48.0	560.0	250.0	100.00	290.0
RL-7700-3C-R47	K,J,G	470.0	1.700	33.0	375.0	100.0	50.00	220.0
RL-7700-3C-R56	K,J,G	560.0	1.900	23.0	340.0	50.0	25.00	210.0
RL-7700-3C-R62	K,J,G	620.0	2.200	23.0	220.0	50.0	25.00	210.0
RL-7700-3C-R68	K,J,G	680.0	2.200	23.0	200.0	50.0	25.00	190.0
RL-7700-3C-R75	K,J,G	750.0	2.300	23.0	200.0	50.0	25.00	180.0
RL-7700-3C-R82	K,J,G	820.0	2.350	23.0	200.0	50.0	25.00	180.0
RL-7700-3C-1R0	K,J,G	1000.0	2.500	20.0	100.0	50.0	25.00	170.0
RL-7700-3C-1R2	K,J,G	1200.0	2.500	18.0	100.0	25.0	7.96	170.0
RL-7700-3C-1R5	K,J,G	1500.0	2.500	16.0	100.0	25.0	7.96	170.0
RL-7700-3C-1R8	K,J,G	1800.0	2.500	16.0	80.0	7.96	7.96	170.0
RL-7700-3C-2R2	K,J,G	2200.0	2.700	16.0	60.0	7.96	7.96	160.0
RL-7700-3C-2R7	K,J,G	2700.0	2.950	16.0	50.0	7.96	7.96	150.0

## NOTES:

1. ELECTRICAL SPECIFICATIONS MEASURED AT 25°C
2. I<sub>rms</sub> - CURRENT THAT CAUSES THE TEMPERATURE TO RISE APPROX. 40°C ABOVE AMBIENT OF 25°C
3. TEST EQUIPMENT: AGILENT / HP 4287 + AGILENT / HP 8753D OR HP 4291A
4. WHEN HAND SOLDERING, APPLY SOLDER IRON TO THE PRINTED CIRCUIT BOARD ONLY. TEMPERATURE OF THE IRON TIP SHOULD NOT EXCEED 260°C WITH SOLDERING TIME < 3 SECONDS
5. REFLOW SOLDERING CONDITION: 230°C FOR 10 SECONDS MAX

## PART NUMBER IDENTIFICATION

RL-7700 -2 C 4N7 K  
(1) (2) (3) (4) (5)

- (1) SERIES NAME
- (2) DIMENSIONS
- (3) TYPE CODE C - CERAMIC
- (4) INDUCTANCE CODE
- (5) TOLERANCE CODE: G - ±2% J - ±5% K - ±10%

SURFACE MOUNTS



**RENCO ELECTRONICS INC.**

595 International Place, Rockledge, FL 32955-4200 USA • www.rencousa.com • ISO 9001 Certified  
Toll Free Engineering Hot Line: 800.645.5828 • P: 321.637.1000 • F: 321.637.1600



# RL-7700-4C

Renco Part No. RL-7700-4C	Tolerance Available	L (nH)	DCR Max. (Ohms)	Q Min.	SRF Min. (MHz)	Q Testing Frequency (MHz)	L Testing Frequency (MHz)	Irms (mA) Max.
RL-7700-4C-4N7	K	4.7	0.080	50.0	4100.0	500.00	50.00	1000.0
RL-7700-4C-5N6	K	5.6	0.080	50.0	4100.0	500.00	50.00	1000.0
RL-7700-4C-10N	K,J	10.0	0.080	50.0	4100.0	500.00	50.00	1000.0
RL-7700-4C-12N	K,J	12.0	0.090	50.0	3300.0	500.00	50.00	1000.0
RL-7700-4C-15N	K,J	15.0	0.110	50.0	2500.0	500.00	50.00	1000.0
RL-7700-4C-18N	K,J	18.0	0.120	50.0	2400.0	350.00	50.00	1000.0
RL-7700-4C-22N	K,J	22.0	0.120	55.0	2400.0	350.00	50.00	1000.0
RL-7700-4C-27N	K,J	27.0	0.130	55.0	1600.0	350.00	50.00	1000.0
RL-7700-4C-33N	K,J,G	33.0	0.140	60.0	1600.0	350.00	50.00	1000.0
RL-7700-4C-39N	K,J,G	39.0	0.150	60.0	1500.0	350.00	50.00	1000.0
RL-7700-4C-47N	K,J,G	47.0	0.160	65.0	1500.0	350.00	50.00	1000.0
RL-7700-4C-56N	K,J,G	56.0	0.180	65.0	1300.0	350.00	50.00	1000.0
RL-7700-4C-68N	K,J,G	68.0	0.200	65.0	1300.0	350.00	50.00	1000.0
RL-7700-4C-82N	K,J,G	82.0	0.220	60.0	1000.0	350.00	50.00	1000.0
RL-7700-4C-R10	K,J,G	100.0	0.560	60.0	1000.0	350.00	25.00	650.0
RL-7700-4C-R12	K,J,G	120.0	0.630	60.0	950.0	350.00	25.00	650.0
RL-7700-4C-R15	K,J,G	150.0	0.700	45.0	850.0	100.00	25.00	580.0
RL-7700-4C-R18	K,J,G	180.0	0.770	45.0	750.0	100.00	25.00	620.0
RL-7700-4C-R22	K,J,G	220.0	0.840	45.0	700.0	100.00	25.00	500.0
RL-7700-4C-R27	K,J,G	270.0	0.910	45.0	600.0	100.00	25.00	500.0
RL-7700-4C-R33	K,J,G	330.0	1.050	45.0	570.0	100.00	25.00	450.0
RL-7700-4C-R39	K,J,G	390.0	1.120	45.0	500.0	100.00	25.00	470.0
RL-7700-4C-R47	K,J,G	470.0	1.190	45.0	450.0	100.00	25.00	470.0
RL-7700-4C-R56	K,J,G	560.0	1.330	45.0	415.0	100.00	25.00	400.0
RL-7700-4C-R62	K,J,G	620.0	1.400	45.0	375.0	100.00	25.00	300.0

## RL-7700-4C TABLE CONTINUES ON FOLLOWING PAGE

### NOTES:

1. ELECTRICAL SPECIFICATIONS MEASURED AT 25°C
2. I<sub>rms</sub> - CURRENT THAT CAUSES THE TEMPERATURE TO RISE APPROX. 40°C ABOVE AMBIENT OF 25°C
3. TEST EQUIPMENT: AGILENT / HP 4287 + AGILENT / HP 8753D OR HP 4291A
4. WHEN HAND SOLDERING, APPLY SOLDER IRON TO THE PRINTED CIRCUIT BOARD ONLY. TEMPERATURE OF THE IRON TIP SHOULD NOT EXCEED 260°C WITH SOLDERING TIME < 3 SECONDS
5. REFLOW SOLDERING CONDITION: 230°C FOR 10 SECONDS MAX

### PART NUMBER IDENTIFICATION

RL-7700 -2 C 4N7 K  
 (1) (2) (3) (4) (5)

- (1) SERIES NAME
- (2) DIMENSIONS
- (3) TYPE CODE C - CERAMIC
- (4) INDUCTANCE CODE
- (5) TOLERANCE CODE: G - ±2% J - ±5% K - ±10%



**RENCO ELECTRONICS INC.**



595 International Place, Rockledge, FL 32955-4200 USA • www.rencousa.com • ISO 9001 Certified  
 Toll Free Engineering Hot Line: 800.645.5828 • P: 321.637.1000 • F: 321.637.1600

# RL-7700-4C

Renco Part No. RL-7700-4C	Tolerance Available	L (nH)	DCR Max. (Ohms)	Q Min.	SRF Min. (MHz)	Q Testing Frequency (MHz)	L Testing Frequency (MHz)	Irms (mA) Max.
RL-7700-4C-R68	K,J,G	680.0	1.470	45.0	375.0	100.00	25.00	400.0
RL-7700-4C-R75	K,J,G	750.0	1.540	45.0	360.0	100.00	25.00	360.0
RL-7700-4C-R82	K,J,G	820.0	1.610	45.0	350.0	100.00	25.00	400.0
RL-7700-4C-R91	K,J,G	910.0	1.680	35.0	320.0	50.00	25.00	380.0
RL-7700-4C-1R0	K,J,G	1000.0	1.750	35.0	290.0	50.00	25.00	370.0
RL-7700-4C-1R2	K,J,G	1200.0	2.000	35.0	250.0	50.00	7.96	310.0
RL-7700-4C-1R5	K,J,G	1500.0	2.300	28.0	200.0	50.00	7.96	330.0
RL-7700-4C-1R8	K,J,G	1800.0	2.600	28.0	160.0	50.00	7.96	300.0
RL-7700-4C-2R2	K,J,G	2200.0	2.800	28.0	160.0	50.00	7.96	280.0
RL-7700-4C-2R7	K,J,G	2700.0	3.200	22.0	140.0	25.20	7.96	290.0
RL-7700-4C-3R3	K,J,G	3300.0	3.400	22.0	110.0	25.20	7.96	290.0
RL-7700-4C-3R9	K,J,G	3900.0	3.600	20.0	100.0	25.50	7.96	260.0
RL-7700-4C-4R7	K,J,G	4700.0	4.000	20.0	90.0	25.20	7.96	260.0
RL-7700-4C-5R6	K,J,G	5600.0	4.000	16.0	20.0	7.96	7.96	240.0
RL-7700-4C-6R8	K,J,G	6800.0	4.90	18.0	40.0	7.96	7.96	200.0
RL-7700-4C-8R2	K,J,G	8200.0	6.00	18.0	25.0	7.96	7.96	170.0
RL-7700-4C-100	K,J,G	10000.0	9.00	18.0	20.0	7.96	2.52	150.0
RL-7700-4C-120	K,J,G	12000.0	10.50	18.0	18.0	7.96	2.52	130.0
RL-7700-4C-150	K,J,G	15000.0	11.50	18.0	15.0	7.96	2.52	120.0

## NOTES:

1. ELECTRICAL SPECIFICATIONS MEASURED AT 25°C
2. I<sub>rms</sub> - CURRENT THAT CAUSES THE TEMPERATURE TO RISE APPROX. 40°C ABOVE AMBIENT OF 25°C
3. TEST EQUIPMENT: AGILENT / HP 4287 + AGILENT / HP 8753D OR HP 4291A
4. WHEN HAND SOLDERING, APPLY SOLDER IRON TO THE PRINTED CIRCUIT BOARD ONLY. TEMPERATURE OF THE IRON TIP SHOULD NOT EXCEED 260°C WITH SOLDERING TIME < 3 SECONDS
5. REFLOW SOLDERING CONDITION: 230°C FOR 10 SECONDS MAX

## PART NUMBER IDENTIFICATION

RL-7700 -2 C 4N7 K  
 (1) (2) (3) (4) (5)

- (1) SERIES NAME
- (2) DIMENSIONS
- (3) TYPE CODE C - CERAMIC
- (4) INDUCTANCE CODE
- (5) TOLERANCE CODE: G - ±2% J - ±5% K - ±10%

