

SECT B-B

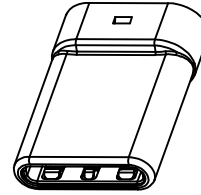

P/N	R/C
U261-24XXN-4B0410	R1(0Ω)-R2(5.1K±1%)-LED1-LED2 (红灯-波长630 TO 640NM)

U261-24XXN-4B0410

C TYPE PLUG:

PCB:

- 1: Au
- 2: Ni

- 1: Au1u"
- 2: Au3u"
- 4: Au15u"
- 5: Au30u"

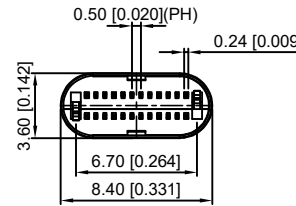
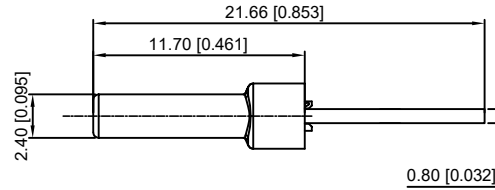
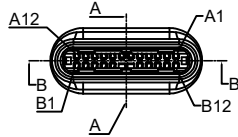
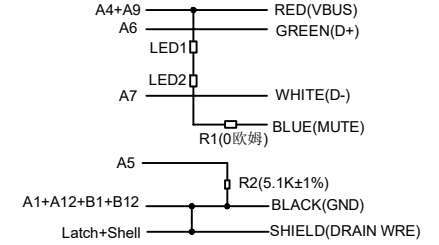

REMARKS:

1.CONTACT INSERTION AND WITHDRAW FORCE:

- 1.Insertion force: 5N-20N max.
2. Withdrawal force: 8N-20N.
- 3.Durability : 10000Cycles.

2.ELECTRIC PROPERTY:

- 1.Contact current rating: 3A.
- 2.Dielectric Strength: 100V AC(RMS).
- 3.Insulation Resistance: 100 megaohms min.
- 4.Contact resistance: 40m0hms MAX.FOR VBUS,GND AND OTHER CONTACT 50m0hms MAX.AFTER ENVIRONMENT TEST

3.AMBIENT TEMPERATURE:

- 1.Operating temperature: -55°C to +85°C.

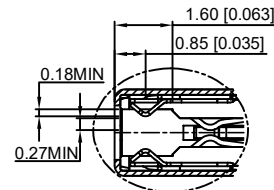

D
2:1

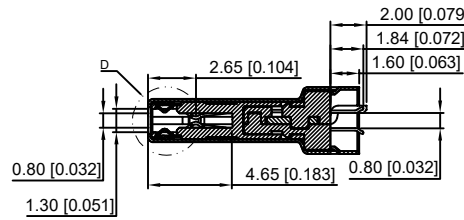

SECT A-A

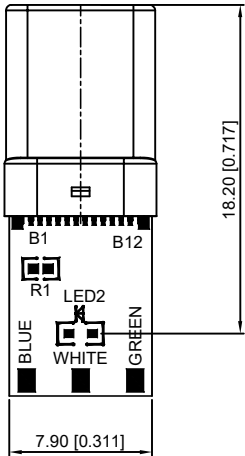

A12	A11	A10	A9	A8	A7	A6	A5	A4	A3	A2	A1
GND	RX2+	RX2-	Vbus	SBU1	D-	D+	CC	Vbus	TX1-	TX1+	GND
GND	TX2+	TX2-	Vbus	Vconn			SBU2	Vbus	RX1-	RX1+	GND
B1	B2	B3	B4	B5	B6	B7	B8	B9	B10	B11	B12

ITEM	DESCRIPTION	MATERIAL	REMARKS
6	Shrapnel	SUS T=0.10mm	
5	Shell	SUS T=0.15mm	Ovep-plating: Ni
4	Terminal	C7025 T=0.15mm	Ovep-plating: Au Ni/Sn
3	Latch	SUS T=0.4mm	
2	Housing	LCP	UL94-0
1	Housing Stopper	LCP	UL94-0

Δx									ANGLAR	±5°
Δx									L ≤ 4	±0.2
Δx									4 < L ≤ 16	±0.3
Δx									16 < L ≤ 63	±0.4
MARK	DESCRIPTION	DATE	REVISED	APPROVED					L > 63	±0.5
REVISIONS									UNSPECIFIED TOLERANCES	
www.xk-dg.cn www.helloxkb.com www.helloxkb.cn										

DSND		DATE		SCALE: N/A	MODEL TYPE: 3.1 TYPE C
DWN		DATE		VIEW:	PART NO.:
CHKD		DATE		UNIT: mm/in	DWG NO.: U261-24XXN-4B0410
APPD		DATE		SIZE: A4	WEIGHT: 1.0g
				KKB INDUSTRIAL PRECISION CO.,LIMITED	SHEET: 1/1
					REVISION: A0