

INTRODUCTION

molex® DuraClik™ SMT 2.00mm (.079") Pitch Wire-to-Board System Single Row, Positive Lock

DuraClik is a new 2.00mm Wire-to-Board connector system for the Automotive market that provides high tolerance to vibration. The connectors are finding use in automotive applications such as steering wheels, gear shifts and air conditioners.

These connectors feature an inner positive lock that provides space savings and prevents lock breakage or half-way locking. The positive lock provides an audible click to confirm mating.

These new connectors are available in 2-8 circuits, with more circuit sizes to be added soon. They include wide solder tabs for secure PCB retention, and polarization features to prevent mis-mating.

Specifications:

- Current: 3.0A
- Voltage: 250V
- Contact Resistance: 20 milliohms max.
- Insulation Resistance: 1000 Megohms min.
- Dielectric Withstanding Voltage: 500V AC
- Operating Temperature: -40 to +105°C
- Packaging: Header — Embossed Tape
Housing — Bag
Terminals — Reel

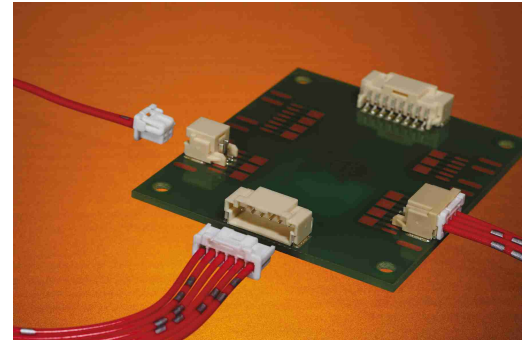

Features

- Positive lock design
- Secure inner-lock system
- Wide/long end fitting solder nails
- SMT tail protector

Benefits

- Audible click sound and tactile feel when the system locks
- Ensures complete connector locking, prevents breakage during handling and provides space savings over outer-locking systems
- Grounding and secure PCB retention to meet vibration requirements
- Prevents bent tails

Grounding/Fitting Nail Feature

Solder nails are positioned on the end of the connector to absorb vibration

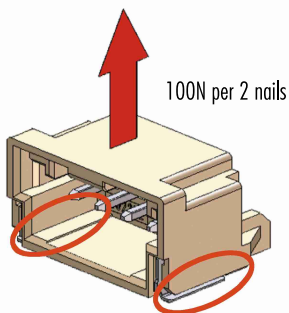

Shockproof SMT Design

Inner Lock System

Inner Lock prevents lock breakage or half-way locking

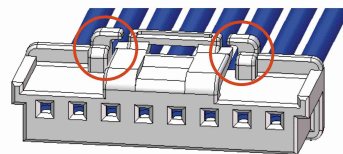

Anti-Fishhook Design

AUTOMOTIVE APPLICATIONS

- Wiper/Blinker lever
- Shift lever
- Air conditioner
- Navigation meters
- Steering Wheel
- Switches

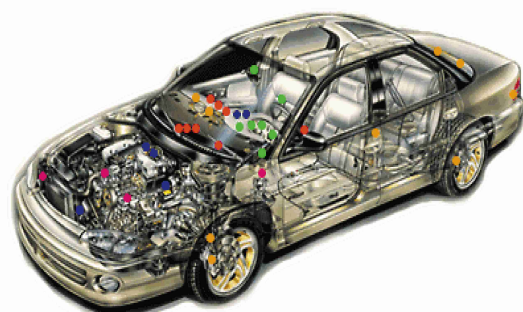

ORDERING INFORMATION

molex® **DuraClik™ SMT**
2.00mm (.079") Pitch
Wire-to-Board System
Single Row, Positive Lock

Header

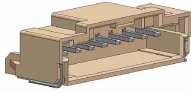

Order No.	Circuits	Height	Width
502352-0200	2	6.40mm (.252")	9.40mm (.370")
502352-0400	4		
502352-0600	6		
502352-0800	8		

Housing

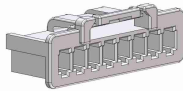

Terminals

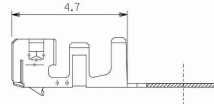

Order No.	Circuits	Height	Width	Terminal AWG 24-30	Terminal AWG 22-30
502351-0200	2	6.40mm (0.25")	9.40mm (.370")	50212-8000(reel) / 50212-8100(bag)	50372-8000(reel) / 50372-8100(bag)
502351-0400	4			50212-8000(reel) / 50212-8100(bag)	50372-8000(reel) / 50372-8100(bag)
502351-0600	6			50212-8000(reel) / 50212-8100(bag)	50372-8000(reel) / 50372-8100(bag)
502351-0800	8			50212-8000(reel) / 50212-8100(bag)	50372-8000(reel) / 50372-8100(bag)

molex®
one company › a world of innovation

Americas Headquarters
 2222 Wellington Ct,
 Lisle, Illinois 60532 USA
 Tel: 1-800-78MOLEX
 amerinfo@molex.com

Asia Pacific North Headquarters
 Yamato, Kanagawa, Japan
 Tel: 81-46-265-2325
 apninfo@molex.com

Asia Pacific South Headquarters
 Jurong, Singapore
 Tel: 65-6-268-6868
 apsinfo@molex.com

European Headquarters
 Munich, Germany
 Tel: 49-89-413092-0
 euroinfo@molex.com

Corporate Headquarters
 2222 Wellington Ct,
 Lisle, Illinois 60532 USA
 Tel: 630-969-4550

Visit our website at www.molex.com