

**1. Mechanical Dimensions:**

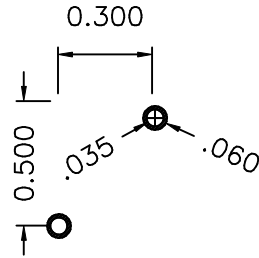

**2. Schematic:**

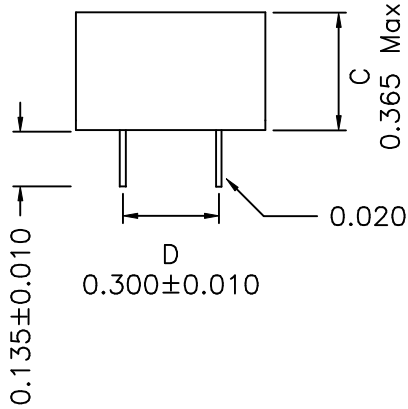
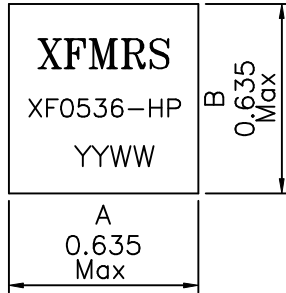
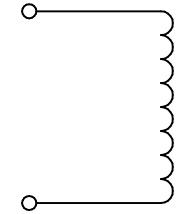

**3. Electrical Specifications: @25°C**

OCL: 53uH ±15% @10KHz 1.0V  
 OCL: 47.7uH Typical @10KHz 1V 1.87Adc  
 DC Resistance: 0.130 Ohms Typ

DOC. REV A/1

<b>XFMRS Inc</b>	Title: <b>POTTED INDUCTOR</b>		
	UNLESS OTHERWISE SPECIFIED		P/N: XF0536-HP
TOLERANCES:	.xxx ±0.010		REV A
Dimensions in INCH	DWN.	廖玉坤	Aug-13-00
	CHK.	李清儿	Aug-13-00
	APP.	BW	Aug-13-00