

### 1. PART NO. EXPRESSION :

S D L 1 3 1 0 P - 1 R 0 M F - □□  
 (a) (b) (c) (d) (e) (f) (g)

- (a) Series code
- (b) Dimension code
- (c) Material code
- (d) Inductance code : 1R0 = 1.00uH
- (e) Tolerance code : M = ±20%
- (f) F : RoHS Compliant
- (g) 10 : Standard
- 11 ~ 99 : Internal control number

### 2. CONFIGURATION & DIMENSIONS :

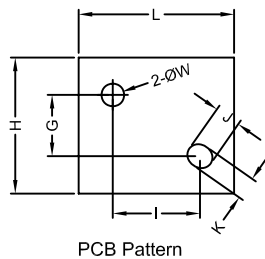
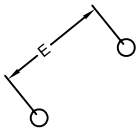
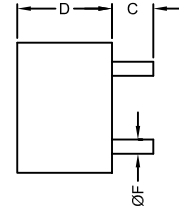
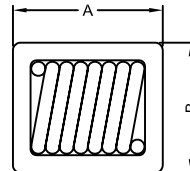
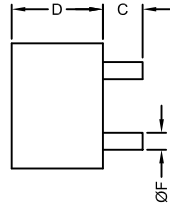
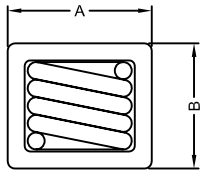

Fig1

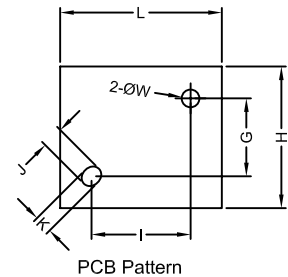
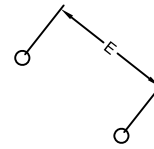
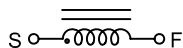

Fig2

Unit:m/m

|      |     | A         | B         | C       | D         | E        | F       | G       | H    | I       | J   | K   | L    | W   |
|------|-----|-----------|-----------|---------|-----------|----------|---------|---------|------|---------|-----|-----|------|-----|
| Fig1 | 1R0 | 13.5 Max. | 12.5 Max. | 3.5±0.5 | 10.0 Max. | 10.2±0.5 | 1.5±0.1 | 6.7±0.5 | 13.2 | 7.7±0.5 | 2   | 1.8 | 14.2 | 1.8 |
| Fig1 | 1R5 | 13.5 Max. | 12.5 Max. | 3.0±0.5 | 9.8±0.5   | 10.3±0.5 | 1.3±0.1 | 6.8±0.5 | 13.2 | 7.7±0.5 | 1.9 | 1.6 | 14.2 | 1.6 |
| Fig1 | 2R0 | 13.5 Max. | 12.5 Max. | 3.5±0.5 | 10.0 Max. | 10.5±0.5 | 1.1±0.1 | 6.8±0.5 | 13.2 | 8.0±0.5 | 1.7 | 1.4 | 14.2 | 1.4 |
| Fig2 | 3R3 | 13.5 Max. | 12.5 Max. | 3.3±0.5 | 10.0 Max. | 10.5±0.5 | 1.0±0.1 | 7.0±0.5 | 13.2 | 7.8±0.5 | 1.6 | 1.3 | 14.2 | 1.3 |
| Fig2 | 4R7 | 13.5 Max. | 12.5 Max. | 3.5±0.5 | 10.0 Max. | 10.6±0.5 | 0.8±0.1 | 7.4±0.5 | 13.2 | 7.6±0.5 | 1.4 | 1.1 | 14.2 | 1.1 |

### 3. SCHEMATIC :



**RoHS Compliant**

NOTE : Specifications subject to change without notice. Please check our website for latest information.

16.09.2015



**SUPERWORLD ELECTRONICS (S) PTE LTD**

#### 4. MATERIALS :

- (a) Core
- (b) Wire

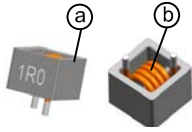

#### 5. GENERAL SPECIFICATION :

- (a) Operating temp. : -40° C to +125° C
- (b) Storage condition (component in its packaging)
  - i) Temperature : -10 to 40° C
  - ii) Humidity : 60%

#### 6. ELECTRICAL CHARACTERISTICS :

| Part No.       | Inductance L <sub>0</sub><br>( $\mu$ H)<br>$\pm 20\%$ @ 0 A | Test<br>Frequency<br>( Hz ) | DCR<br>( m $\Omega$ ) | I <sub>sat</sub><br>(A)<br>Typ. | IDC<br>(A)<br>Typ. |
|----------------|---|-----------------------------|-----------------------|---------------------------------|--------------------|
| SDL1310P-1R0MF | 1.0   | 1V / 100K                   | 1.15 $\pm$ 8%         | 42.0                            | 32.0               |
| SDL1310P-1R5MF | 1.5   | 1V / 100K                   | 1.85 $\pm$ 8%         | 42.0                            | 26.0               |
| SDL1310P-2R0MF | 2.0   | 1V / 100K                   | 3.50 Max.             | 35.0                            | 21.0               |
| SDL1310P-3R3MF | 3.3   | 1V / 100K                   | 5.00 Max.             | 22.0                            | 17.0               |
| SDL1310P-4R7MF | 4.7   | 1V / 100K                   | 8.60 Max.             | 17.0                            | 12.0               |



**RoHS Compliant**

NOTE : Specifications subject to change without notice. Please check our website for latest information.

16.09.2015



**SUPERWORLD ELECTRONICS (S) PTE LTD**

### 7. CHARACTERISTICS CURVES :

#### 7.1 INDUCTANCE ( $\mu\text{H}$ ) VS DC BIAS (Amps)

SDL1310P-1R0MF

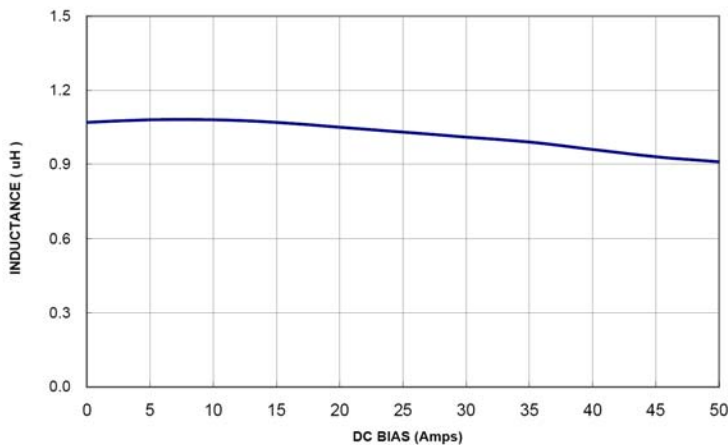

SDL1310P-1R5MF

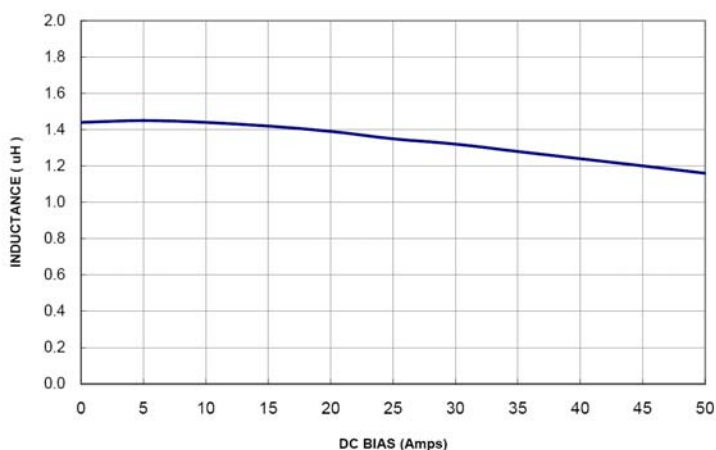

SDL1310P-2R0MF

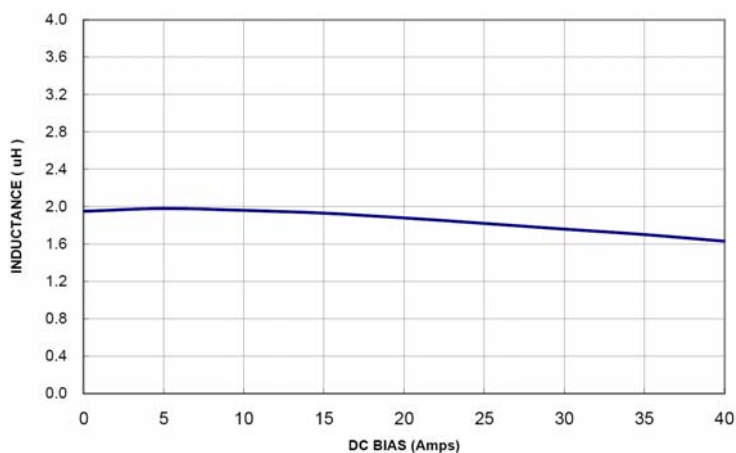

**RoHS Compliant**

NOTE : Specifications subject to change without notice. Please check our website for latest information.

16.09.2015



**SUPERWORLD ELECTRONICS (S) PTE LTD**

SDL1310P-3R3MF

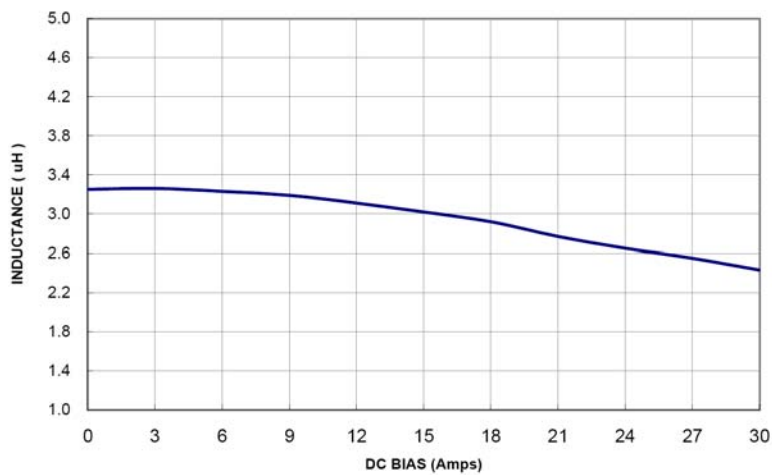

SDL1310P-4R7MF

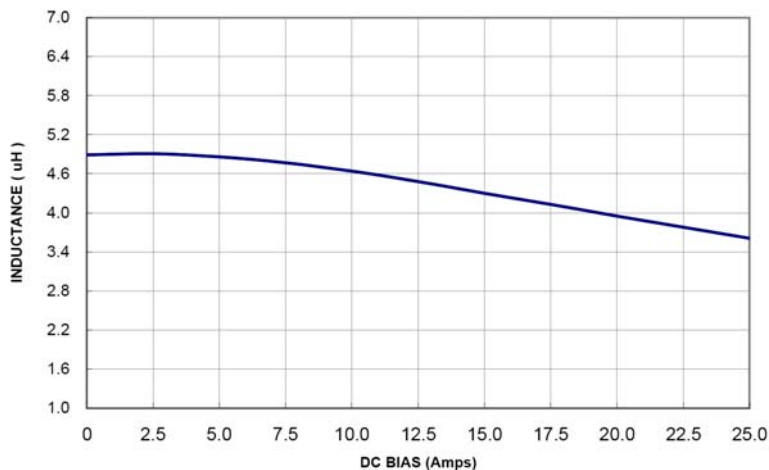

**RoHS Compliant**

NOTE : Specifications subject to change without notice. Please check our website for latest information.

16.09.2015



**SUPERWORLD ELECTRONICS (S) PTE LTD**

PG. 4

### 7.2 TEMPERATURE RISE $\Delta T$ ( $^{\circ}\text{C}$ ) VS DC BIAS (Amps)

SDL1310P-1R0MF

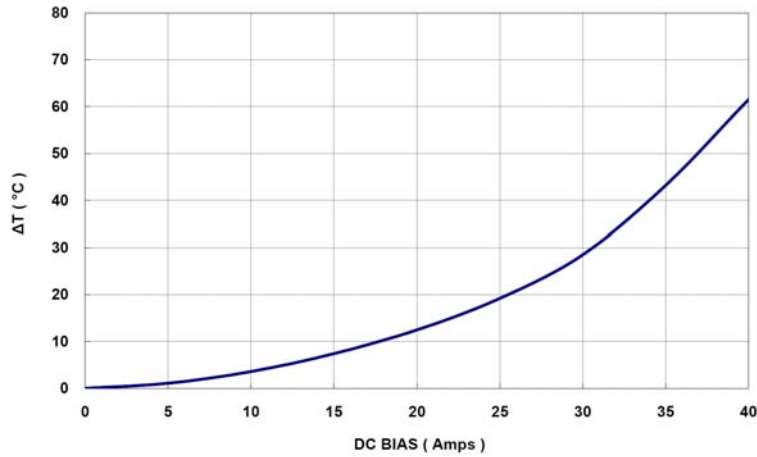

SDL1310P-1R5MF

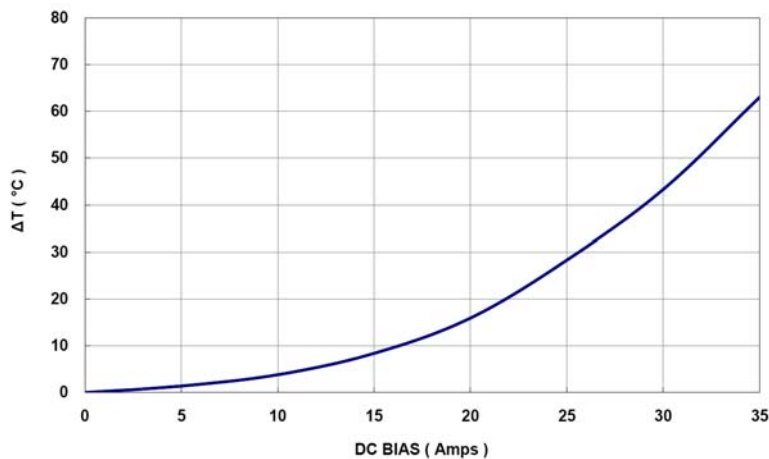

SDL1310P-2R0MF

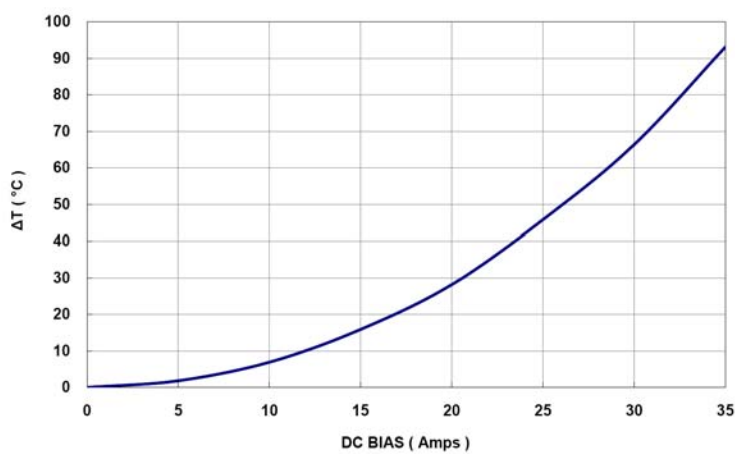

RoHS Compliant

NOTE : Specifications subject to change without notice. Please check our website for latest information.

16.09.2015



SUPERWORLD ELECTRONICS (S) PTE LTD

SDL1310P-3R3MF

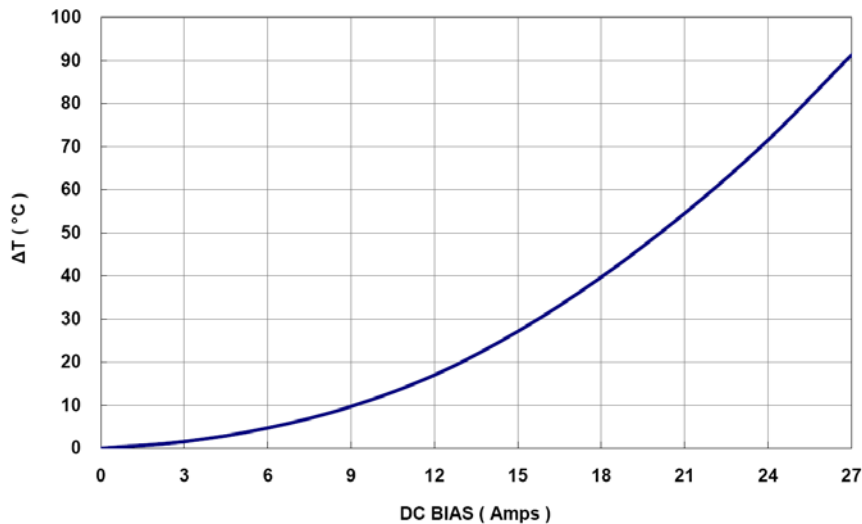

SDL1310P-4R7MF

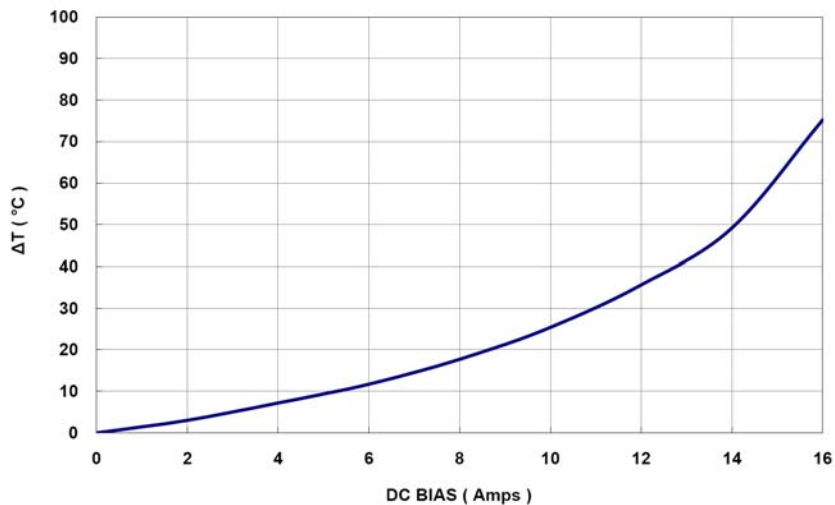

**RoHS Compliant**

NOTE : Specifications subject to change without notice. Please check our website for latest information.

16.09.2015



**SUPERWORLD ELECTRONICS (S) PTE LTD**

PG. 6

## 8. SOLDERING CONDITIONS :

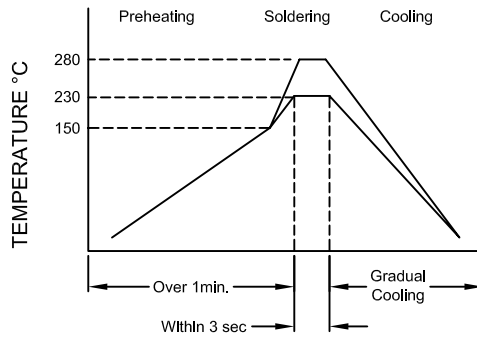
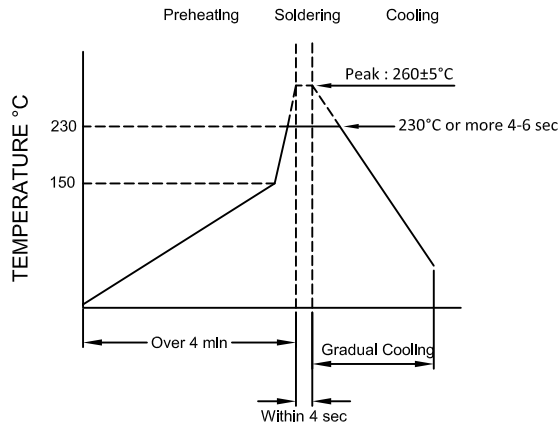

**RoHS Compliant**

NOTE : Specifications subject to change without notice. Please check our website for latest information.

16.09.2015



**SUPERWORLD ELECTRONICS (S) PTE LTD**

### 9. PACKAGING INFORMATION :

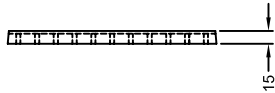
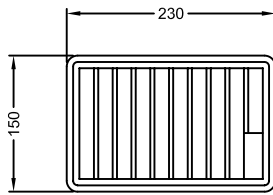

PVC Size : 230x150x15 mm  
Quantity : 100/PVC

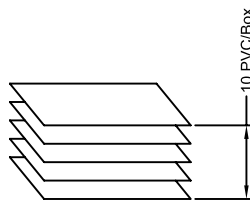
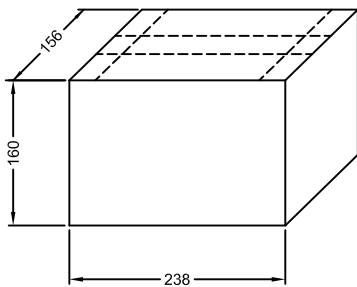

Inbox size : 238x156x160 mm  
Quantity : 10PVC/Box

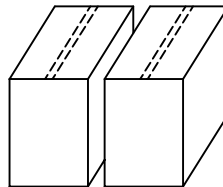
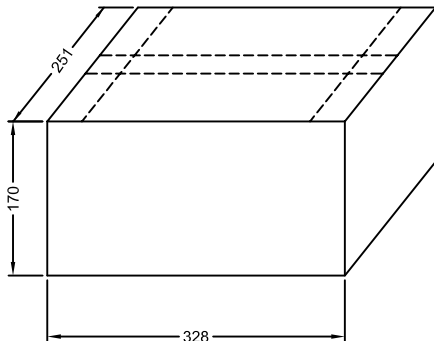

Outbox Size : 328x251x170 mm  
Quantity : 2 Inbox/Outbox

### Storage

- a) Recommended products should be used within 6 months from the time of delivery.
- b) The packaging material should be kept where no chlorine or sulfur exists in the air.

#### Transportation :

- a) Products should be handled with care to avoid damage or contamination from perspiration and skin oils.
- b) The use of tweezers or vacuum pick up is strongly recommended for individual components.
- c) Bulk handling should ensure that abrasion and mechanical shock are minimized.



**RoHS Compliant**

NOTE : Specifications subject to change without notice. Please check our website for latest information.

16.09.2015



**SUPERWORLD ELECTRONICS (S) PTE LTD**