

REV.	DESCRIPTION	DATE	BY	APP'D
A	NPR 2290	03/07/01	KE	

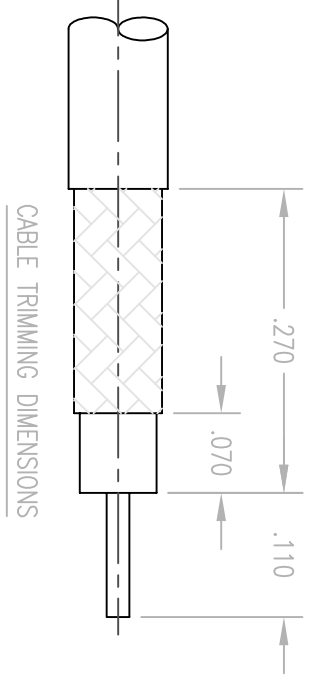
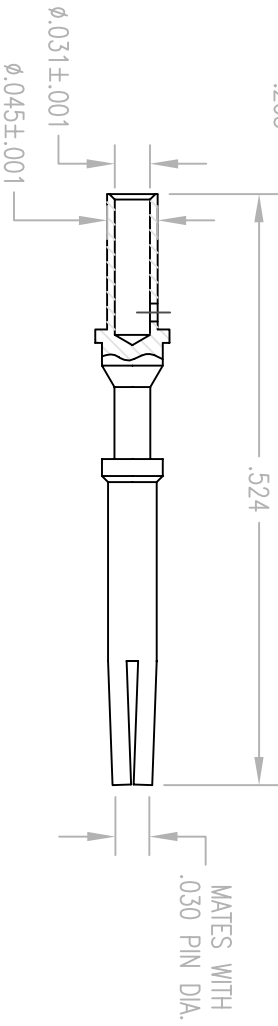
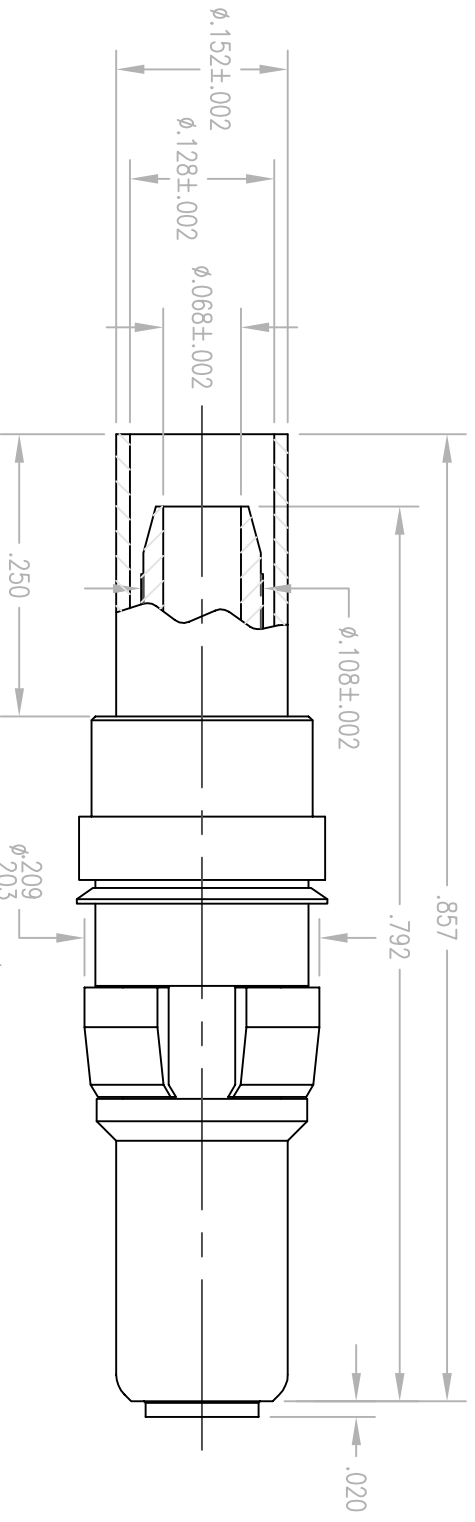

- NOTES:
1. MATERIAL:
CLIP RING: BERYLLIUM COPPER, PER ASTM B194
CENTER CONTACT AND FERRULE: COPPER ALLOY
INSULATOR: TEFLON, ASTM D1710
SPRING WASHER: PHOSPHOR BRONZE, PER ASTM B103
BODY: BRASS PER ASTM B16
 2. FINISH:
BODY & CENTER CONTACT: GOLD, .000030 MIN PER MIL-G-45204 OVER
.000050 MIN, NICKEL PER QQ-N-290
FERRULE & WASHER: .0000050 GOLD OVER NICKEL
CLIP RING: NICKEL PLATE, PER QQ-N-290

3. ELECTRICAL:
VSWR: 1.35 MAX.
FREQUENCY RANGE: 0 - 1500MHZ
DIELECTRIC WITHSTANDING VOLTAGE: 1000 VRMS.
4. FOR USE WITH RG-316 OR EQUIVALENT CABLE.
5. CRIMP FERRULE USING .128 HEX. DIE.
6. FOR CABLING PROCEDURE USE CAP 9-07 WITH TRIMMING DIMENSIONS SHOWN.

PER ASME Y14.5M-1994 UNLESS OTHERWISE SPECIFIED: TOLERANCES ARE IN INCHES (MM) DECIMALS .XX ± .01/0.254 FRACTIONS .XXX ± .005/0.127 ANGLES ± Z° SCALE: 6:1		LITTON Winchester/Reticon 400 Park Road Westport, Connecticut 06786	
CUSTOMER DRAWING		TITLE RDM PLUG	
DRAWN KJT	DATE 03/07/01	CHECKED	DATE
APPROVED	DATE	APPROVED	DATE
A	290-910-0630G	SFT.	1 OF 1
		REV.	A