

PRODUCT NUMBER
SEE TABLE

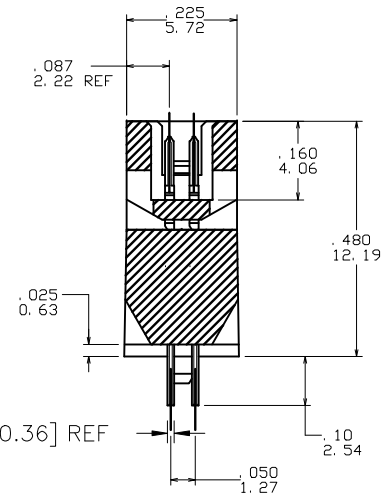

SECTION Z-Z
ROTATED 90° CW

mat'l. code		surface		tolerance		projection		product family	
-		ISO 1302		ISO 406		ISO 1502		RIBCAGE	
tolerances unless otherwise specified		angles		linear		INCH/MM		title	
K V61605 DLW 12/14/00		.XX±.01/0.3		.XXX±.005/0.13		3:1		SCOOTER 1 ASSEMBLY	
L V02780 DLW 3/9/01		0'±2'		.XXXX±.0020/0.05				dwg no	
M M05-0123 ERE 06/07/05								87434	
N M06-0225 ERE 06/12/06		dr		J. SHREINER 12/14/90				sheet 1 of 2 size	
P M06-0370 MHT 9/26/06		engr		C. TREXLER 12/14/90				A3	
R M09-0058 CMR 4/06/09		chr		C. TREXLER 12/14/90				type	
		appd		C. TREXLER 12/14/90				Product Customer Drawing	
sheet		revision		R R					
index		sheet		1 2					

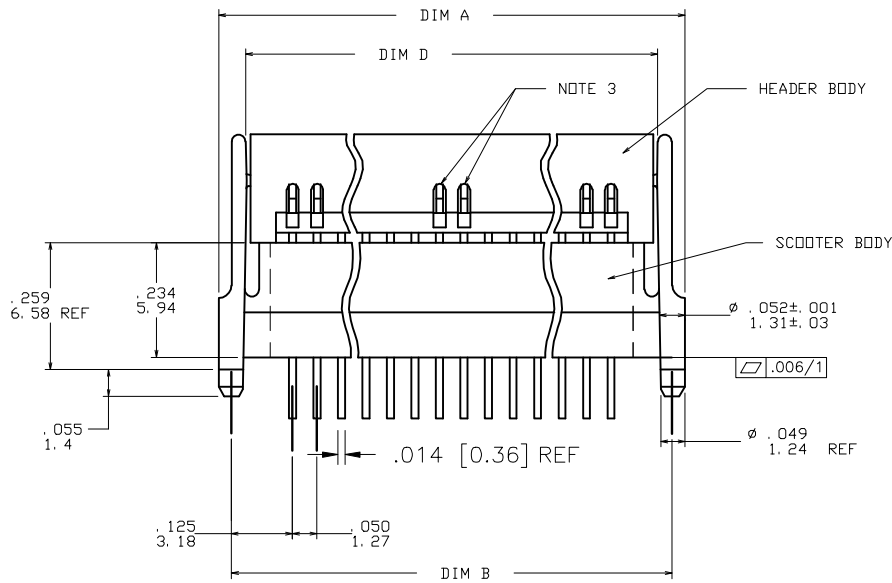
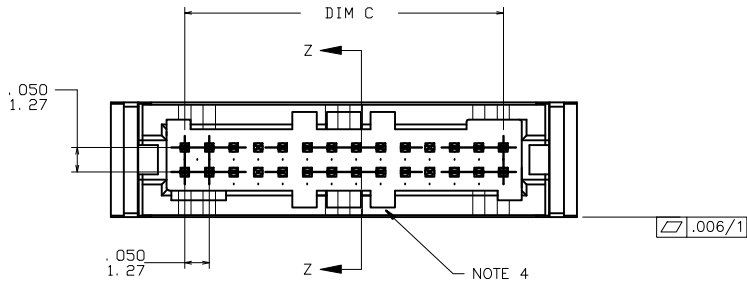

Copyright FCJ

PRODUCT NUMBER	NO OF POS	DIM A	DIM B	DIM C	DIM D
NOTE 5					
87434-115	30	1.000/25.40	.950/24.13	.700/17.78	.890/22.61
-120	40	1.250/31.75	1.200/30.48	.950/24.13	1.140/28.96
-125	50	1.500/38.10	1.450/36.83	1.200/30.48	1.390/35.31
-130	60	1.750/44.45	1.700/43.18	1.450/36.83	1.640/41.66
-135	70	2.000/50.80	1.950/49.53	1.700/43.18	1.890/48.01
-140	80	2.250/57.15	2.200/55.88	1.950/49.53	2.140/54.36
-145	90	2.500/63.50	2.450/62.23	2.200/55.88	2.390/60.71
87434-150	100	2.750/69.85	2.700/68.58	2.450/62.23	2.640/67.06

NOTES:

1. TERMINAL PLATING:
CONTACT ZONES.
30u"/.76u MIN HARD Au OVER 50u"/1.27u Ni ON CONTACT ZONES.
100u"/2.54u MIN Sn OVER 50u"/1.27u Ni IN SOLDERING ZONES.
2. HEADER BODY: GLASS FILLED THERMOPLASTIC FLAME
RETARDANT PER UL 94 V-0.
COLOR: NATURAL
HEAT DEFLECTION TEMP - 500°F
- SCOOTER BODY: GLASS FILLED THERMOPLASTIC FLAME
RETARDANT PER UL 94V-0.
COLOR: NATURAL
HEAT DEFLECTION TEMP @ 264 PSI - 466°F(241°C)
PER ASTM TEST NO D64B.
3. ADDITIONAL CORING IN CENTER MANUFACTURING OPTION.
4. MOLDING FLOW RESTRICTERS QUANTITY AND LOCATION IS MANUFACTURING OPTION.
5. ADD "LF" SUFFIX AT THE END OF PART NUMBER FOR LEAD FREE OPTION.
6. THIS PRODUCT MEETS EUROPEAN UNION DIRECTIVES AND OTHER COUNTRY REGULATION AS DESCRIBED IN GS-22-008.
7. THE HOUSING WILL WITHSTAND EXPOSURE TO 260°C PEAK TEMPERATURE FOR 15 SECONDS IN A WAVE SOLDER APPLICATION WITH A 1.5mm MINIMUM THICK CIRCUIT BOARD. SEE APPLICATION NOTES/PROCEDURES IF THEY ARE AVAILABLE.

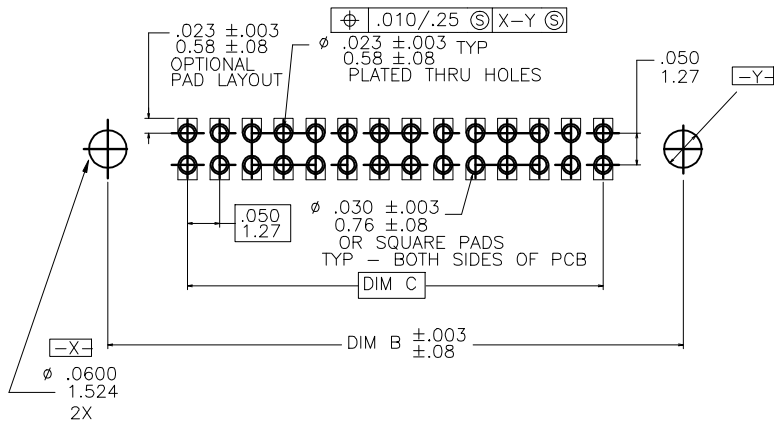

RECOMMENDED P.C.B. LAYOUT
SCALE 4/1

mat'l. code	surface	tolerance	projection	product family
-	ISO 1302	ISO 406	ISO 1101	RIBCAGE
ltr	ecp no	dr	date	title
R				SCOOTER 1 ASSEMBLY
	angles	linear	linear	INCH/MM
	0'±2'	.XX±.01/0.3	.XXX±.005/0.13	scale 3:1
		.XXXX±.0020/0.05		
	dr	J. SHREINER	12/14/90	dwg no
	engr	C. TREXLER	12/14/90	sheet 2 of 2
	chr	C. TREXLER	12/14/90	size
	appd	C. TREXLER	12/14/90	A3
sheet	revision			type
index	sheet			Product Customer Drawing