

Micro-Power Voltage Detector with Manual Reset

General Description

The RT9834 is a micro-power voltage detector with deglitched manual reset input supervising the power supply voltage level for microprocessors (μ P) or digital systems. It provides internally fixed threshold levels with 0.1V per step ranging from 1.2V to 5V, which covers most digital applications. It features low supply current of 3 μ A. The RT9834 performs supervisory function by sending out a reset signal whenever the V_{DD} voltage falls below a preset threshold level. This reset signal will last the whole period before V_{DD} recovering. Once V_{DD} recovered upcrossing the threshold level, the reset signal will be released after a certain delay time. To pull reset signal low manually, just pull the manual reset input (MR) below the specified V_{IL} level. The RT9834 is available in the SC-82 and SOT-143 packages.

Marking Information

For marking information, contact our sales representative directly or through a Richtek distributor located in your area.

Features

- Internally Fixed Threshold 1.2V to 5V in 0.1V Step
- High Accuracy $\pm 1.5\%$
- Low Supply Current 3 μ A
- No External Components Required
- Quick Reset within 20 μ s
- Built-in Recovery Delay : 0ms, 55ms, 220ms, 450ms Options
- 800ns Glitch Immunity of Manual Reset Input
- Low Functional Supply Voltage 0.9V
- CMOS Push-Pull Output
- Small SC-82 and SOT-143 Packages
- RoHS Compliant and Halogen Free

Applications

- Computers
- Controllers
- Intelligent Instruments
- Critical μ P and μ C Power Monitoring
- Portable/Battery-Powered Equipment

Simplified Application Circuit

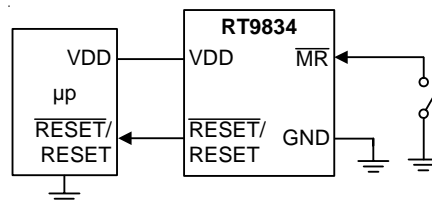

Ordering Information

RT9834 □-□□□□

- Package Type
 - H : SOT-143
 - Y : SC-82
- Lead Plating System
 - G : Green (Halogen Free and Pb Free)
- Threshold Voltage
 - 12 : 1.2V
 - 13 : 1.3V
 - ⋮
 - 49 : 4.9V
 - 50 : 5.0V
- Reset Active Timeout Period
 - A = 0ms ($\overline{\text{RESET}}$)
 - B = 55ms ($\overline{\text{RESET}}$)
 - C = 220ms ($\overline{\text{RESET}}$)
 - D = 450ms ($\overline{\text{RESET}}$)
 - E = 0ms (RESET)
 - F = 55ms (RESET)
 - G = 220ms (RESET)
 - H = 450ms (RESET)

Pin Configurations

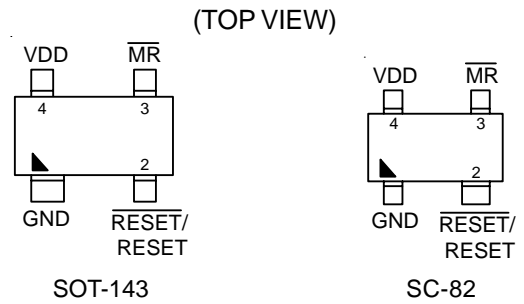

Note :

Richtek products are :

- ▶ RoHS compliant and compatible with the current requirements of IPC/JEDEC J-STD-020.
- ▶ Suitable for use in SnPb or Pb-free soldering processes.

Functional Pin Description

Pin No.	Pin Name	Pin Function
1	GND	Ground.
2	$\overline{\text{RESET}}$	Active Low Push-Pull Reset Output.
	RESET	Active High Push-Pull Reset Output.
3	$\overline{\text{MR}}$	Manual Reset.
4	VDD	Power.

Function Block Diagram

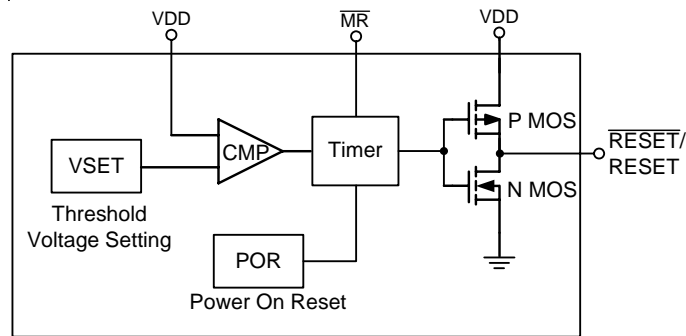

Operation

When VDD is lower than threshold voltage set by VSET circuit, the RESET output becomes high. If VDD remains higher than the threshold voltage with a hysteresis voltage, Timer will be active. After a specific delay time, the RESET output becomes low. There is an internal pull-high resistor connected to the MR pin. MR resets the RT9834 only when it is pulled low. When MR releases and waits for a delay time, output returns to its normal state related to VDD. The RESET pin is a Pull-Push output, and it will pull the output high to VDD, low to Ground. Adding a pull-high resistor tied to any power which higher than VDD is forbidden.

Timer

The Timer provides four kinds of delay time options including 0ms, 55ms, 220ms, and 450ms.

VSET

The VSET generates a fixed threshold voltage.

CMP

Voltage Comparator which compares the voltage difference between threshold voltage and VDD.

POR

Power on reset. It will set all digital logic to the right state when power on.

Absolute Maximum Ratings (Note 1)

- Terminal Voltage (with Respect to GND)
 - V_{DD} ----- -0.3V to 6V
- All Other Inputs ----- -0.3V to ($V_{DD} + 0.3V$)
- Input Current, I_{VDD} ----- 20mA
- Power Dissipation, P_D @ $T_A = 25^\circ C$
 - SOT-143 ----- 0.44W
 - SC-82 ----- 0.29W
- Package Thermal Resistance (Note 2)
 - SOT-143, θ_{JA} ----- 228.1°C/W
 - SC-82, θ_{JA} ----- 345.6°C/W
- Lead Temperature (Soldering, 10sec.) ----- 260°C
- Storage Temperature Range ----- -65°C to 125°C
- ESD Susceptibility (Note 3)
 - HBM (Human Body Model) ----- 2kV

Recommended Operating Conditions (Note 4)

- Junction Temperature Range ----- -40°C to 125°C
- Ambient Temperature Range ----- -40°C to 85°C

Electrical Characteristics

($V_{DD} = 3V$, $T_A = 25^\circ C$, unless otherwise specified)

Parameter	Symbol	Test Conditions	Min	Typ	Max	Unit	
Operating V_{DD} (V_{OUT}) Range	V_{DD}	RT9834A/B/C/D	0.9	--	6	V	
		RT9834E/F/G/H	1.1	--	6		
Supply Current	I_{DD}	$V_{TH} = 3V$, $V_{DD} = 4.5V$	--	3	8	μA	
Reset Threshold	V_{TH}		--	1.2 to 5	--	V	
Threshold Voltage Accuracy	ΔV_{TH}		-1.5	--	1.5	%	
Threshold Voltage Hysteresis	V_{HYS}		--	$0.01 V_{TH}$	--	V	
V_{DD} Drop to Reset Delay	t_{RD}	Drop = $V_{TH} - 125mV$	--	20	--	μs	
Reset Active Timeout Period	RT9834A/E	t_{RP}	$V_{DD} \geq 1.02 \times V_{TH}$	--	0	--	ms
	RT9834B/F			35	55	75	
	RT9834C/G			143	220	297	
	RT9834D/H			292	450	608	
RESET Output Voltage Low	V_{OL}	$V_{DD} < V_{TH(MIN)}$, $I_{SINK} = 3.5mA$, $V_{TH} \geq 3V$	--	--	0.4	V	
		$V_{DD} < V_{TH(MIN)}$, $I_{SINK} = 1.2mA$, $V_{TH} \geq 1.8V$	--	--	0.3		
		$V_{TH(MIN)} > V_{DD} > 1V$, $I_{SINK} = 0.5mA$	--	--	0.3		

Parameter		Symbol	Test Conditions	Min	Typ	Max	Unit
RESET Output Voltage High		V_{OH}	$V_{DD} > V_{TH(MAX)}$, $I_{SOURCE} = 800\mu A$, $V_{TH} \geq 3V$	$V_{DD} - 1.5$	--	--	V
			$V_{DD} > V_{TH(MAX)}$, $I_{SOURCE} = 500\mu A$, $V_{TH} \geq 1.8V$	$0.8 V_{DD}$	--	--	
			$V_{DD} > V_{TH(MAX)}$, $I_{SOURCE} = 200\mu A$, $V_{TH} \geq 1.1V$	$0.8 V_{DD}$	--	--	
RESET Output Voltage Low		V_{OL}	$V_{DD} > V_{TH(MAX)}$, $I_{SINK} = 3.5mA$, $V_{TH} \geq 3V$	--	--	0.4	V
			$V_{DD} > V_{TH(MAX)}$, $I_{SINK} = 1.2mA$, $V_{TH} \geq 1.8V$	--	--	0.3	
			$V_{DD} > V_{TH(MAX)}$, $I_{SINK} = 0.5mA$, $V_{TH} \geq 1.2V$	--	--	0.3	
RESET Output Voltage High		V_{OH}	$1.1V < V_{DD} < V_{TH(MIN)}$, $I_{SOURCE} = 200\mu A$	$0.8 V_{DD}$	--	--	V
			$1.8V < V_{DD} < V_{TH(MIN)}$, $I_{SOURCE} = 500\mu A$	$0.8 V_{DD}$	--	--	
			$3V < V_{DD} < V_{TH(MIN)}$, $I_{SOURCE} = 800\mu A$	$V_{DD} - 1.5$	--	--	
\overline{MR} Active Timeout Period	RT9834A/E	t_{MR}		--	0	--	ms
	RT9834B/F			35	55	75	
	RT9834C/G			143	220	297	
	RT9834D/H			292	450	608	
\overline{MR} Input Voltage Threshold	Logic-High	$V_{\overline{MR_H}}$	$V_{DD} > V_{TH(MAX)}$	$0.75 \times V_{DD}$	--	V_{DD}	V
	Logic-Low	$V_{\overline{MR_L}}$	$V_{DD} > V_{TH(MAX)}$	--	--	$0.25 \times V_{DD}$	

Note 1. Stresses beyond those listed “Absolute Maximum Ratings” may cause permanent damage to the device. These are stress ratings only, and functional operation of the device at these or any other conditions beyond those indicated in the operational sections of the specifications is not implied. Exposure to absolute maximum rating conditions may affect device reliability.

Note 2. θ_{JA} is measured at $T_A = 25^\circ C$ on a high effective thermal conductivity four-layer test board per JEDEC 51-7.

Note 3. Devices are ESD sensitive. Handling precaution is recommended.

Note 4. The device is not guaranteed to function outside its operating conditions.

Typical Application Circuit

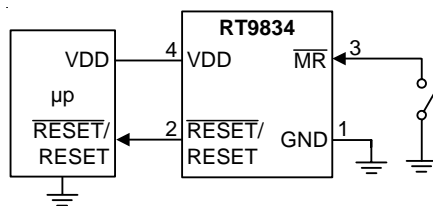

Typical Operating Characteristics

Nch Driver Output Current vs. V_{DS}

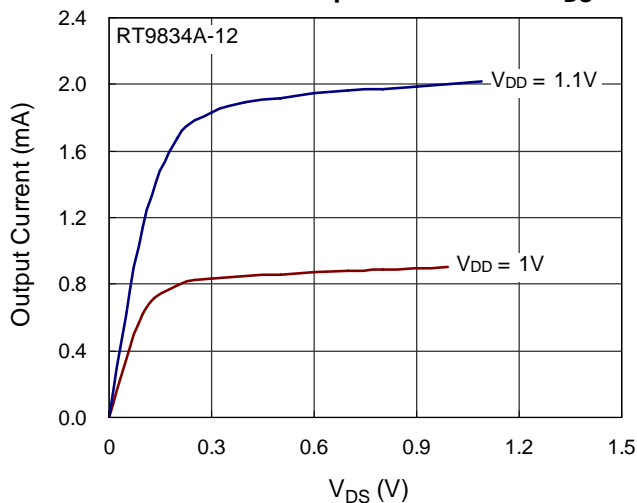

Nch Driver Output Current vs. V_{DS}

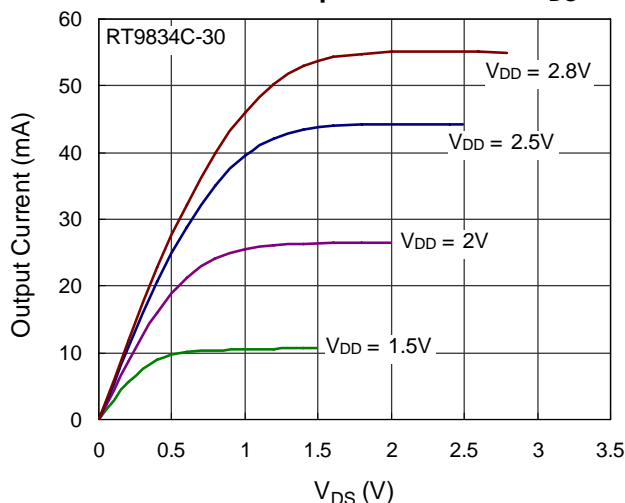

Nch Driver Output Current vs. V_{DS}

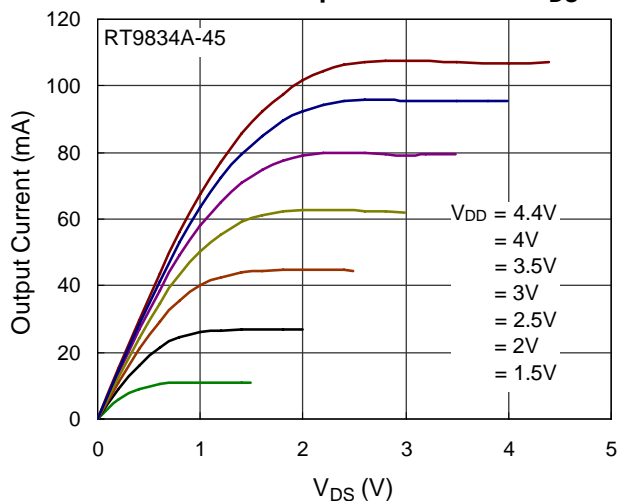

Output Voltage vs. Input Voltage

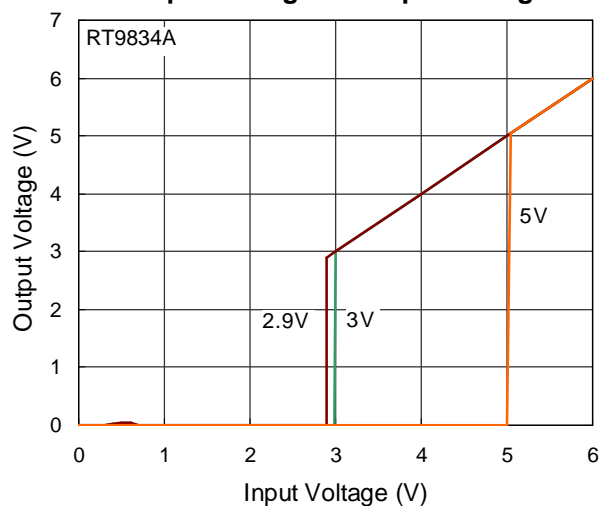

Supply Current vs. Input Voltage

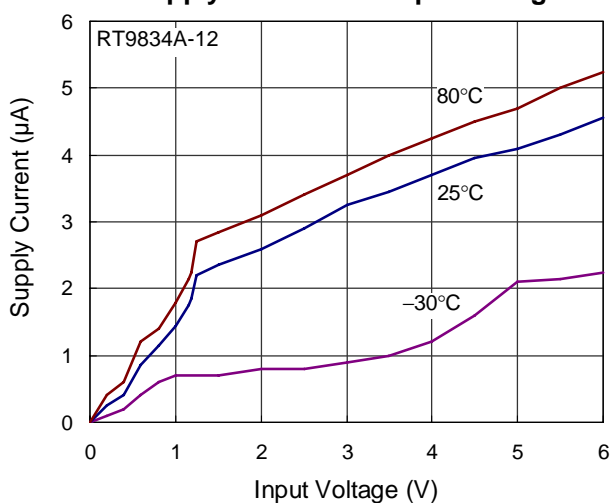

Supply Current vs. Input Voltage

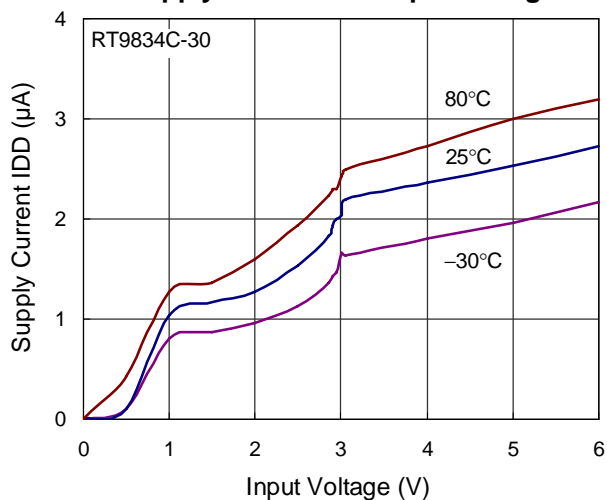

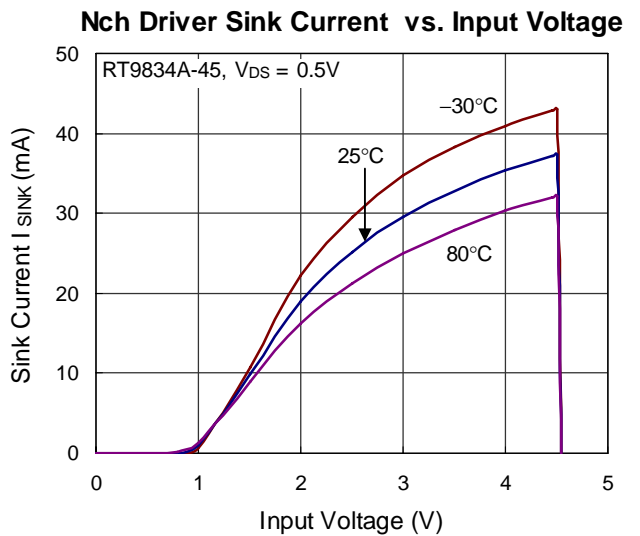
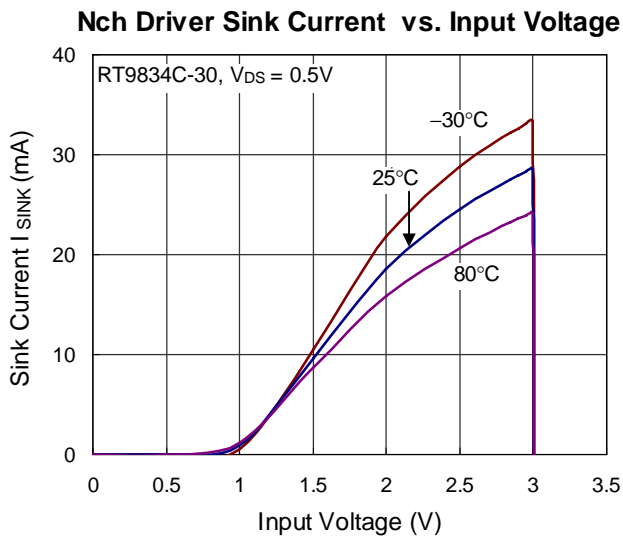
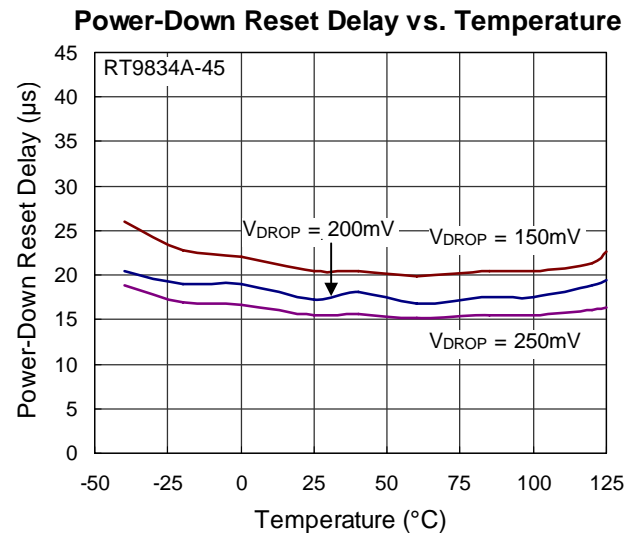
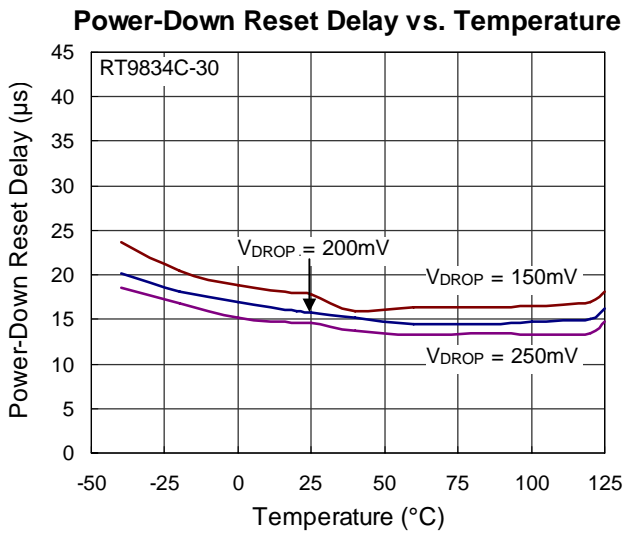
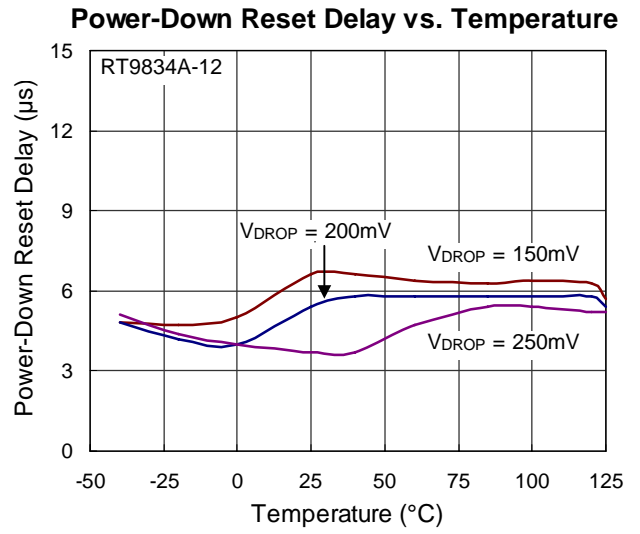
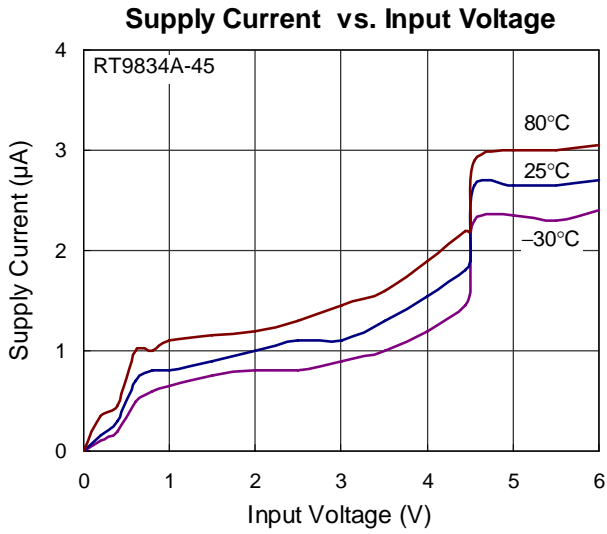

Reset Threshold Deviation vs. Temperature

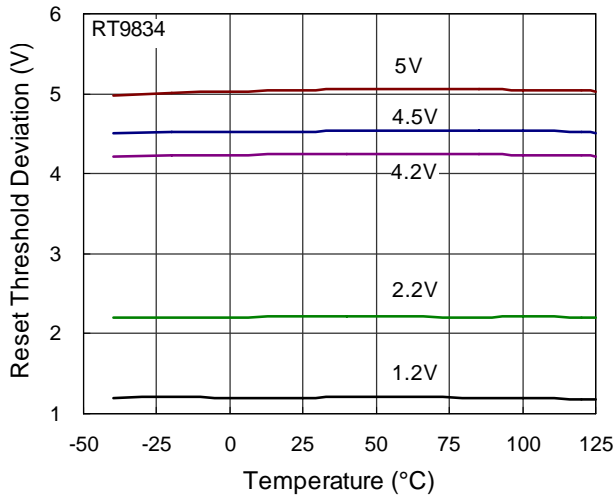

Pch Driver Output Current vs. Input Voltage

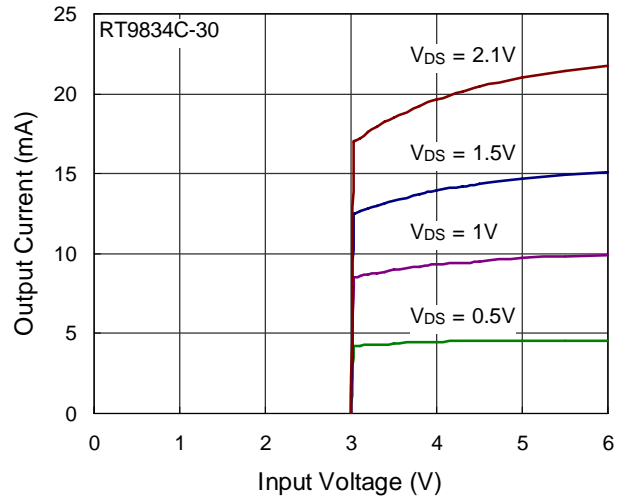

Power-Up Reset Timeout vs. Temperature

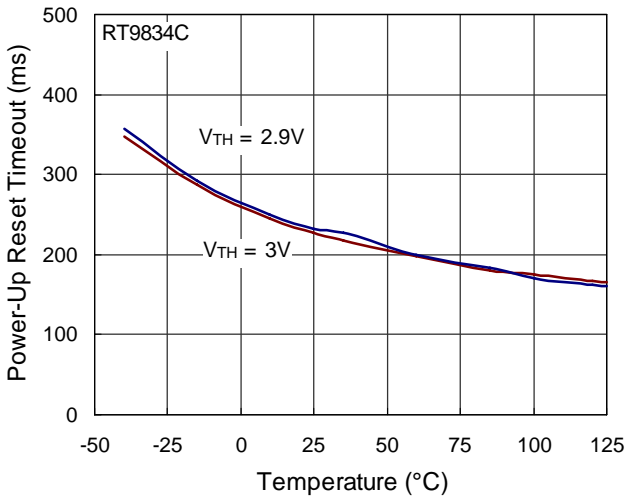

Power-Up Reset Timeout vs. Temperature

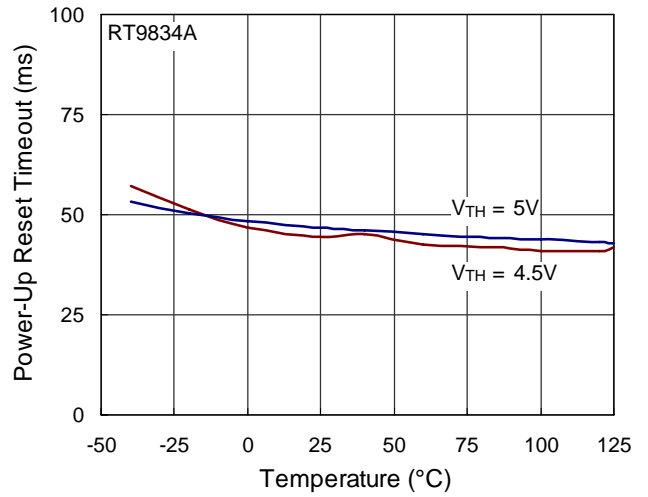

Output Delay Time vs. Load Capacitance

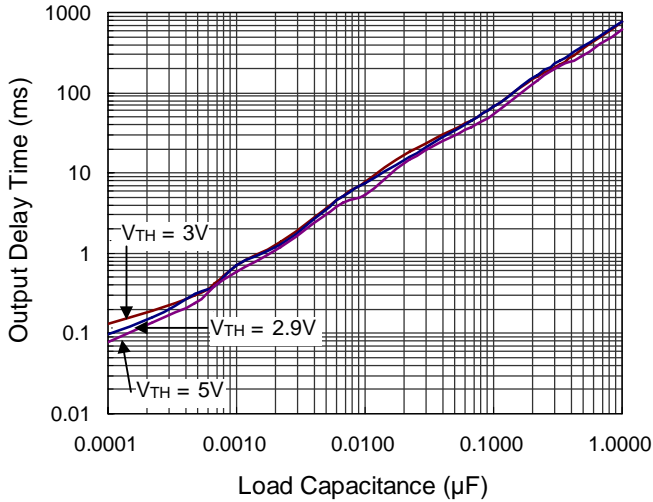

Nch Driver Output Current vs. VDS

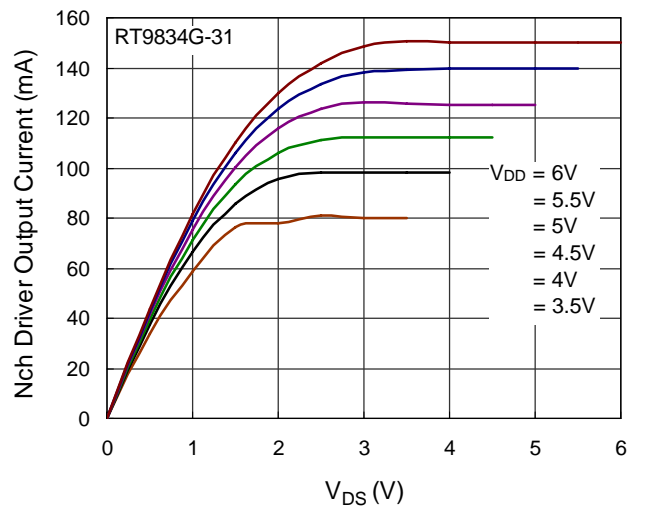

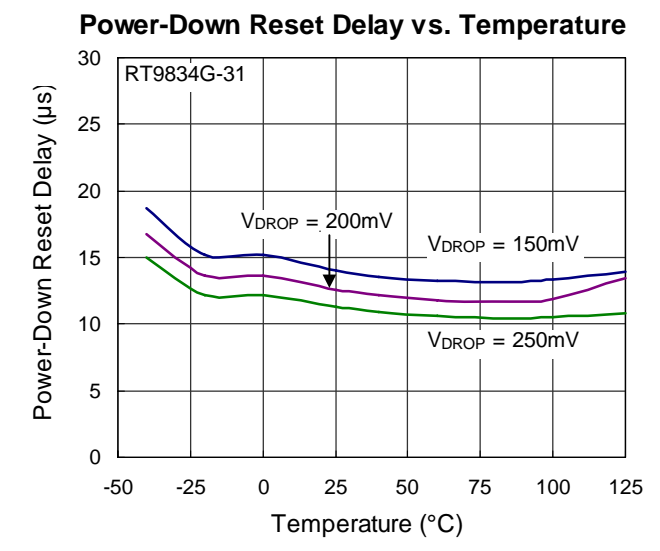
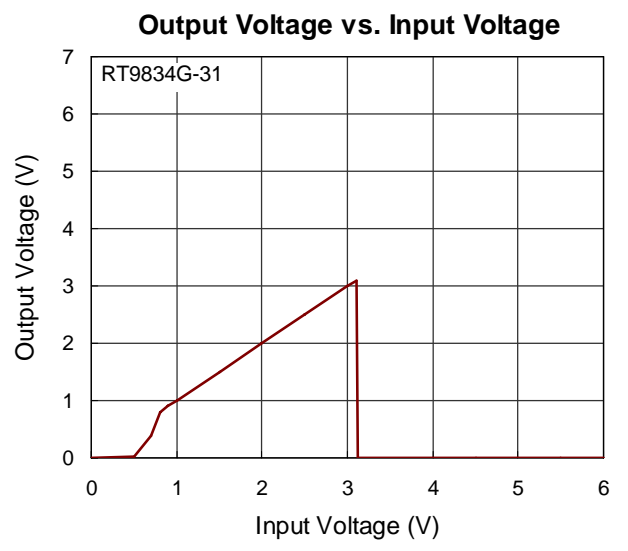
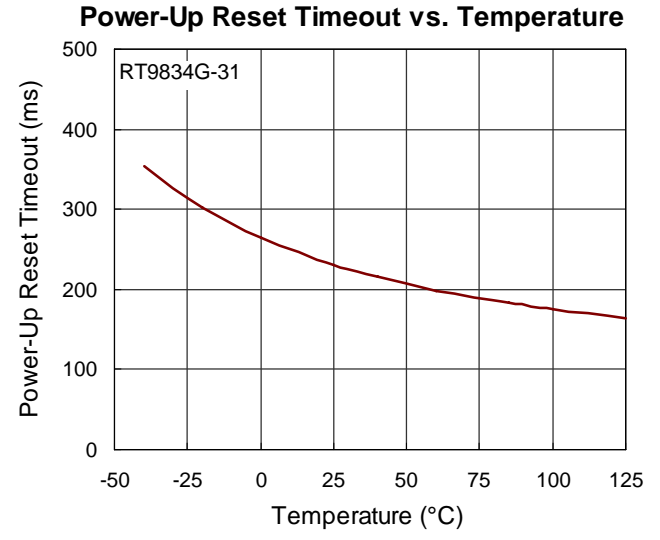
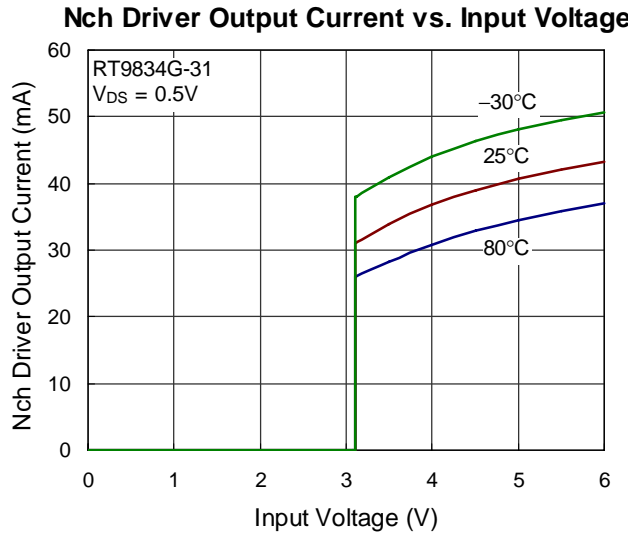

Application Information

Benefits of Highly Accurate Reset Threshold

Most μP supervisor ICs have reset threshold voltages between 1% and 1.5% below the value of nominal supply voltages. This ensures a reset will not occur within 1% of the nominal supply, but will occur when the supply is 1.5% below nominal.

Thermal Considerations

For continuous operation, do not exceed absolute maximum junction temperature. The maximum power dissipation depends on the thermal resistance of the IC package, PCB layout, rate of surrounding airflow, and difference between junction and ambient temperature. The maximum power dissipation can be calculated by the following formula :

$$P_{D(MAX)} = (T_{J(MAX)} - T_A) / \theta_{JA}$$

where $T_{J(MAX)}$ is the maximum junction temperature, T_A is the ambient temperature, and θ_{JA} is the junction to ambient thermal resistance.

For recommended operating condition specifications, the maximum junction temperature is 125°C. The junction to ambient thermal resistance, θ_{JA} , is layout dependent. For SOT-143 package, the thermal resistance, θ_{JA} , is 228.1°C/W on a standard JEDEC 51-7 four-layer thermal test board. SC-82 package, the thermal resistance, θ_{JA} , is 345.6°C/W on a standard JEDEC 51-7 four-layer thermal test board. The maximum power dissipation at $T_A = 25^\circ\text{C}$ can be calculated by the following formula :

$$P_{D(MAX)} = (125^\circ\text{C} - 25^\circ\text{C}) / (228.1^\circ\text{C/W}) = 0.44\text{W for SOT-143 package}$$

$$P_{D(MAX)} = (125^\circ\text{C} - 25^\circ\text{C}) / (345.6^\circ\text{C/W}) = 0.29\text{W for SC-82 package}$$

The maximum power dissipation depends on the operating ambient temperature for fixed $T_{J(MAX)}$ and thermal resistance, θ_{JA} . The derating curve in Figure 1 allows the designer to see the effect of rising ambient temperature on the maximum power dissipation.

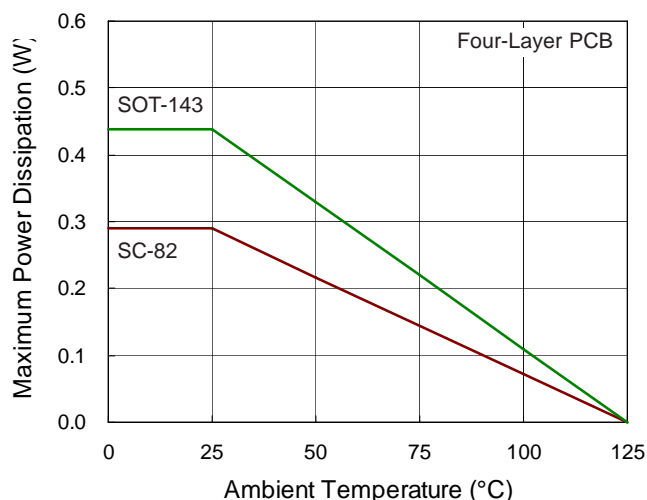
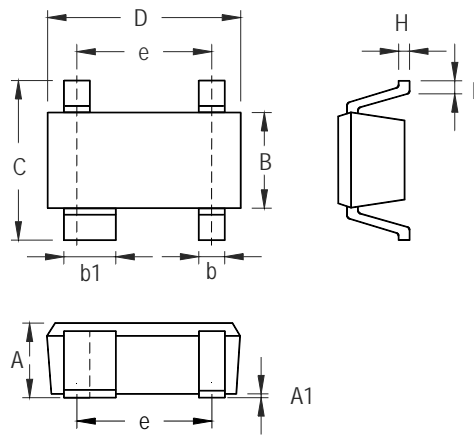

Figure 1. Derating Curve of Maximum Power Dissipation

Outline Dimension



Symbol	Dimensions In Millimeters		Dimensions In Inches	
	Min	Max	Min	Max
A	0.800	1.200	0.031	0.047
A1	0.050	0.150	0.002	0.006
B	1.200	1.400	0.047	0.055
b	0.300	0.520	0.012	0.020
b1	0.760	0.920	0.030	0.036
C	2.100	2.640	0.083	0.104
D	2.800	3.040	0.110	0.120
e	1.900		0.075	
H	0.080	0.150	0.003	0.006
L	0.210	0.410	0.008	0.016

SOT-143 Surface Mount Package

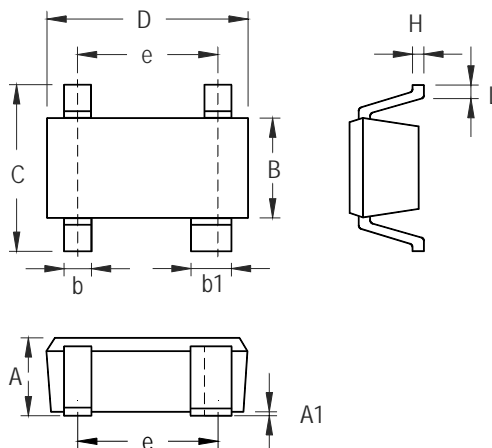

Symbol	Dimensions In Millimeters		Dimensions In Inches	
	Min	Max	Min	Max
A	0.800	1.100	0.031	0.043
A1	0.000	0.100	0.000	0.004
B	1.150	1.350	0.045	0.053
b	0.150	0.400	0.006	0.016
b1	0.350	0.500	0.014	0.020
C	1.800	2.450	0.071	0.096
D	1.800	2.200	0.071	0.087
e	1.300		0.051	
H	0.080	0.260	0.003	0.010
L	0.200	0.460	0.008	0.018

SC-82 Surface Mount Package

Richtek Technology Corporation

5F, No. 20, Taiyuen Street, Chupei City
 Hsinchu, Taiwan, R.O.C.
 Tel: (8863)5526789

Richtek products are sold by description only. Richtek reserves the right to change the circuitry and/or specifications without notice at any time. Customers should obtain the latest relevant information and data sheets before placing orders and should verify that such information is current and complete. Richtek cannot assume responsibility for use of any circuitry other than circuitry entirely embodied in a Richtek product. Information furnished by Richtek is believed to be accurate and reliable. However, no responsibility is assumed by Richtek or its subsidiaries for its use; nor for any infringements of patents or other rights of third parties which may result from its use. No license is granted by implication or otherwise under any patent or patent rights of Richtek or its subsidiaries.