

A. Electrical Specifications: (Ta=25°C, Zo = 75Ω, Pin = 0 dBm)

Spec Item	dB	Frequency Range
Insertion Loss (Pin 6~1)	3.1dB Max.	5 ~ 200MHz.
Insertion Loss (Pin 6~3)	3.6dB Max.	5 ~ 200MHz.
Input Return Loss (Pin 6)	3.0 dB Min.	5 ~ 200MHz.
Amplitude Balance (Normal 0dB)	± 1.4dB Max.	5 ~ 200MHz.
Phase Balance (Normal 180°)	± 9.0° Max.	5 ~ 200MHz.

B. Dimensions: mm (Inch)

Series	a	b	c	d	e	f	g	h	i	j
SBT203A-41	6.6 (0.260)	6.8 (0.268)	2.0 (0.079)	2.0 (0.079)	4.7 (0.185)	0.6 (0.024)	1.2 (0.047)	4.0 (0.157)	7.4 (0.291)	4.0 (0.157)
Tol.	Max.	Max.	±0.3 (0.012)	±0.3 (0.012)	Max.	±0.3 (0.012)	Typ.	Typ.	Typ.	Typ.

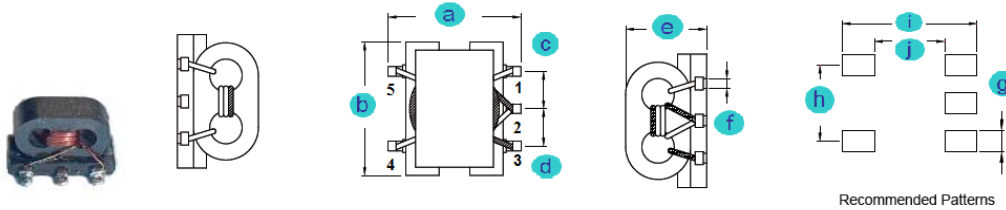

C. Test Equivalent Circuit:

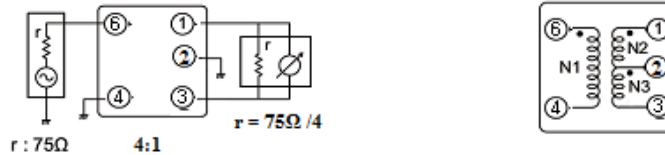

D. Features:

- 4:1 Impedance ratio.
- Surface mounts part.
- 260 °C reflow compatible..
- RoHS compliant.
- Tape and Reel packaging.
- MSL: Level 1.

E. Characteristic Curve:

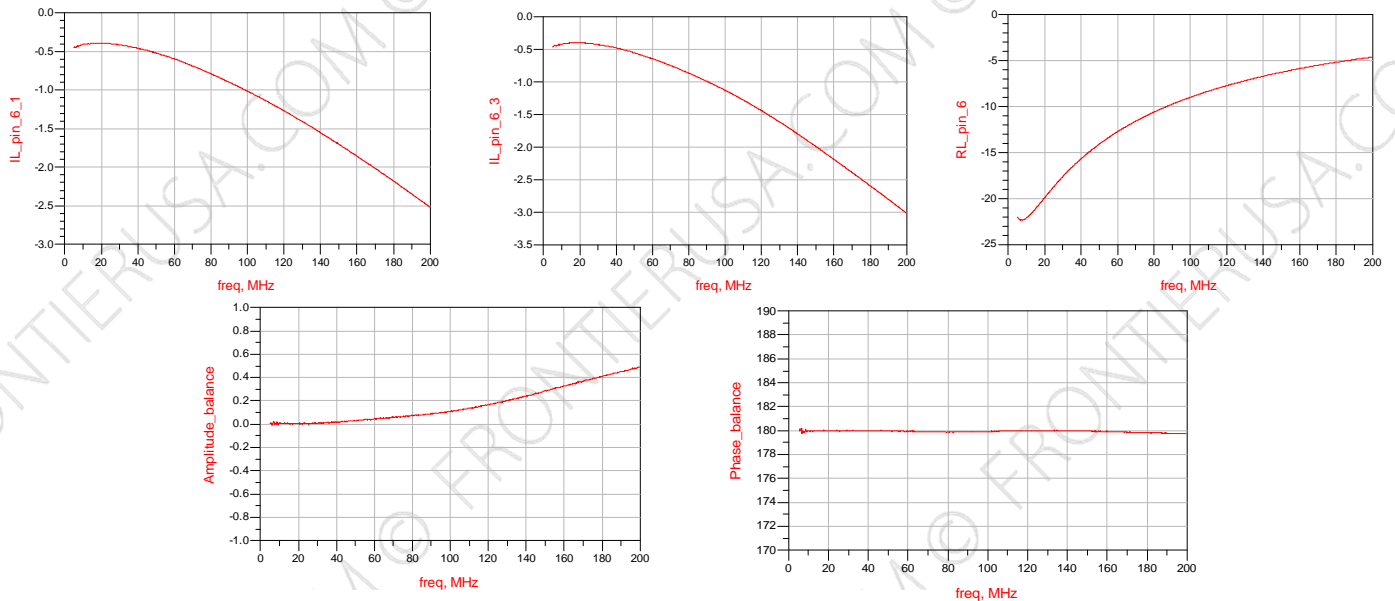

F. Supplementary Information:

1. Packaging Information

CARRIER TAPE REELS

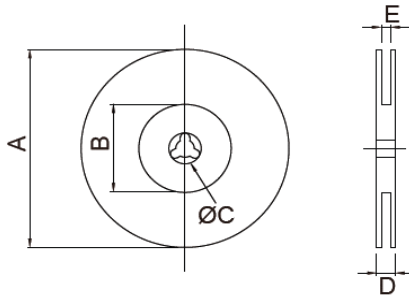

TAPE DIMENSIONS (mm)

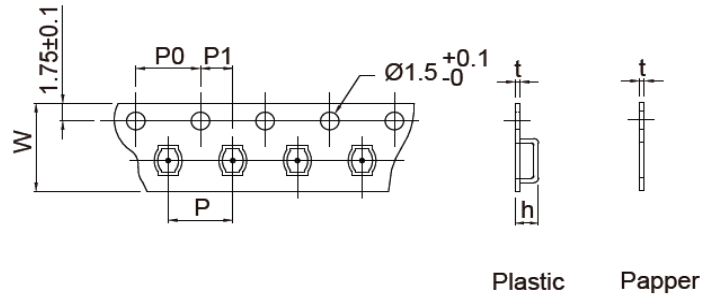

Plastic Paper

SMD Balun Transformers

Series P/N	Reel dimensions (mm)					Tape dimensions (mm)							Parts per reel		Quantity per	
	A	B	C	D	E	W	P	P0	P1	h	t	7"	13"	Box	Carton	
SBT203A-41	330	100	13	22	16.5	16	12	4	2	---	0.35	---	1,000	2,000	12,000	

2. RoHS Reflow Solder Profile

Typical RoHS Reflow Profile

