

1. PART NO. EXPRESSION :

SPC 3012 FT 3R3 NZ F -□□
 (a) (b) (c)(d) (e) (f)(g)(h) (i)

- (a) Series code
- (b) Dimension code
- (c) Powder coating type
- (d) Taping package

- (e) Inductance code : 3R3= 3.3uH
- (f) Tolerance code : M=±20%, N=±30%
- (g) Z : Standard Part
- (h) F : RoHS Compliant
- (i) 10: Standard
11 ~ 99 : Internal control number

2. CONFIGURATION & DIMENSIONS :

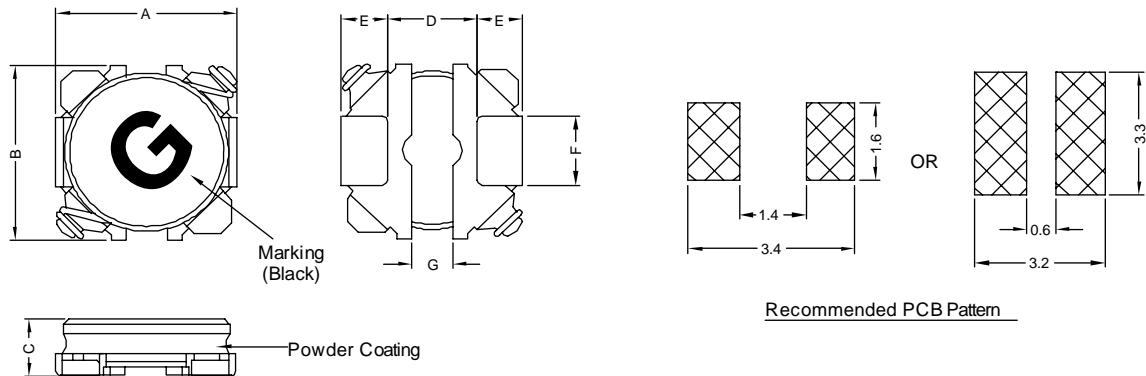

Unit:m/m

A	B	C	D	E	F	G
3.0±0.2	2.9±0.2	1.2 Max.	1.5± 0.15	0.76±0.1	1.2± 0.15	0.7±0.1

3. MATERIALS :

- (a) Core
- (b) Wire
- (c) Clip
- (d) Epoxy Resin
- (e) Powder Coating

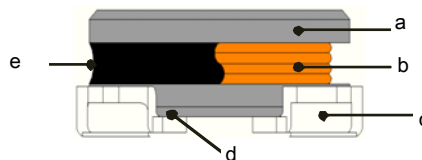

Exposed wire tolerance limit of coating resin part on product side.

1. Width direction (dimension a) : Acceptable when $a \leq w/2$
Nonconforming when $a > w/2$
2. Length direction (dimension b) : Dimension b is not specified.
3. The total expose wire area of each side should not be more than 50% of the coating resin area.

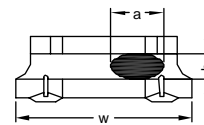

RoHS Compliant

NOTE : Specifications subject to change without notice. Please check our website for latest information.

16.10.2014

4. GENERAL SPECIFICATION :

- a) ISAT : Based on inductance change ($\Delta L/L_0 : \leq -30\%$) @ ambient temp. 25°C
- b) IRMS : Based on temperature rise ($\Delta T : 40^\circ\text{C TYP.}$)
- c) Operate temperature range : -40°C to $+125^\circ\text{C}$ (include self temp. rise)
- d) Storage temperature range (on board) : -40°C to $+105^\circ\text{C}$
- e) Storage condition (component in its packaging)
 - i) Temperature : -10 to 40°C
 - ii) Humidity : 60%

5. ELECTRICAL CHARACTERISTICS :

Part No.	Inductance (uH)	Tolerance	Test Frequency (Hz)	Resistance RDC (Ω) $\pm 20\%$	Rated DC Current		Marking
					ISAT (A)	IRMS (A)	
SPC3012FTR47□ZF	0.47	N	100kHz,0.1V / 1MHz,0.1V	32m	2.80	2.05	6
SPC3012FTR56□ZF	0.56	N	100kHz,0.1V / 1MHz,0.1V	38m	2.50	1.95	7
SPC3012FTR68□ZF	0.68	N	100kHz,0.1V / 1MHz,0.1V	44m	2.10	1.85	8
SPC3012FT1R0□ZF	1.0	N	100kHz,0.1V / 1MHz,0.1V	53m	1.90	1.70	A
SPC3012FT1R2□ZF	1.2	N	100kHz,0.1V / 1MHz,0.1V	53m	1.90	1.70	B
SPC3012FT1R5□ZF	1.5	N	100kHz,0.1V / 1MHz,0.1V	67m	1.70	1.55	C
SPC3012FT2R2□ZF	2.2	N,M	100kHz,0.1V / 1MHz,0.1V	93m	1.30	1.40	E
SPC3012FT2R7□ZF	2.7	N	100kHz,0.1V / 1MHz,0.1V	0.12	1.20	1.25	F
SPC3012FT3R3□ZF	3.3	N	100kHz,0.1V / 1MHz,0.1V	0.13	1.10	1.20	G
SPC3012FT4R7□ZF	4.7	M	100kHz,0.1V / 1MHz,0.1V	0.19	0.95	0.95	I
SPC3012FT5R6□ZF	5.6	M	100kHz,0.1V / 1MHz,0.1V	0.22	0.83	0.85	J
SPC3012FT6R8□ZF	6.8	M	100kHz,0.1V / 1MHz,0.1V	0.26	0.80	0.80	K
SPC3012FT100□ZF	10	M	100kHz,0.1V / 1MHz,0.1V	0.36	0.65	0.67	M
SPC3012FT150□ZF	15	M	100kHz,0.1V / 1MHz,0.1V	0.53	0.55	0.56	O
SPC3012FT220□ZF	22	M	100kHz,0.1V / 1MHz,0.1V	0.79	0.45	0.41	Q
SPC3012FT330□ZF	33	M	100kHz,0.1V / 1MHz,0.1V	1.14	0.36	0.31	S
SPC3012FT470□ZF	47	M	100kHz,0.1V / 1MHz,0.1V	1.53	0.30	0.22	U

Tolerance code □ : M= $\pm 20\%$, N= $\pm 30\%$



RoHS Compliant

NOTE : Specifications subject to change without notice. Please check our website for latest information.

16.10.2014



SUPERWORLD ELECTRONICS (S) PTE LTD

6. ELECTRICAL CHARACTERISTICS :

6-1. INDUCTANCE / TEMPERATURE vs. DC CURRENT

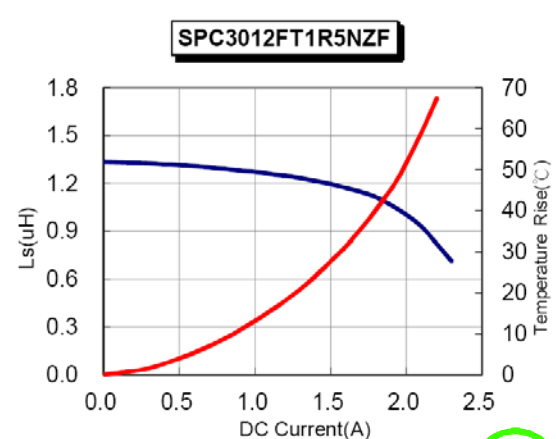
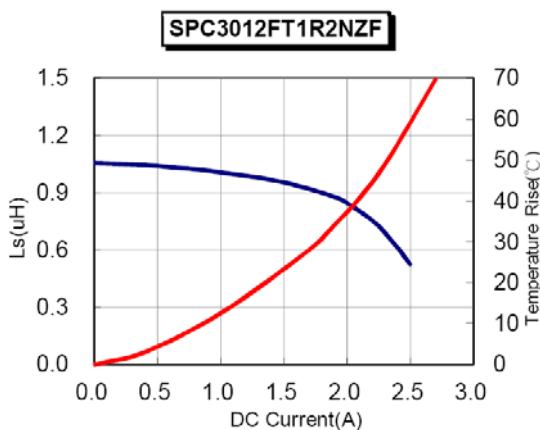
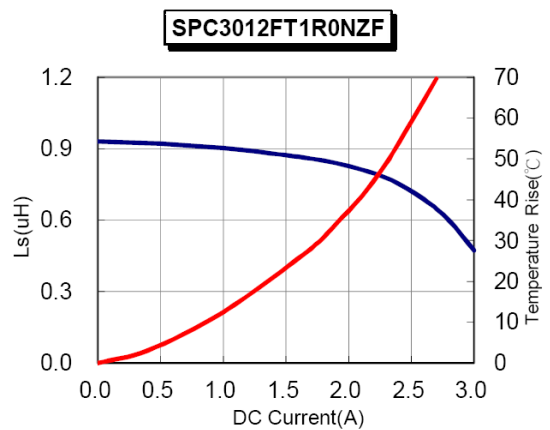
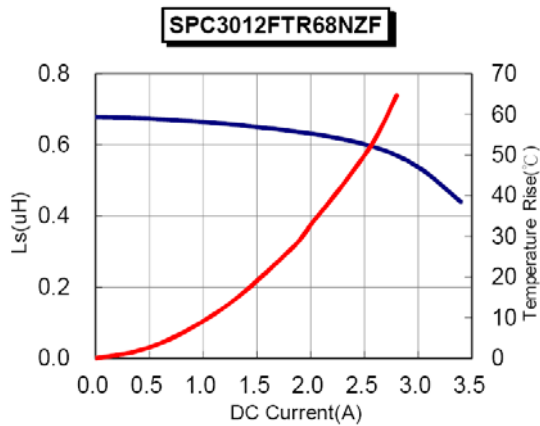
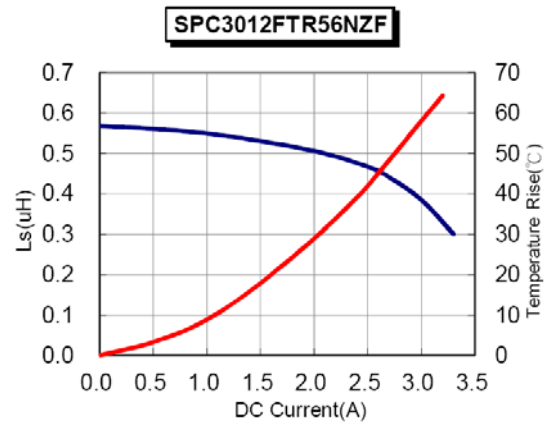
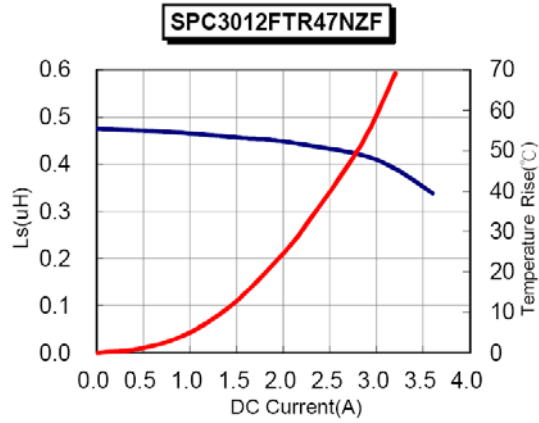

RoHS Compliant

NOTE : Specifications subject to change without notice. Please check our website for latest information.

16.10.2014



SUPERWORLD ELECTRONICS (S) PTE LTD

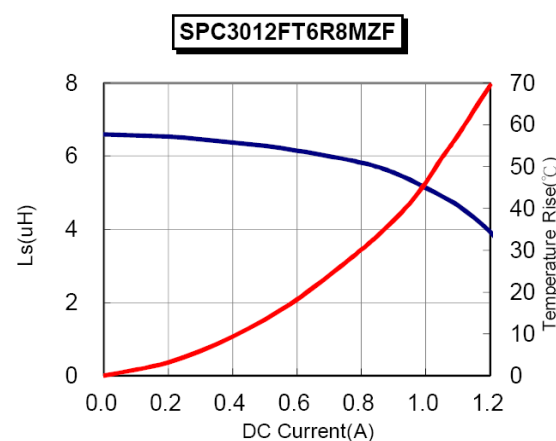
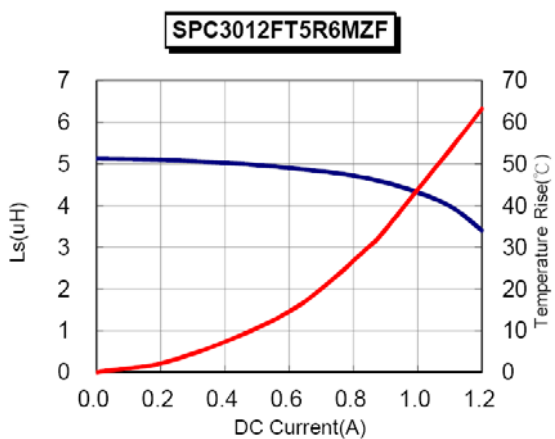
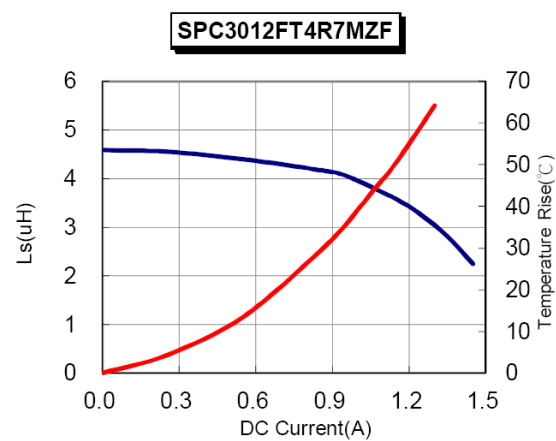
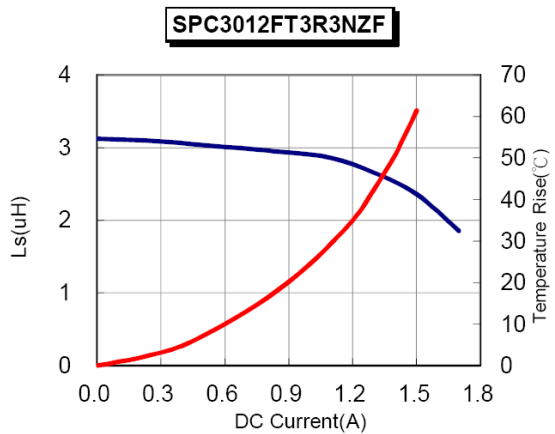
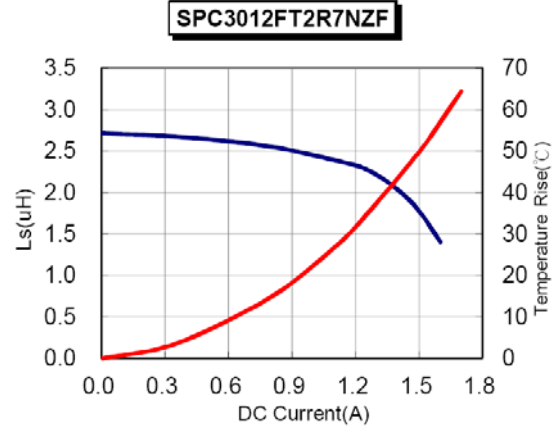
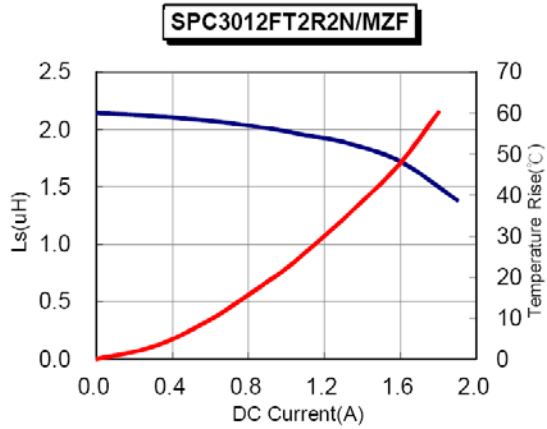

RoHS Compliant

NOTE : Specifications subject to change without notice. Please check our website for latest information.

16.10.2014



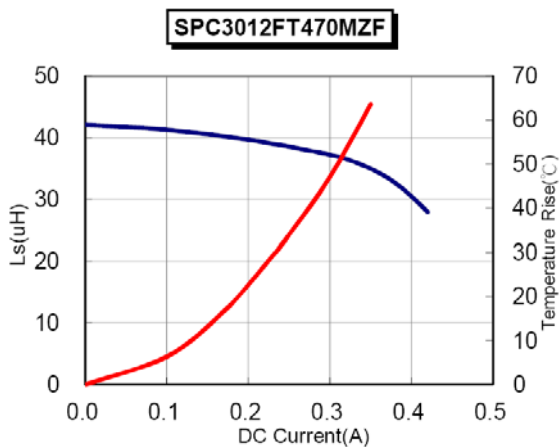
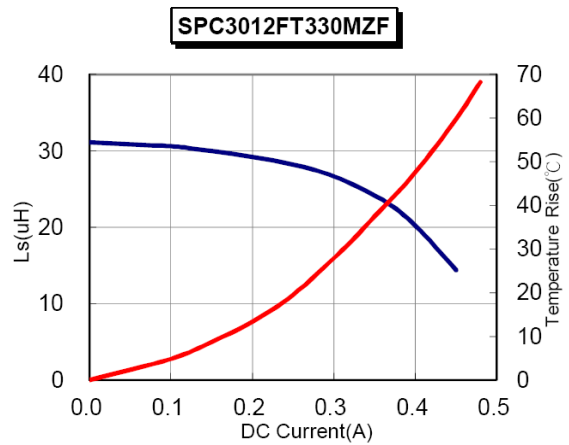
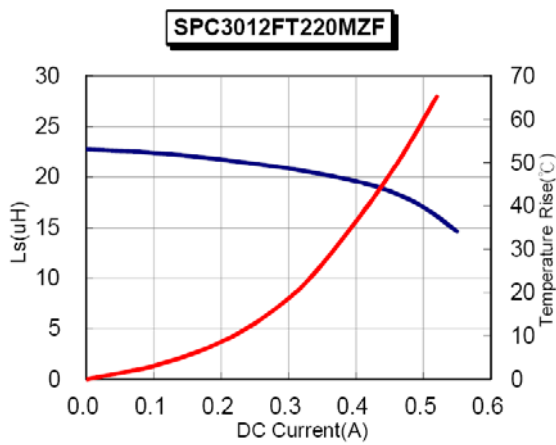
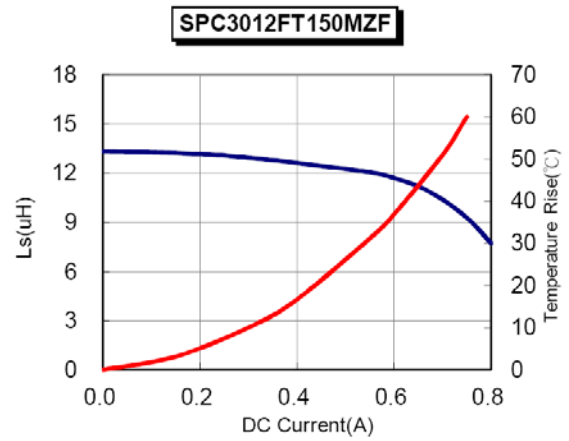
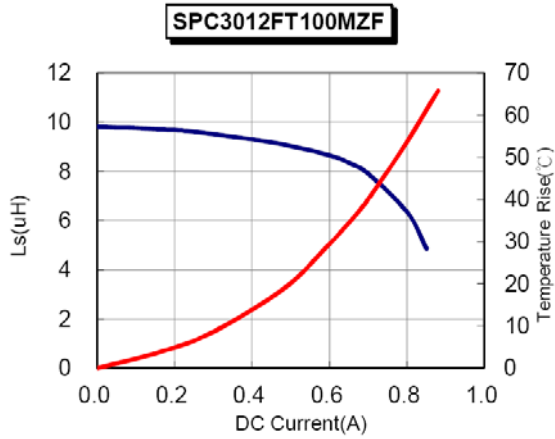

RoHS Compliant

NOTE : Specifications subject to change without notice. Please check our website for latest information.

16.10.2014



SUPERWORLD ELECTRONICS (S) PTE LTD

6-2. L vs. FREQUENCY

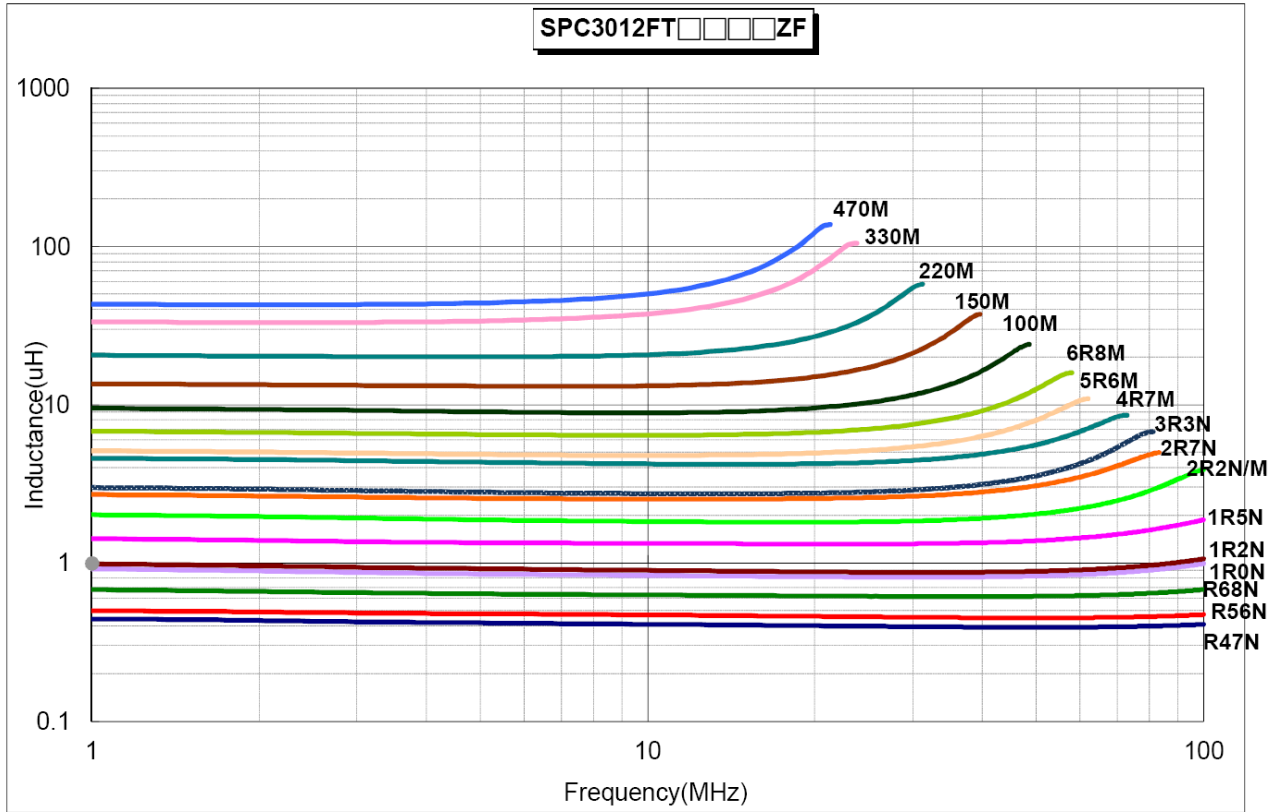

RoHS Compliant

NOTE : Specifications subject to change without notice. Please check our website for latest information.

16.10.2014



7. PACKAGING INFORMATION :

7-1. Reel Dimension (mm)

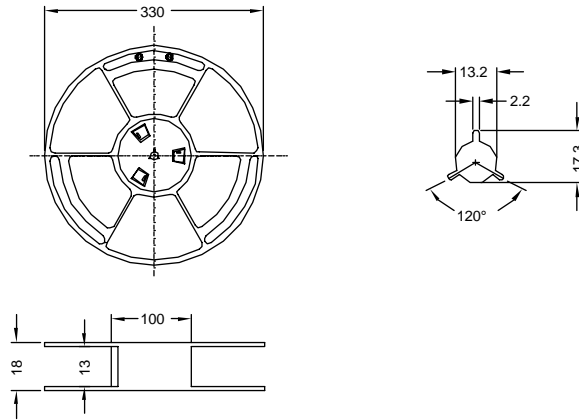

7-2 CARRIER TAPE DIMENSIONS (mm)

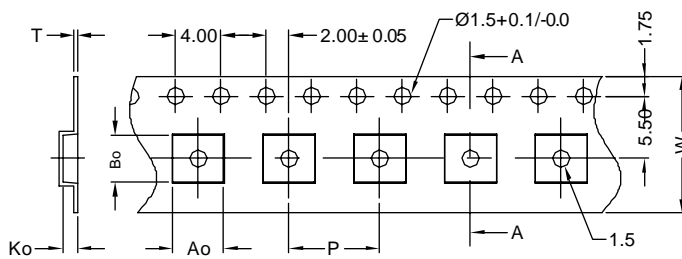

Ao	Bo	Ko	W	P	T
3.5mm	3.35mm	1.55mm	12mm	8.0mm	0.3mm

7-3 TAPING DIMENSIONS (mm)

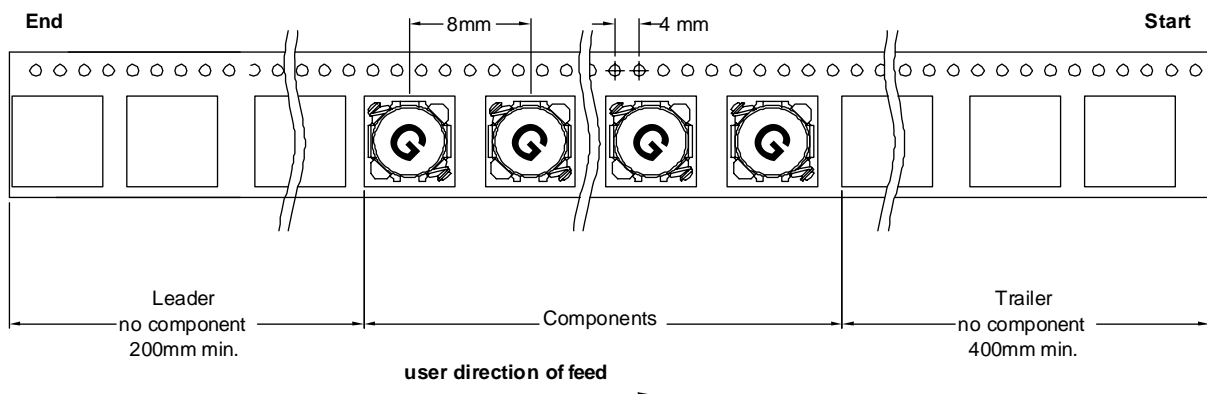

7-4 QUANTITY

3000pcs/Reel

The products are packaged so that no damage will be sustained.



RoHS Compliant

NOTE : Specifications subject to change without notice. Please check our website for latest information.

16.10.2014



SUPERWORLD ELECTRONICS (S) PTE LTD

PG. 7