

linear dimension(Tolerances Standard GB/T 14486-2008)								—	∇	\perp
variable range	to	over	over	over	over	over	over	to	to	to
	6	6 to 10	10 to 30	30 to 60	60 to 100	100 to 160	160 to			
tolerance	±0.20	±0.30	±0.50	±0.70	±1.00	±1.30	±1.60	0.10	0.30	0.60

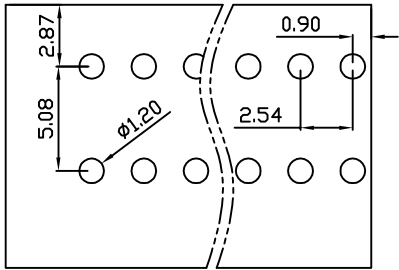

PCB Layout

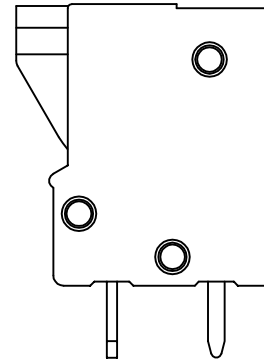
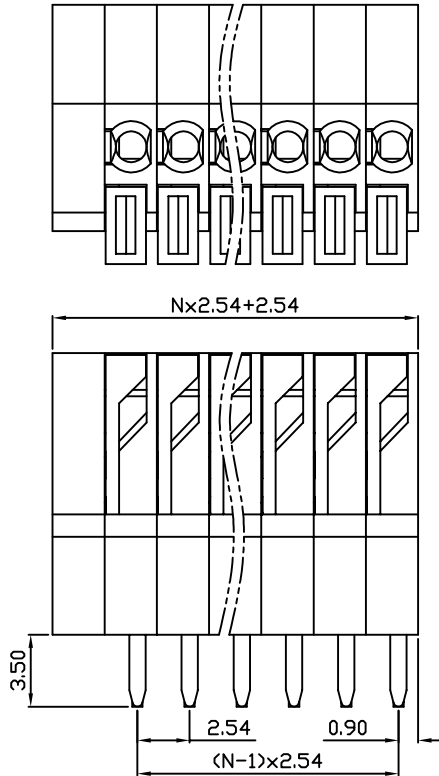
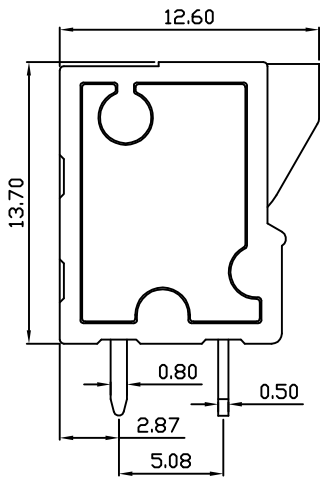

DB141V — 2.54 — XXP — C
 (Series No.) (Pitch) (Poles)
 (Color):GN:(Green), BK:(Black), BU:(Blue), RD:(Red), GY:(Gray)
 OG:(Orange), WT:(White), YL:(Yellow), CR:(Clear)

APPD: JTING Chen 2023.07.11
 CHKD: Duck Mao 2023.07.11
 DRFT: Steven Lu 2023.07.11

UL/CUL 技术参数		UL/CUL Technical Data					
等级	Use Group	B	C	D			
额定电压	Rated Voltage [V]	150	-	-			
额定电流	Rated Current [A]	4	-	-			
接线范围	Wire Range	26-18					
单/多芯线	Solid/Stranded [AWG]						
耐电压	Withstanding Voltage	1300V/1Min					
IEC 技术参数		IEC Technical Data					
过电压类别	Overvoltage Category	III	III	II			
污染等级	Contamination Class	3	2	2			
额定电压	Rated Voltage [V]	63	160	320			
额定电流	Rated Current [A]	6	6	6			
额定冲击电压	Impulse withstand voltagea [KV]	2.5	2.5	2.5			
导线截面积	Conductor cross section	0.5					
硬质/柔性导线	Solid/flexible [mm ²]						
材料		Material					
绝缘材料	Insulation Material	PA66					
阻燃等级	Imflamability	UL94V-0					
导体材料	Contact Material	铜合金 Copper alloy					
导体表面镀层	Contactive Coating	镀锡 Sn Plated					
一般参数		Other Data					
间距	Pitch [mm]	2.54					
极数	Poles [P]	01-24					
剥线长度	Stripping Length [mm]	11					
螺丝	Screw/扭矩 Torque(Max) [N.m]	-					
工作温度	Operating temperatur [°C]	-40~+105					
引针尺寸	Pin Dimensions [mm]	0.70x0.50					
PCB板孔径	PCB Hole Diameter [mm]	1.20					

DORABO 宁波地博电气有限公司
 Ningbo Dorabo Electric CO., Ltd

NAME: DB141V-2.54-XXP-C

	SIZE: A4	$\frac{\text{mm}}{\text{(inch)}}$	REV	T0-1
TYPE: CUSTOMER_DRAWING	SCALE: 1:1	SHEET	1/1	