

Specification for monolithic crystal filter

MQF 71.85 - 2500 / 11

1. General

1.1. Case:

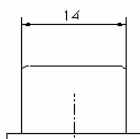
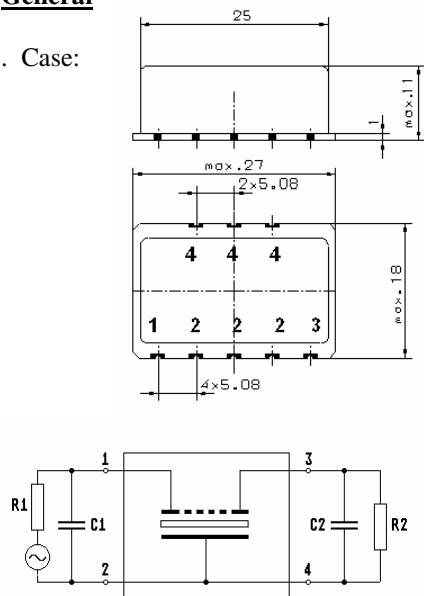

GS3.1

Chip-mount air reflow profile

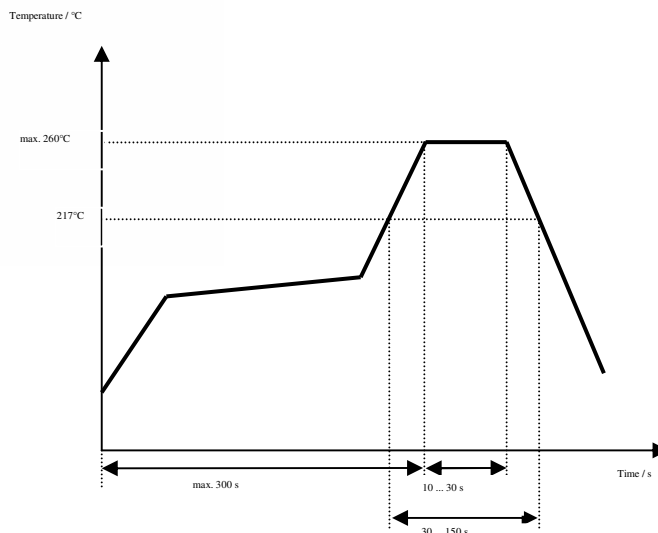

- 1.2. Type name: MQF 71.85-2500/11
- 1.3. Number of poles: 6, fundamental mode
- 1.4. Operating temperature range: -40°C to +70°C
- 1.5. Storage temperature range: -45°C to +85°C

2. Electric values

- 2.1. Nominal centre frequency fo: 71.85 MHz
- 2.2. **Pass band**
 - 2.2.1. Bandwidth between 6 dB - frequencies: > fo ± 12.5 kHz
 - 2.2.2. Ripple: < 1.5 dB at fo ± 9 kHz
 - 2.2.3. Group delay distortion: < 14 µs at fo ± 9 kHz
 - 2.2.4. Insertion loss: < 4.5 dB
(measured on smallest attenuation in pass band)
- 2.3. **Stop band**
 - 2.3.1. fo ± 30 kHz > 20 dB
 - 2.3.2. fo ± 45 kHz > 40 dB
 - 2.3.3. fo ± 60 kHz > 55 dB
 - 2.3.4. fo -900 kHz.....-1000 kHz > 80 dB
 - 2.3.5. Spurious responses: > 50 dB
- 2.4. Terminating impedance (input and output): 50 Ω // 0 pF
- 2.5. Maximum input level: -5 dBm (+5 dBm non-damaged)
- 3. Marking on the case: manufacturer, date code
MQF 71.85-2500/11
- 4. Environment conditions: Corresponding to Telefilter CF001