



## LDA-56

- Laser Diode Assembly
- 5.6mm TO-Can
- Focusable Acryl Lens
- Brass, black burnished



### Description



**LDA-56** is a complete laser diode assembly, suitable for standard 5.6mm TO-Can laser diodes. It features focusable acryl collimating lens and laser diode mounting flange with threaded latching. Made from black burnished brass, and tooled on high precision CNC machinery, **LDA-56** offers excellent dimensional accuracy and axial alignment.



### Specifications

| Parameter         | Symbol         | Values                 | Unit |
|-------------------|----------------|------------------------|------|
| Focus Length      | f              | 6.5                    | mm   |
| Back Focus Length | f <sub>B</sub> | 4.9                    | mm   |
| AR-coating        |                | uncoated               |      |
| Dimensions        |                | Ø11 x 12               | mm   |
| Material          |                | Brass, black burnished |      |
| Weight            |                | 5                      | g    |



## Drawing

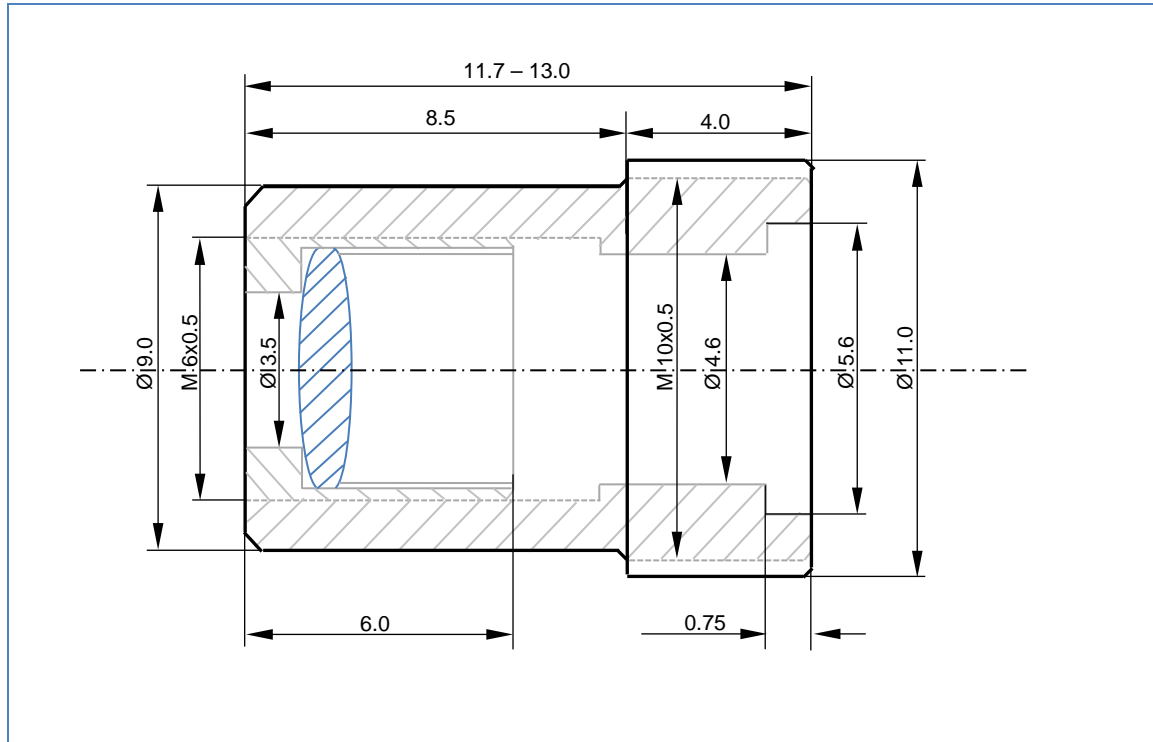

All dimensions in mm (ISO g7)

© All Rights Reserved

The above specifications are for reference purpose only and subjected to change without prior notice