

03

0316

Circular connectors with threaded joint M16 acc. to IEC 61076-2-106, IP40/IP67/IP68



Chassis plug acc. to IEC 61076-2-106, IP 68, with threaded joint, for printed circuit boards, for front mounting

03 0316

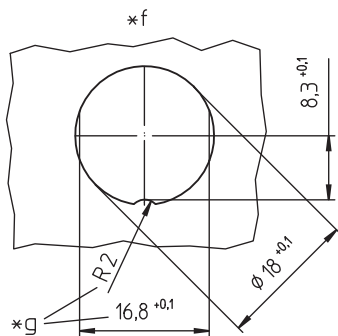
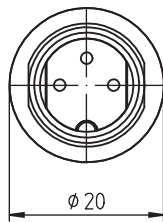
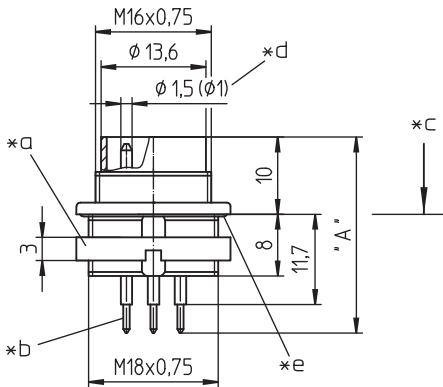
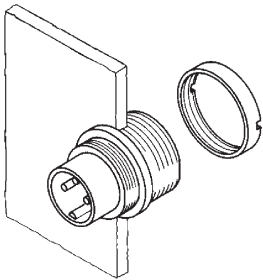

### Environmental conditions

Temperature range -40 °C/+85 °C

### Materials

Insulating body PA GF, V-0 according to UL94  
 Contact pin CuZn, silver-plated and flash gold-plated, tin-plated in solder area (3-8 poles)  
 CuZn, pre-nickel and gold-plated, tin-plated in solder area (12-14 poles)  
 Housing Zn diecast, pre-copper and nickel-plated  
 Ring screw CuZn, nickel-plated

### Mechanical data

Protection class IP68<sup>1</sup>

<sup>1</sup> according to IEC DIN EN 60529, only in locked condition with an appropriate counterpart; IPX8 requirements under agreement between manufacturer and user

### Electrical data (at T<sub>amb</sub> 20 °C)

Rated current 5 A (T<sub>amb</sub> 40 °C, 3-8 poles)  
 3 A (T<sub>amb</sub> 40 °C, 12-14 poles)  
 Rated voltage with pollution degree 1:  
 300 V (versions 03, 04, 05-1, 06, 07)  
 100 V (versions 05, 07-1, 08, 08-1)  
 160 V (versions 12, 14)  
 with pollution degree 2:  
 250 V (versions 03, 04)  
 32 V (versions 05, 07-1, 08, 08-1)  
 160 V (versions 05-1, 06, 07, 12, 14)  
 Rated impulse voltage 1500 V (versions 03, 04, 05-1, 06, 07, 12, 14)  
 500 V (versions 05, 07-1, 08, 08-1)  
 Material group II (IEC)/I (UL) (CTI ≥ 550)  
 Overvoltage category I  
 Insulation resistance > 100 MΩ

### Associated products

Counterparts  
 ☞ 0321 ☞ 0322 ☞ 0322-1  
 ☞ 032200 ☞ 0360 ☞ 036000

Accessories  
 ☞ 0382 ☞ 0383 ☞ 038399  
 ☞ 0384 ☞ 0385 ☞ 038899

03

0316

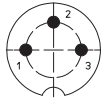

03-a  
0316 03

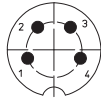

04-a  
0316 04

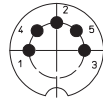

05-b  
0316 05

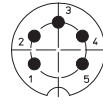

05-a  
0316 05-1

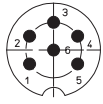

06-a  
0316 06

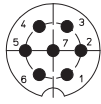

07-a  
0316 07

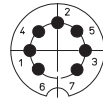

07-b  
0316 07-1

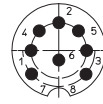

0316 08

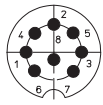

08-a  
0316 08-1

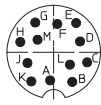

12-a  
0316 12

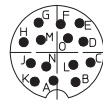

14-a  
0316 14

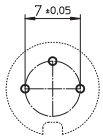

03-a  
0316 03

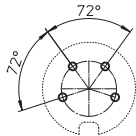

04-a  
0316 04

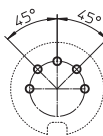

05-b  
0316 05

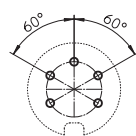

05-a  
0316 05-1

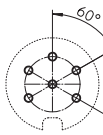

06-a  
0316 06

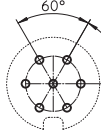

07-a  
0316 07

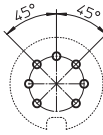

07-b  
0316 07-1

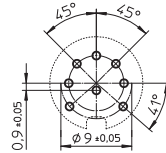

0316 08

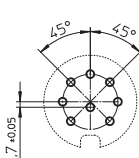

08-a  
0316 08-1

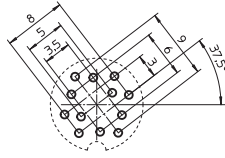

12-a  
0316 12

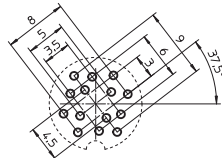

14-a  
0316 14

03

0316

- 
- \*a nut enclosed separately
  - \*b for bore hole of PCB  
Ø 1,0 mm (0316 03–0316 08-1)  
Ø 0,7 mm (0316 12–0316 14)
  - \*c mounting direction
  - \*d contact pin  
Ø 1.5 mm (0316 03–0316 08-1)  
Ø 1.0 mm (0316 12–0316 14)
  - \*e O-ring gasket
  - \*f port in mounting plate
  - \*g anti-rotation, alternative execution

03

0316

| Designation | Pole Number | PU (Pieces) | MDQ (Pieces) | Dimensions<br>A (mm) |
|-------------|-------------|-------------|--------------|----------------------|
| 0316 03     | 3           | 50          | 100          | 25.4                 |
| 0316 04     | 4           | 50          | 100          | 25.4                 |
| 0316 05     | 5           | 50          | 100          | 25.4                 |
| 0316 05-1   | 5           | 50          | 100          | 25.4                 |
| 0316 06     | 6           | 50          | 100          | 25.4                 |
| 0316 07     | 7           | 50          | 100          | 25.4                 |
| 0316 07-1   | 7           | 50          | 100          | 25.4                 |
| 0316 08     | 8           | 50          | 100          | 25.4                 |
| 0316 08-1   | 8           | 50          | 100          | 25.4                 |
| 0316 12     | 12          | 50          | 100          | 24.8                 |
| 0316 14     | 14          | 50          | 100          | 24.8                 |

**Packaging:**  
in a cardboard box