

# SMD Power Inductor (PSCD-1004 Series)

## Dimensions

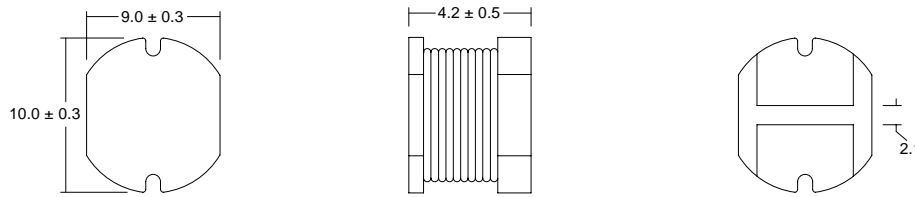

(Not to scale)

Dimensions in mm

## Part Numbering Guide

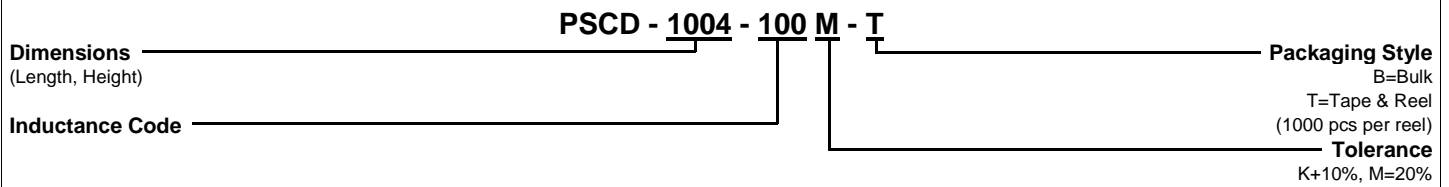

## Features

<b>Inductance Range</b>	10 $\mu$ H to 560 $\mu$ H
<b>Tolerance</b>	10%, 20% (see below for tolerance availability)
<b>Construction</b>	Magnetically Shielded

## Electrical Specifications

Inductance Code	Inductance ( $\mu$ H)	Available Tolerance	Test Freq	DCR Max (Ohms)	Permissible DC Current
100	10	M	2.52 MHz	0.05	2.38
120	12	M	2.52 MHz	0.06	2.13
150	15	M	2.52 MHz	0.07	1.87
180	18	M	2.52 MHz	0.08	0.73
220	22	M	2.52 MHz	0.09	1.60
270	27	M	2.52 MHz	0.10	1.44
330	33	M	2.52 MHz	0.12	1.26
390	39	M	2.52 MHz	0.15	1.20
470	47	M	2.52 MHz	0.17	1.10
560	56	K, M	2.52 MHz	0.20	1.01
680	68	K, M	2.52 MHz	0.22	0.91
820	82	K, M	2.52 MHz	0.25	0.85
101	100	K, M	1 kHz	0.34	0.74
121	120	K, M	1 kHz	0.40	0.69
151	150	K, M	1 kHz	0.54	0.61
181	180	K, M	1 kHz	0.62	0.56
221	220	K, M	1 kHz	0.72	0.53
271	270	K, M	1 kHz	0.95	0.45
331	330	K, M	1 kHz	1.10	0.42
391	390	K, M	1 kHz	1.24	0.38
471	470	K, M	1 kHz	1.53	0.35
561	560	K, M	1 kHz	1.90	0.32

Specifications subject to change without notice. Rev. 10/00