

ROHS

MATERIALS
 Housing: Plastic Thermoplastic, PA9T, UL94V-0, Black
 Contact Material: Copper Alloy Gold Selective Plated
 Front Shell: Zinc Alloy, Nickel Plated Over Copper
 RoHS Compliant

ELECTRICAL CHARACTERISTICS
 Rated Current: 1.0AMP
 Withstand Voltage: 500V AC/DC
 Insulation Resistance: 500M Ω Min
 Contact Resistance: 35m Ω Max
 Operation Temperature: -55° c to +105° c

材质
 胶芯: 塑胶 PA9T UL94V-0, 黑色
 端子: 铜合金, 镀半金锡
 前壳: 锌合金, 镀镍

规格
 耐电流: 1安培
 最大耐电压: 交流500伏特
 绝缘电阻: 最小值大于500百万欧姆
 接触电阻: 最大值小于35千分之一欧姆
 工作温度: -55°C到+105°C

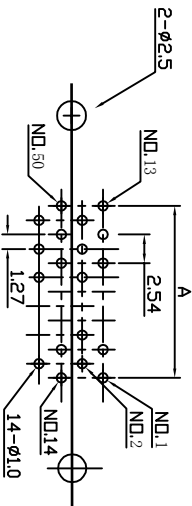
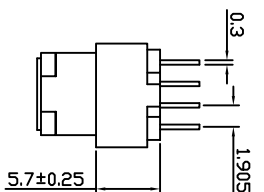
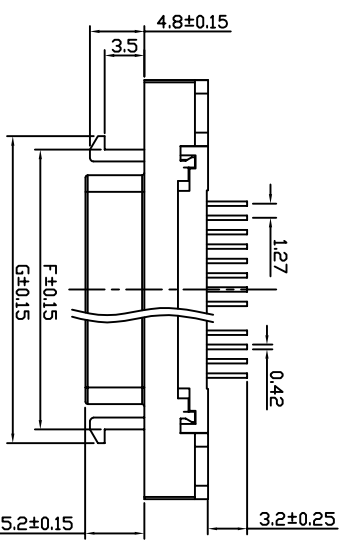
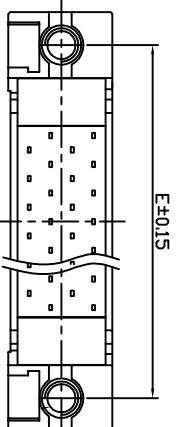

PCB LAYOUT

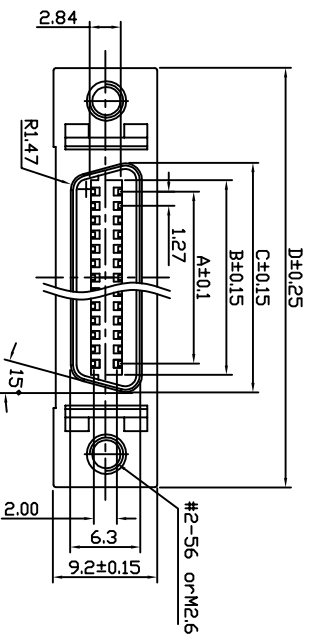

No. of Pin	DIMENSIONS						
	A	B	C	D	E	F	G
50	30.48	32.45	35.39	52.37	46.5	40.0	41.44

深圳市连盛精密连接器有限公司

PART NO. XHLJQ-00007

TITLE: 信号连接器 母座 SOP DIP

OPERATION		DRAW		SCALE FIT		PART NO.	TITLE:
X.X	±0.30	X.XX	CHECK	UNIT	mm		
A0	±0.15	X.XXX	±0.10	SIZE	A4	XHLJQ-00007	信号连接器 母座 SOP DIP
REV	DATE	MODIFICATION DESCRIPTION	CHANGE	Angle	±3°		
1	2	3	4	DIM	TOL	PROJ.	

Autodesk Inventor 甲6