







-  Compact surface mount package
-  Designed to meet Return Loss requirements of ITU G.703
-  Extended temperature range of -40°C to +85°C
-  Isolation voltage: 1500Vrms minimum



**ELECTRICAL SPECIFICATION @25°C**

Part Number	Turns Ratio (Pri: Sec ±2%)	OCL Primary@25°C (mH Min)	LL (uH Max)	C <sub>ww</sub> (pF Max)	DCR Primary ( Max)	DCR Secondary ( Max)	Isolation Voltage (Vrms Min)
821-00768F	1.26CT:1	1.2	1.0	50	2.5	2.0	1500
821-00868F	1CT:1	2.0	1.2	65	2.7	2.7	1500
821-00869F	1.14CT:1	2.2	1.4	65	2.8	2.8	1500
821-00870F	1.35CT:1	2.0	1.4	65	2.7	2.0	1500
821-01672F	1CT:1	1.2	1.2	35	2.7	2.7	1500

**Notes:**

1. Ordering Information: 821-0xxxxFc.  
 821-0xxxxF = Part number (F : stands for RoHS compliant).  
 c = Packaging Code (T = Tape & Reel Packaging in 13 inch Reel).
2. Inductance is measured at 10kHz, 0.1Vrms.



**MECHANICAL DIMENSIONS**

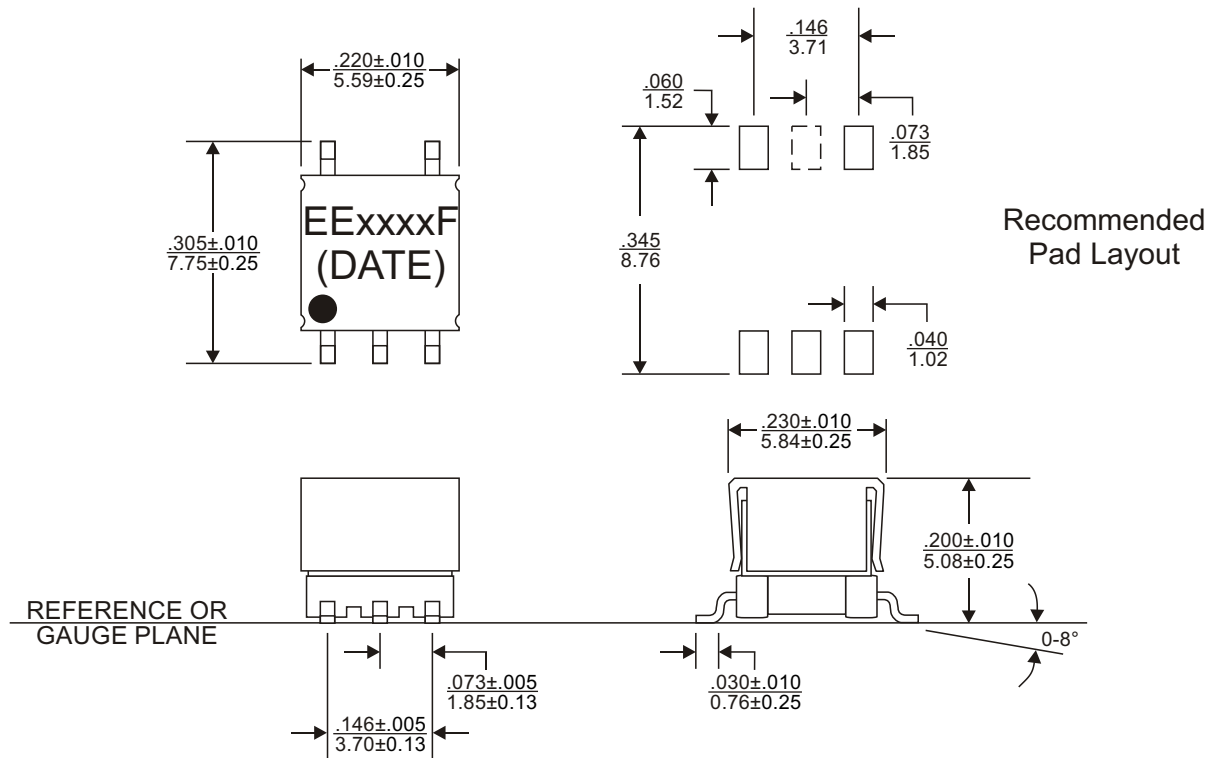

- Notes: 3. All dimensions are specified in  $\frac{\text{inches}}{\text{mm}}$  with higher precedence in inches.  
4. Unless otherwise specified, all tolerances are  $\pm \frac{.010}{0.25}$ .

Weight (in gram)	: 0.38 typ.
Tape & Reel	: 800 / reel

**SCHEMATICS**

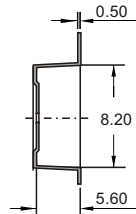
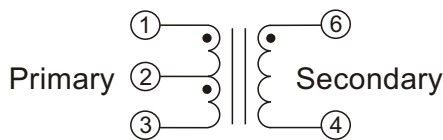

**PACKAGING**

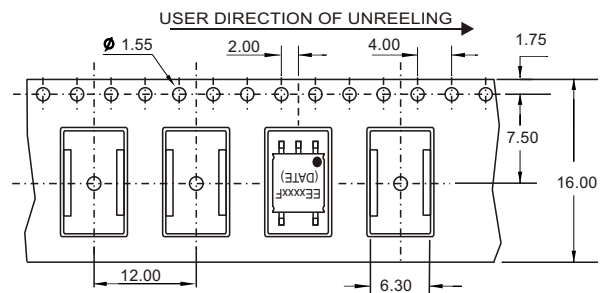

**FOR MORE INFORMATION, PLEASE CONTACT**

**HEADQUARTER**  
1/F., Harbour View 1, No.12 Science Park East Avenue,  
Phase II, Hong Kong Science Park, Shatin, N.T.  
Hong Kong  
Tel: (852) 2954 3333 Fax: (852) 2954 3304  
Email: eempl@eleceltek.com  
Website: <http://www.eleceltek.com> / [www.eemagnetic.com](http://www.eemagnetic.com)

Information herein is for reference only and subject to change without notice. It does not constitute any representation, warranty or commitment of the company in respect of the products in any aspect. All logos, brands and product names mentioned herein are trademarks or registered trademarks of their respective owners. The company does not assume any liability arising out of the application or use of any product or circuit described herein. Copyrights 2009, E & E Magnetic Products Limited.

1/F., Harbour View 1, No.12 Science Park East Avenue, Phase II, Hong Kong Science Park, Shatin, N.T. Hong Kong  
Tel: (852) 2954 3333 • Fax: (852) 2954 3304