

Rating	DC 15V 20mA	
Contact Resistance	100mΩ Max.	
Insulation Resistance	100MΩ Min.	
Withstand Voltage	AC 250V Min.	
Operating Force	4 Direction	240±50gf
	Center	360±50gf
Travel	4 Direction	0.25±0.1mm
	Center	0.15±0.1mm
Operating Life(cycles)	200,000	
General Tolerance	±0.2	

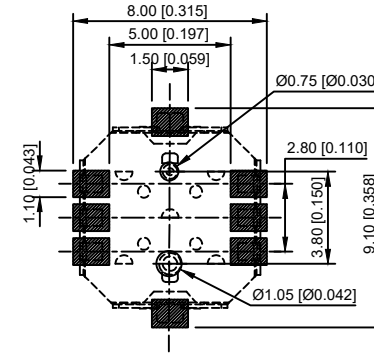

P.C.B LAYOUT
TOP VIEW

A4				
A3				
A2				
A1				
REV	DATE	REVISION	DESCRIPTION	ISSUE

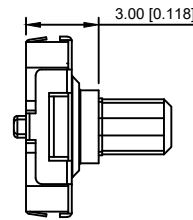

COMMON TOLERANCE

X.XX	± 0.10
X.X	± 0.15
X	± 0.25
ANGULAR	—

UNIT	MM	PROJECTED	
DRAWN BY	FUYUAN	CHECKED BY	COCO
DATE	2019	APPROVAL B	ALEN

PRODUCT NAME:

MODEL NO: TP-0207-2

Https: www.rocpcu.tw

ROCPCU TECHNOLOGY CO.,LTD

Copies are issued in strict confidence and shall not be reproduced or copied, or used as the basis of manufacture or sale of apparatus without permission