

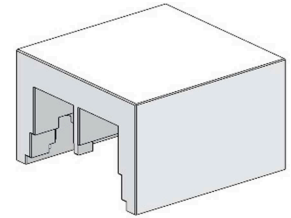

**1-by-2
Multi-Port
Insertion Tool**

**Application Tooling
Specification Sheet**



Order No. 200214-1120

FEATURES

- Lightweight tool used in the insertion of a zQSFP+ cage in a PCB
- Inserts connector to a PCB without damage to the board

SCOPE

Products: Small Form-Factor Pluggable zQSFP+ 1-by-2 Multi-Port Connector with Press-Fit PC Tails

Connector Series No.	Connector Order No.					
100015	100015-1231	100015-1232	100015-1233	100015-1234	100015-1235	100015-1236
	100015-1240	100015-1242	100015-1244	100015-1250	100015-1252	100015-1340
	100015-1341	100015-1342	100015-1343	100015-1344	100015-1345	100015-1440
	100015-1441	100015-1442	100015-1443	100015-1444	100015-1445	100015-1446
	100015-1447	100015-1448	100015-1540	100015-1541	100015-1542	100015-1543
	100015-1544	100015-1545	100015-1546	100015-1547	100015-1548	

Notes:

1. See the following page for tooling operation instructions.
2. This tool requires a "Keep Out Zone" to be free of components. The tool overhangs the rear of the cage to allow for light pipe options. The right and left sides should be .25" (6.4mm). See Figure 1.

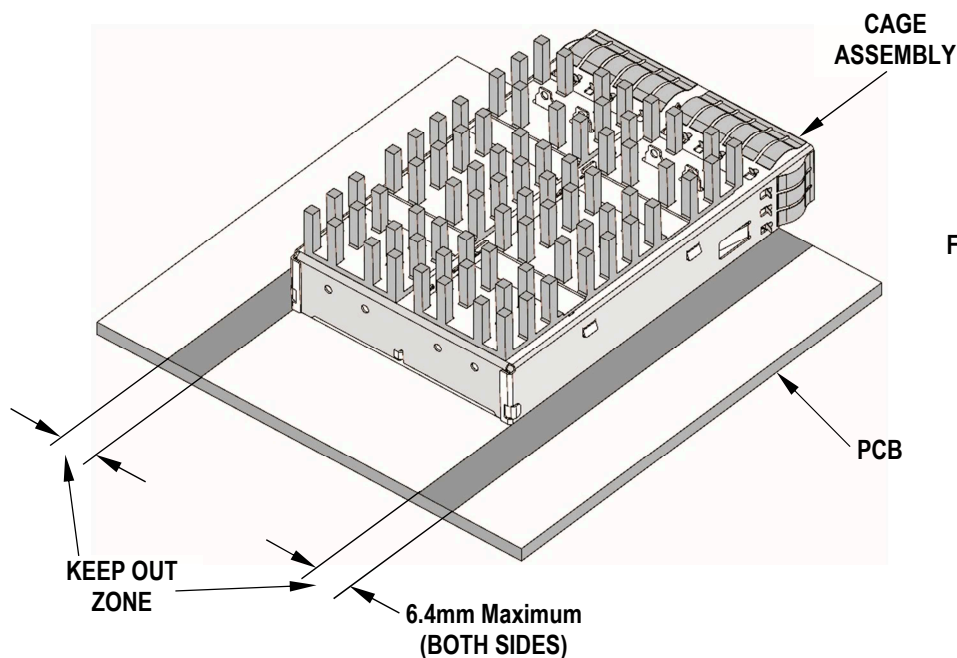

Figure 1

Operation

1. By hand, place a cage assembly on the PCB. Make sure all compliant tails are engaged in PCB holes.
2. Place the tool on the cage assembly, oriented as shown in Figure 2.
3. Place the tool, cage and PCB in a press of suitable size and force, and seat the cage as shown. The PCB support (not furnished by Molex) must have clearance for the connector pins if they pass through the PCB.

Note: This insertion tool does not contact the PCB when the connector is fully seated.

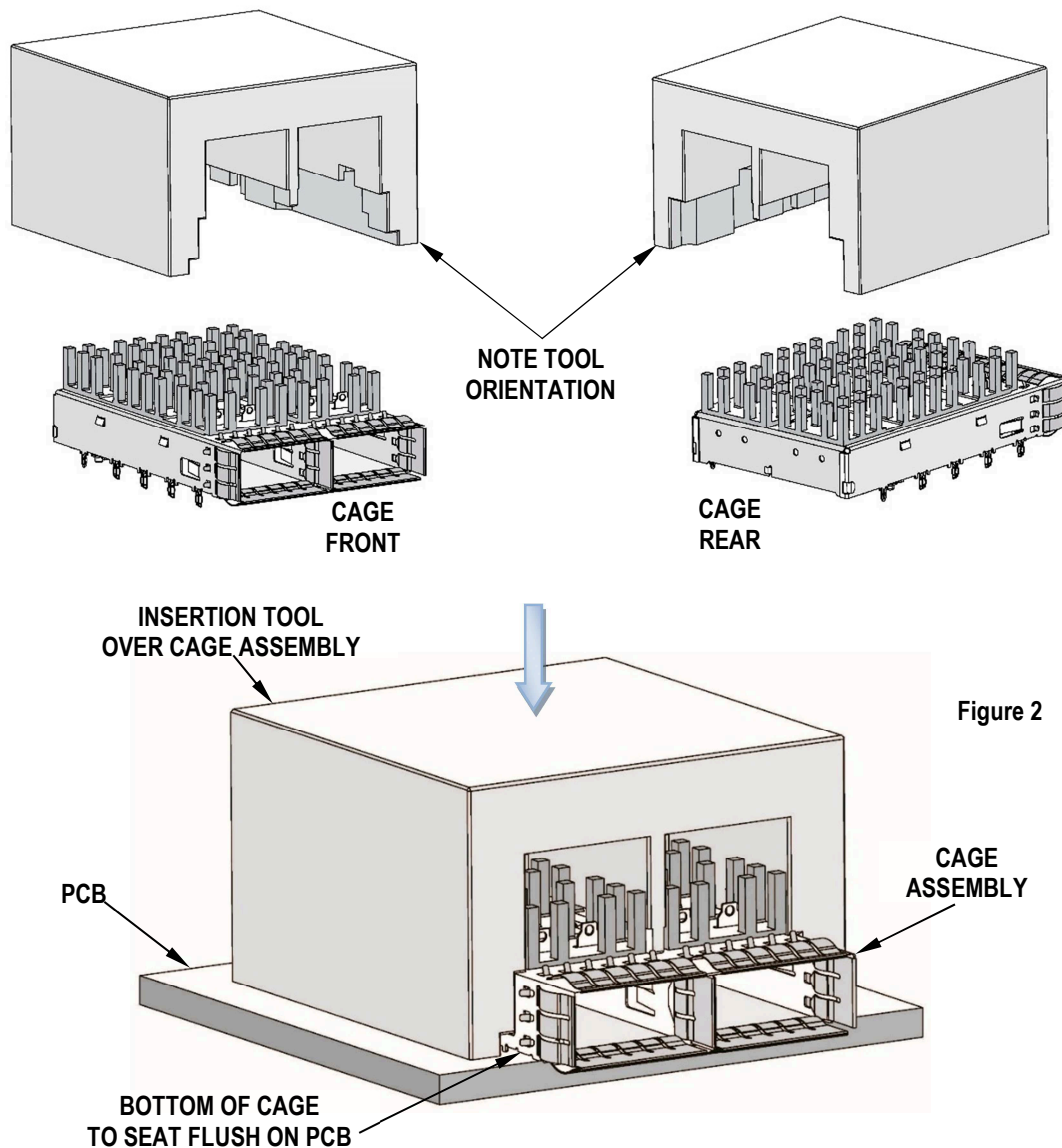

Figure 2

Application Tooling Support

Phone: +1-402-458-TOOL (8665)
E-Mail: applicationtooling@molex.com
Website: www.molex.com/applicationtooling

Molex is a registered trademark of Molex, LLC in the United States of America and may be registered in other countries; all other trademarks listed herein belong to their respective owners.