

## 8x20uS 6KA Transient Voltage Suppressors

TVS Diodes - 6KA > AK6 Series



### Mechanical Data

Terminal: Ag Plated leads, solderable per  
MIL-STD-750, Method 2026

Mounting Position: any

### Features

- Glass passivated junction
- Bi-directional
- RoHS compliant
- 6KA Surge capability at 8 x 20uS waveform(per IEC-61000-4-5)
- Excellent clamping capability
- Coating powder has underwriters Laboratory  
Flammability Classification 94V-0
- Operation and storage Temperature:-40°C to +125°C



### Electrical Characteristics

Part Number	Reverse Stand-Off Voltage		Breakdown Voltage $V_{BR@IT}$		Test Current $I_T(mA)$	Maximum Clamping Voltage @IPP $V_C(V)$	Peak Pulse Current 8/20uS $I_{PP}$	Maximum Energy 10/1000uS	Reverse Leakage @ $V_{RWM}$ $I_R(\mu A)$	Delivery Time Days
	$V_{AC}$	$V_{DC}$	Min(V)	Max(V)						
AK6-015C	11V	15V	16	19	10	85	6KA	1300A	20	15days
AK6-020C	14V	20V	22	24	10	90	6KA	1600A	20	15days
AK6-025C	17V	25V	28	30	10	95	6KA	1900A	20	15days
AK6-030C	21V	30V	32	37	10	100	6KA	2400A	20	15days
AK6-042C	30V	42V	47	51	10	105	6KA	3400A	20	15days
AK6-058C	40V	58V	64	70	10	110	6KA	4900A	20	15days
AK6-066C	45V	66V	72	80	10	120	6KA	5200A	20	15days
AK6-076C	54V	76V	85	95	10	140	6KA	5600A	20	15days
AK6-100C	72V	100V	110	120	10	165	6KA	8500A	20	15days
AK6-133C	100V	133V	147	162	10	220	6KA	10600A	20	15days
AK6-170C	130V	170V	179	220	10	260	6KA	14000A	20	15days
AK6-190C	145V	190V	200	245	10	290	6KA	16800A	20	15days
AK6-200C	150V	200V	223	246	10	330	6KA	17200A	20	15days

Electrical Characteristics



Part Number	Reverse Stand-Off Voltage		Breakdown Voltage $V_{BR@IT}$		Test Current	Maximum Clamping Voltage @IPP	Peak Pulse Current 8/20uS	Maximum Energy	Reverse Leakage @ $V_{RWM}$	Delivery Time
	$V_{AC}$	$V_{DC}$	Min(V)	Max(V)	$I_{T(mA)}$	$V_C(V)$	$I_{PP}$	10/1000uS	$I_{R(\mu A)}$	Days
AK6-240C	180V	240V	250	285	10	340	6KA	18000A	20	15days
AK6-275C	210V	275V	300	335	10	435	6KA	19000A	20	15days
AK6-300C	230V	300V	330	366	10	470	6KA	25500A	20	15days
AK6-380C	275V	380V	401	443	10	520	6KA	30000A	20	15days
AK6-430C	310V	430V	440	490	10	625	6KA	30000A	20	15days

Dimensions

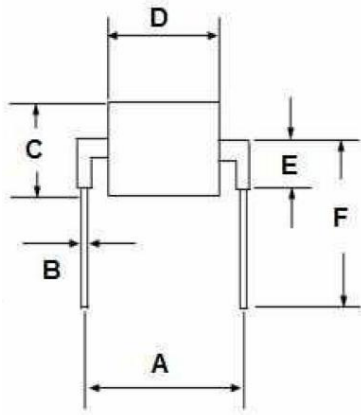

Dimensions	Inchs	Millimeters
A	0.950+/-0.028	24.15+/-0.72
B	0.049+/-0.019	1.25+/-0.05
C	0.531 max	13.5 max
D-058/66C	0.196 max	5.0 max
D-076C	0.236 max	6.0 max
D-170C/190C	0.393 max	10.0 max
D-240C	0.472 max	12.0 max
D-270C	0.512 max	13.0 max
D-380C/430C	0.629 max	16.0 max
E	0.259 max	6.6 max
F	0.590 mmin	15.0 min

Ratings and Characteristics Curve

Fig.1 - Test Pulse Waveform

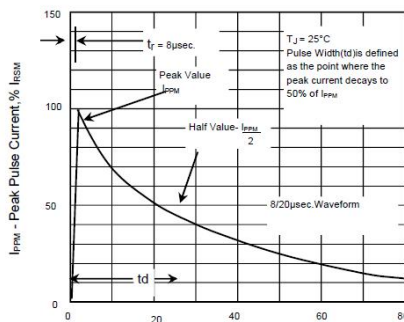

Fig.2 - Pulse Derating Curve

