

KEMET, GTX, EMI/RFI Filters, Noise Suppression, 250 VAC, 560 V, 16 A, 75x44x25mm

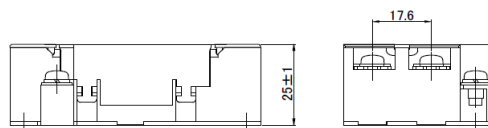
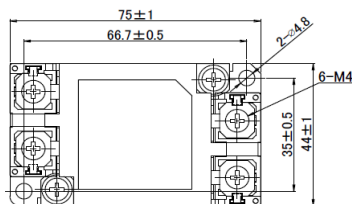

Dimensions	
L	75mm +/-1mm
W	44mm +/-1mm
H	25mm +/-1mm
L1	66.7mm +/-0.5mm

Packaging Specifications	
Packaging Quantity:	30
Weight:	128 g

General Information	
Series:	GTX
Style:	Chassis Mount
Description:	EMI Filter, With Y Capacitor
Features:	Single-phase
RoHS:	Yes

Specifications	
Voltage AC:	250 VAC
Voltage DC:	560 VDC
Ripple Current:	16 A
Temperature Range:	-25/+55°C
Voltage:	560 VDC
Leakage Current:	2.3 mA (MAX)