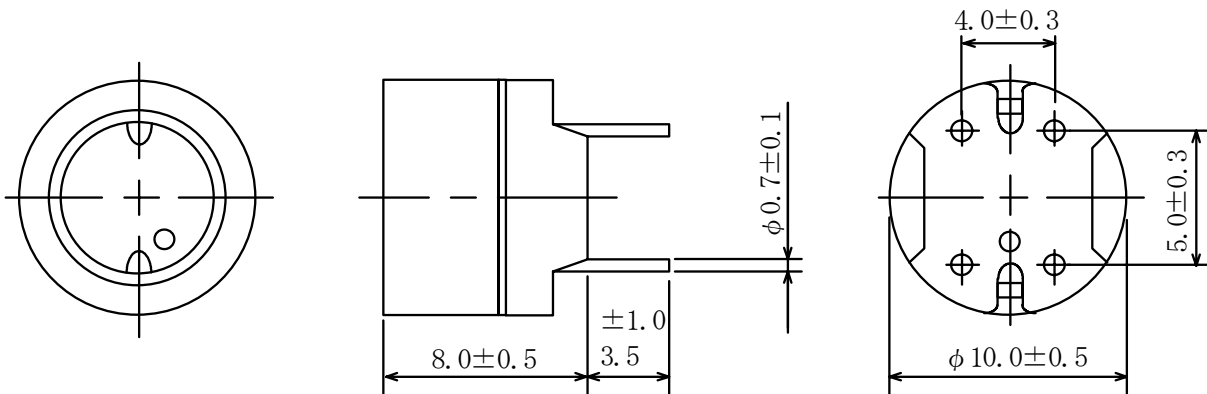
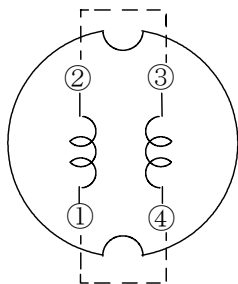
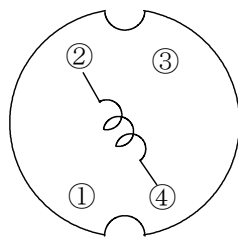

Type: RCR-108D
◆ Product Description

- 10.5mm Max. ϕ , 8.5mm Max. Height.
- Inductance range: 1.0 μ H~1.0mH
- Rated Current Range: 0.28~9.15A
- In addition to the standard versions of inductors shown here, custom inductors are available to meet your exact requirements

◆ Feature

- Magnetically shielded construction.
- Ideally Used in Printers, LCD TV, DVD, Printer, Copy Machine, Mainboard of the compounding machines, etc as Power Supplies's Inductors or DC-DC Converter inductors.
- RoHS Compliance

◆ Dimensions (mm)

◆ Schematics (Bottom)

 (1.0 μ H~8.2 μ H)

 (10 μ H~1.0mH)

Type: RCR-108D
◆ Specification

Part Name	Stamp	Inductance [Within] ※1	D.C.R.(Ω) [Max.] (at 20°C)	Rated Current (A)※2	S.R.F. (MHz) <Ref.>
RCR108DNP-1R0N	1R0N	1.0 μ H ± 30%	6.5m	9.15	61.5
RCR108DNP-1R5N	1R5N	1.5 μ H ± 30%	8.5m	7.40	48.0
RCR108DNP-2R2N	2R2N	2.2 μ H ± 30%	9.5m	6.05	38.0
RCR108DNP-3R3N	3R3N	3.3 μ H ± 30%	13.5m	4.90	32.0
RCR108DNP-4R3N	4R3N	4.3 μ H ± 30%	14.5m	4.25	26.5
RCR108DNP-5R6N	5R6N	5.6 μ H ± 30%	18.5m	3.65	23.0
RCR108DNP-6R8N	6R8N	6.8 μ H ± 30%	20.0m	3.40	20.0
RCR108DNP-8R2N	8R2N	8.2 μ H ± 30%	20.5m	3.00	18.5
RCR108DNP-100M	100M	10 μ H ± 20%	50m	2.80	29.3
RCR108DNP-120M	120M	12 μ H ± 20%	60m	2.50	23.0
RCR108DNP-150M	150M	15 μ H ± 20%	70m	2.30	19.5
RCR108DNP-180M	180M	18 μ H ± 20%	80m	2.10	18.7
RCR108DNP-220M	220M	22 μ H ± 20%	90m	2.00	17.0
RCR108DNP-270M	270M	27 μ H ± 20%	0.10	1.76	14.5
RCR108DNP-330M	330M	33 μ H ± 20%	0.11	1.60	12.7
RCR108DNP-390M	390M	39 μ H ± 20%	0.12	1.38	11.6
RCR108DNP-470M	470M	47 μ H ± 20%	0.14	1.28	9.72
RCR108DNP-560L	560L	56 μ H ± 15%	0.15	1.20	8.91
RCR108DNP-680L	680L	68 μ H ± 15%	0.16	1.00	8.04
RCR108DNP-820L	820L	82 μ H ± 15%	0.18	0.96	7.70
RCR108DNP-101L	101L	100 μ H ± 15%	0.20	0.92	6.64
RCR108DNP-121L	121L	120 μ H ± 15%	0.24	0.80	5.84
RCR108DNP-151L	151L	150 μ H ± 15%	0.35	0.73	5.18
RCR108DNP-181L	181L	180 μ H ± 15%	0.40	0.64	4.83
RCR108DNP-221L	221L	220 μ H ± 15%	0.54	0.61	4.00
RCR108DNP-271L	271L	270 μ H ± 15%	0.76	0.56	3.63
RCR108DNP-331L	331L	330 μ H ± 15%	0.86	0.50	3.51
RCR108DNP-391L	391L	390 μ H ± 15%	0.93	0.44	3.28
RCR108DNP-471L	471L	470 μ H ± 15%	1.23	0.41	2.62
RCR108DNP-561L	561L	560 μ H ± 15%	1.34	0.38	2.46
RCR108DNP-681L	681L	680 μ H ± 15%	1.53	0.34	2.24
RCR108DNP-821L	821L	820 μ H ± 15%	2.10	0.32	2.06
RCR108DNP-102L	102L	1.0mH ± 15%	2.30	0.28	1.94

※1 Measuring frequency 1.0 μ H ~ 8.2 μ H at 7.96MHz
 10 μ H ~ 1.0mH at 1kHz

※2 Rated current: The DC current at which the inductance decreases 90% of it's initial value or when
 $\Delta t = 40^{\circ}\text{C}$ whichever is lower ($T_a = 20^{\circ}\text{C}$).