

# Power Jacks

## Features

- Panel Mount Types
- Metal Housing

## Specifications

**Rating:** 30VDC, 5A (57-PJ10 thru 57-PJ40)  
 24VDC, 2A (57-PJ50 thru 57-PJ80)  
 30VDC, 2A (57-PJ90 Only)

**Contact Resistance:**  $\leq 0.03\Omega$

**Insulation Resistance:**  $\geq 100M\Omega$

**Withstanding Voltage:** 500VAC

**Inserting and Extraction Force:** 3 to 20N

**Life Test:** 5000 cycles

**Temperature:**  $-20^{\circ}$  to  $+85^{\circ}\text{C}$

## Ordering Information

| NTE Type No.       | Description        | Mounting Hole              | Diag No. |
|--------------------|--------------------|----------------------------|----------|
| 57-PJ10            | 5.5mm x 2.1mm Jack | .437" (11.0)               | JK-01    |
| 57-PJ20            | 5.5mm x 2.5mm Jack | .437" (11.0)               | JK-01    |
| 57-PJ30            | 5.5mm x 2.1mm Jack | .313" (8.0)                | JK-02    |
| 57-PJ40            | 5.5mm x 2.5mm Jack | .313" (8.0)                | JK-02    |
| <i>NEW</i> 57-PJ50 | 5.5mm x 2.1mm Jack | .320" (8.1)                | JK-03    |
| <i>NEW</i> 57-PJ60 | 5.5mm x 2.5mm Jack | .320" (8.1)                | JK-03    |
| <i>NEW</i> 57-PJ70 | 5.5mm x 2.1mm Jack | .320" (8.1)                | JK-04    |
| <i>NEW</i> 57-PJ80 | 5.5mm x 2.5mm Jack | .320" (8.1)                | JK-04    |
| <i>NEW</i> 57-PJ90 | 5.0mm x 2.1mm Jack | .350" (8.9) x .430" (10.9) | JK-05    |

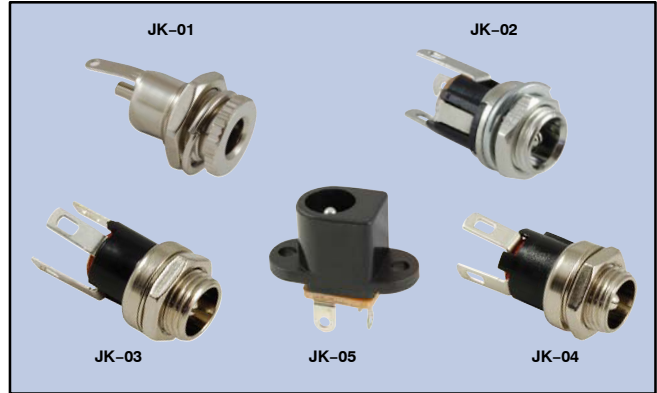

### JK-01

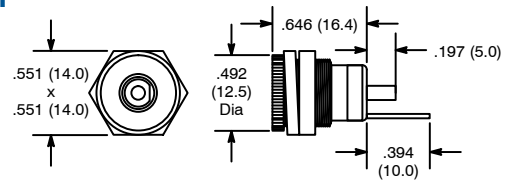

### JK-02

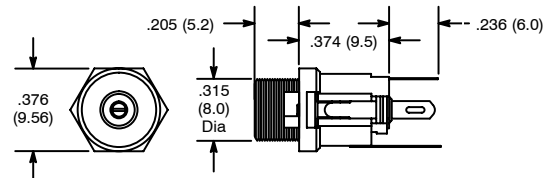

### JK-03

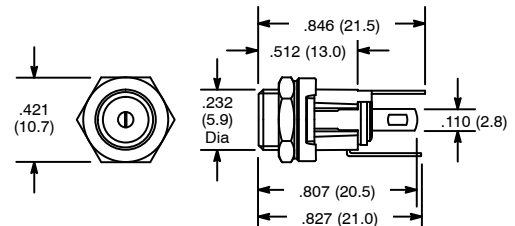

### JK-04

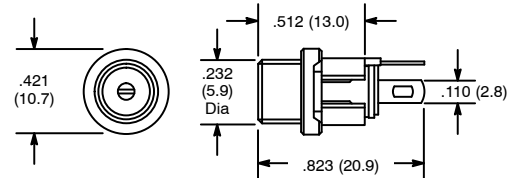

### JK-05

