

PC card drilling dimensions (after plating)  
[thickness 1.60±0.20mm]

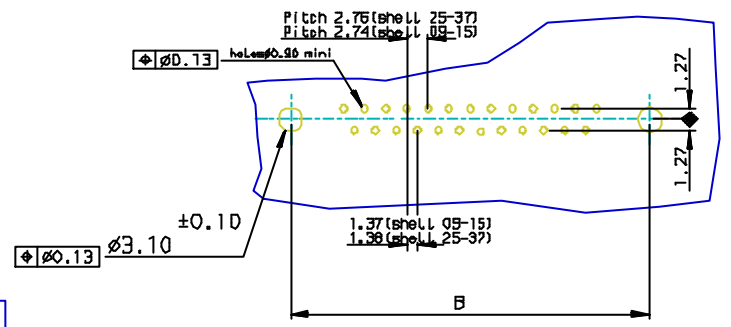

Part Number & Date Code Printing

SECTION A-A

		PART NUMBER				Plating: 0.76µ AU	Plating: Flash AU
SHELL	A±0.38	B±0.12	C±0.10	D±0.25			
09	30.81	24.99	16.96	16.21	D09S13B6G*00**	D09S13B4G*00**	
15	39.14	33.32	25.18	24.54	D15S13B6G*00**	D15S13B4G*00**	
25	53.03	47.04	39.12	38.25	D25S13B6G*00**	D25S13B4G*00**	
37	69.32	63.50	55.68	54.71	D37S13B6G*00**	D37S13B4G*00**	

Threaded ØT M3 = L  
Threaded ØT 4.40 = X  
LF FOR LEAD FREE

REQUIREMENTS

**Technical characteristics**  
 Shell: steel tin/Zinc Cr3 plated  
 Insulators: self-extinguishing black polyester, UL Class 94V0  
 Contacts size 20: brass, gold 0.76µ on mating end, bright tin on termination end and over nickel on entire contact  
 Cycles: 200 for plating 4  
 500 for plating 6

Harpoons: phosphor bronze, tin plated  
 Metal plate for electrical continuity: brass, tin/Zinc Cr3 plated  
 Nuts: brass, tin/Zinc Cr3 plated

**Electrical characteristics**  
 max. current rating: 5A  
 Test voltage: 1000V  
 Rated voltage: 300V  
 Contact resistance: <15mΩ  
 Shell resistance: <5mΩ  
 Insulation resistance: >5000MΩ

**Climatic characteristics**  
 Operating temperature range: -55°C +125°C

**Dimensions**  
 In accordance with MIL-C-24308

FOR ROHS DETAILS REFER DWG. NO: C01-8646-0000

European Views

www.fciconnect.com		surface ISO 1302 ✓	tolerance std ISO 406 ISO 1101	projection mm
		TOLERANCES UNLESS OTHERWISE SPECIFIED		
Dr	JOHN SLEEBA	1994/08/01	ANGULAR	L LINEAR
Eng	GEORGE VJ	1994/08/01	0.X	±D.1
Chr	GEORGE VJ	2005/07/27	0.XX	±D.1
Appr	KVSD	2005/07/27	0.XXX	±D.1
Product family		D-SUB		
Title		Socket connect. Delta D right angled with nut, harpoon & metal plate		
Catalog no		DELTA-D		
Drawing no		C01-8646-0295		
Rev.		E		
Customer		sheet 1 of 1		



Copyright FCI