

| Rev | AWO # | Description | Date | Appr |
|-----|-------|-------------|----------|------|
| - | | RELEASED | 12/18/09 | |

APPROVED: _____
 DATE: _____ TITLE: _____

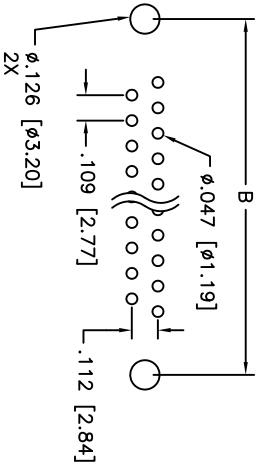
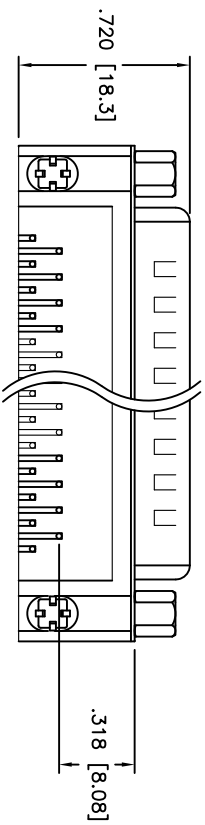
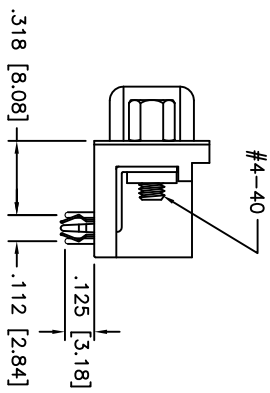
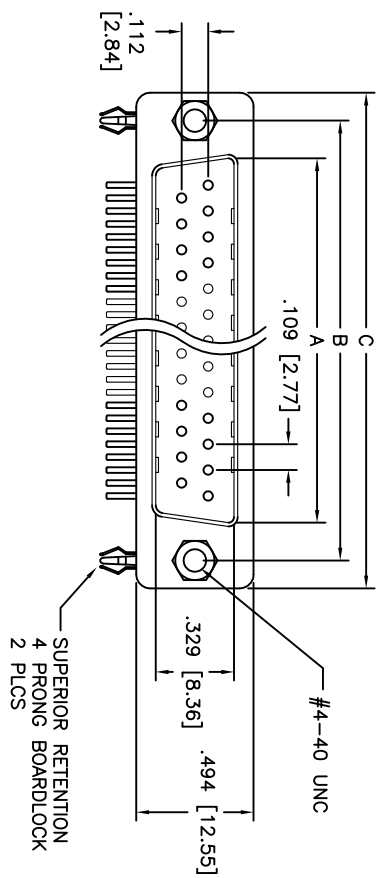

RECOMMENDED PCB LAYOUT

| POSITIONS | Plug Dimensions | | |
|-----------|-----------------|---------------|---------------|
| | A | B | C |
| 9 | .666 [16.92] | .984 (24.99) | 1.213 (30.81) |
| 15 | .994 [25.25] | 1.312 (33.32) | 1.543 (39.20) |
| 25 | 1.534 [38.96] | 1.852 (47.04) | 2.090 (53.10) |
| 37 | 2.182 [55.42] | 2.500 (63.50) | 2.732 (69.40) |

SPECIFICATIONS:

Material: Insulator: PBT, glass reinforced, rated UL 94V-0
 Insulator color: Black
 Contacts: Phosphor Bronze
 Shell: Steel, Zinc plated

Plating: Gold flash over Nickel underplate overall

Electrical: Operating voltage: 250 VAC max

Current rating: 5 Amps max

Contact resistance: 20 mohms max

Insulation resistance: 5000 Mohms min @ 500 VDC

Dielectric withstanding voltage: 1000 VAC for 1 minute

Temperature Rating: Operating temperature: -65°C to +125°C

Environmental: Lead free, RoHS compliant.

Recommended soldering temp: 235°C for 5 sec.



ADAM TECH

909 Railway Avenue, Union, NJ 07083
 Phone: 908-687-5000 Fax: 908-687-5710

D-SUB, RIGHT ANGLE MALE, PCB GOLD PLATED

| | |
|--|--------------|
| UNLESS OTHERWISE SPECIFIED ALL DIMENSIONS ARE IN INCHES [MM] | |
| TOLERANCES: EXCEPT AS NOTED | |
| INCHES | HOLDS |
| .X ± .10 | ØXX ± .10 |
| .XX ± .020 | ØXXX ± .015 |
| .XXX ± .015 | ØXXXX ± .010 |
| APPROVALS | DATE |
| DRAWN DY | 12/18/09 |
| CHECKED | |
| APPROVED | |

| | | |
|------|--------------|--------------|
| SIZE | PART NO. | REV. |
| X | DXXX+PL-25-F | - |
| REF: | SCALE: NTS | SHEET 1 OF 1 |