

TO-126K Plastic-Encapsulate Thyristors

CT404E 4Q TRIACs

MAIN CHARACTERISTICS

$I_{T(RMS)}$		4A
V_{DRM}/V_{RRM}	CT404E-600S/C	600V
	CT404E-800S/C	800V
V_{TM}		1.55V

FEATURES

- NPNPN 5-layer Structure TRIACs
- Mesa Glass Passivated Technology
- Multi Layers Metal Electrodes
- High Junction Temperature
- Good Commutation Performance

APPLICATIONS

- Heater Control
- Motor Speed Controller
- Mixer

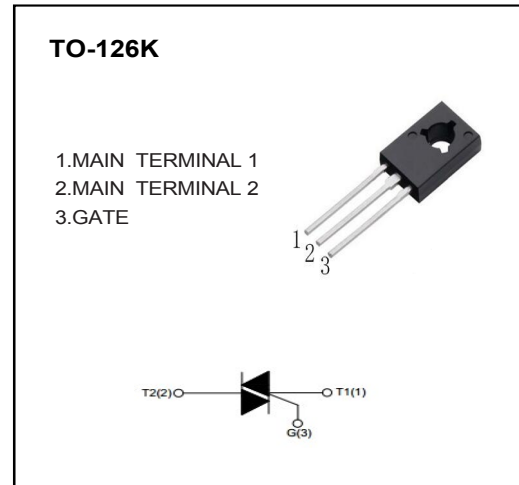

MARKING

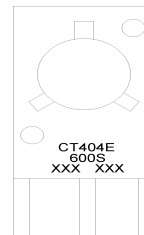

CT404E:Series Code
600S:Depends on V_{DRM}
and I_{GT}
XXX:Internal Code

ABSOLUTE RATINGS ($T_a=25^{\circ}C$ unless otherwise noted)

Symbol	Parameter	Test condition	Value	Unit	
V_{DRM}/V_{RRM}	Repetitive peak off-state voltage	$T_j=25^{\circ}C$	CT404E-600S/C	600	V
			CT404E-800S/C	800	V
$I_{T(RMS)}$	RMS on-state current	TO-126K($T_c \leq 107^{\circ}C$), Fig. 1,2	4	A	
I_{TSM}	Non repetitive surge peak on-state current	Full sine wave , $T_j(\text{init})=25^{\circ}C$, $t_p=20\text{ms}$; Fig. 3,5	25	A	
I^2t	I^2t value	$t_p=10\text{ms}$	3.1	A^2s	
di_T/dt	Critical rate of rise of on-state current	$I_G=2 \cdot I_{GT}$, $t_r \leq 10\text{ns}$, $F=120\text{Hz}$, $T_j=125^{\circ}C$	I - II - III	50	$A/\mu s$
			IV	10	
I_{GM}	Peak gate current	$t_p=20\mu s$, $T_j=125^{\circ}C$	2	A	
$P_{G(AV)}$	Average gate power	$T_j=125^{\circ}C$	0.5	W	
T_{STG}	Storage temperature		-40~+150	$^{\circ}C$	
T_j	Operating junction temperature		-40~+125		

ELECTRICAL CHARACTERISTICS (T_a=25°C unless otherwise specified)

Symbol	Parameter	Test condition	Value		Unit	
			S	C		
I _{GT}	Gate trigger current	V _D =12V, I _T =0.1A, T _j =25°C, Fig. 6	I - II - III	≤8	≤20	mA
			IV	≤10	≤35	
V _{GT}	Gate trigger voltage	T _j =25°C, Fig. 6	I - II - III - IV	≤1.3		V
V _{GD}	Non-triggering gate voltage	V _D =V _{DRM} , T _j =125°C		≥0.2		V
I _H	Holding current	V _D =12V, I _{GT} =0.1A, T _j =25°C, Fig. 6	I - II - III - IV	≤10	≤15	mA
I _L	Latching current		I - III - IV	≤10	≤15	mA
			II	≤15	≤20	mA
dV _D /dt	Critical rate of rise of off-state	V _D =67%V _{DRM} , Gate Open T _j =125°C		≥10	≥20	V/μs
V _{TM}	On-state Voltage	I _{TM} =6A, tp=380μs, Fig. 4		≤1.55		V
I _{DRM} / I _{RRM}	Repetitive peak off-state current	V _D =V _{DRM} /V _{RRM} , T _j =25°C		≤5	≤5	μA
		V _D =V _{DRM} /V _{RRM} , T _j =125°C		≤0.5	≤0.5	mA

THERMAL RESISTANCES

Symbol	Parameter	Value	Unit
R _{th} (j-c)	Junction to case (AC)	TO-126K	3 °C/W
R _{th} (j-a)	Junction to ambient	TO-126K	100 °C/W

PART NUMBER

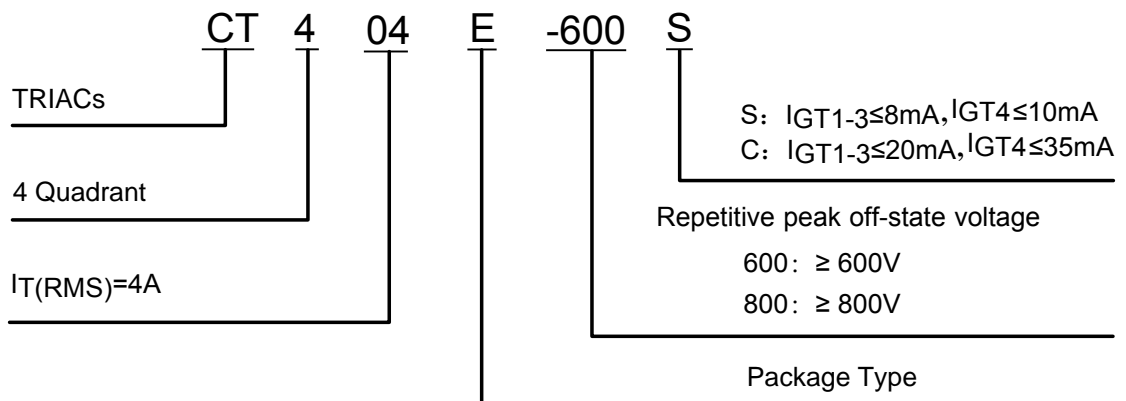

CHARACTERISTICS CURVES

FIG.1: Maximum power dissipation versus RMS on-state current (full cycle)

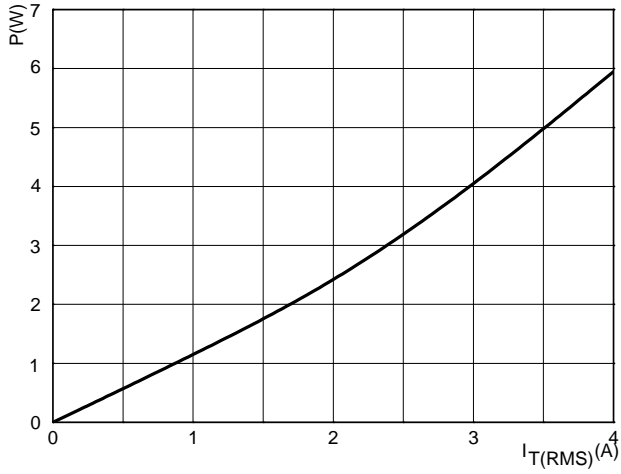

FIG.2: RMS on-state current versus case temperature (full cycle)

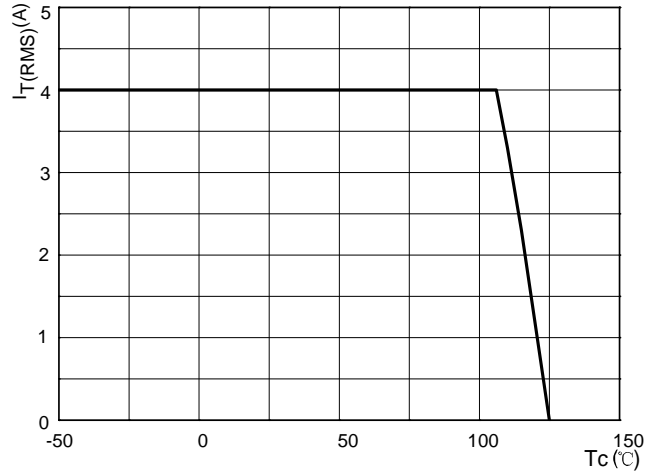

FIG.3: Surge peak on-state current versus number of cycles

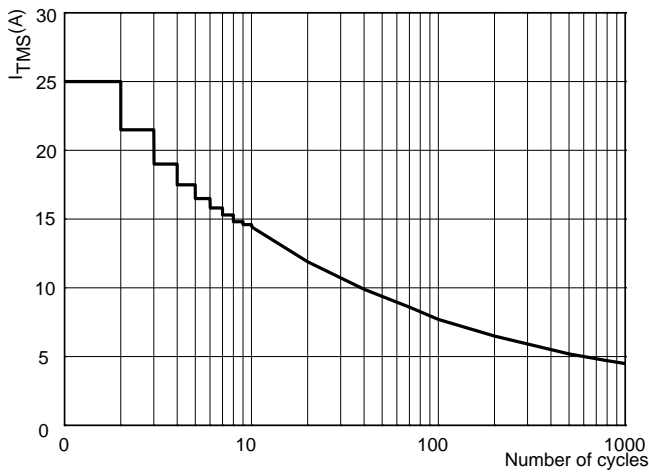

FIG.4: On-state characteristics (maximum values)

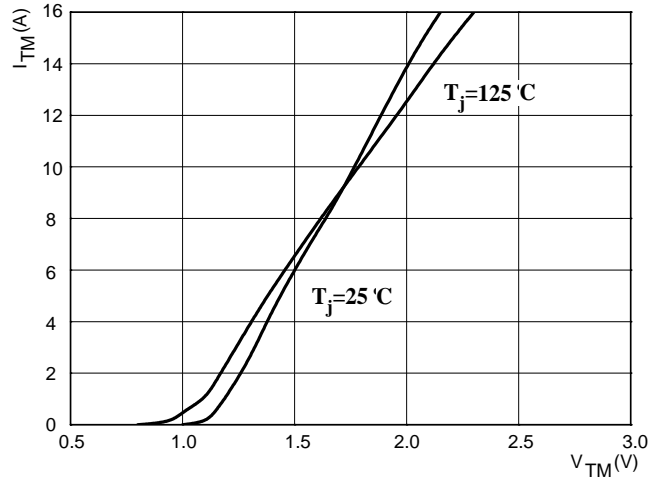

FIG.5: Non-repetitive surge peak on-state current for a sinusoidal pulse with width $t_p < 10\text{ms}$

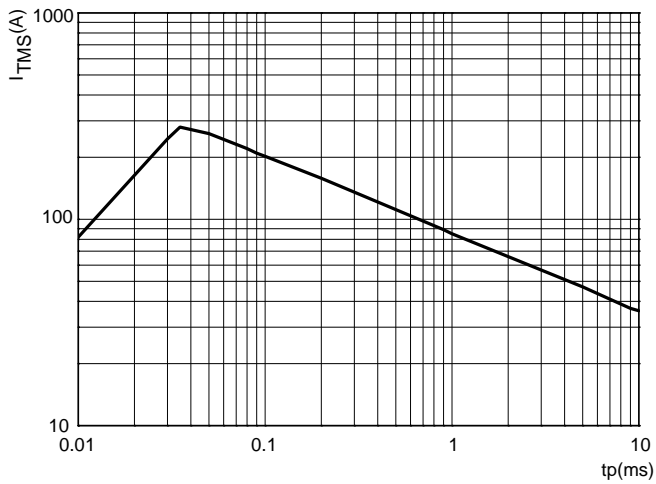
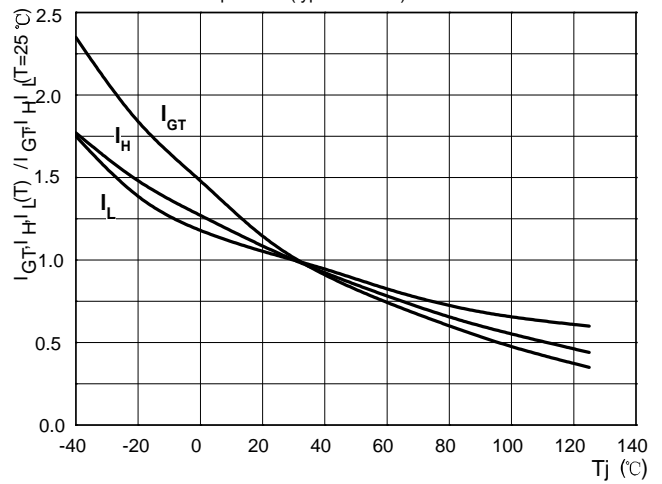
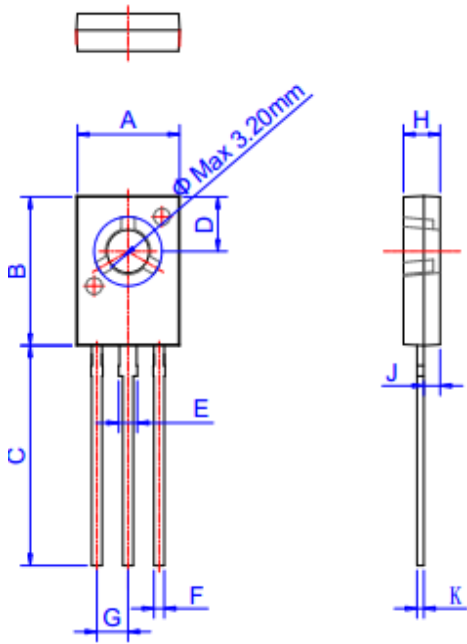

FIG.6: Relative variations of gate trigger current, holding current and latching current versus junction temperature (typical values)



TO-126K PACKAGE OUTLINE DIMENSIONS



Ref.	Dimensions					
	Millimeters			Inches		
	Min.	Typ.	Max.	Min.	Typ.	Max.
A	7.40		7.80	0.291		0.307
B	10.6		11.2	0.417		0.441
C	15.3		16.3	0.602		0.642
D	3.90		4.10	0.154		0.161
E	1.17		1.47	0.046		0.058
F	0.66		0.86	0.026		0.034
G		2.29			0.090	
H	2.50		2.90	0.098		0.114
J	1.10		1.50	0.043		0.059
K	0.45		0.60	0.018		0.024