

■ Specifications :

- Voltage rating: 250V AC / DC
- Current rating: 7A AC / DC
- Withstanding voltage: 1500V AC/minute
- Temperature range: -25°C~+85°C
- Insulation resistance: $\geq 1000M\Omega$
- Contact resistance: $\leq 10m\Omega$
- After environmental testing: $\leq 20m\Omega$

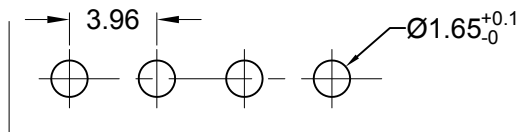
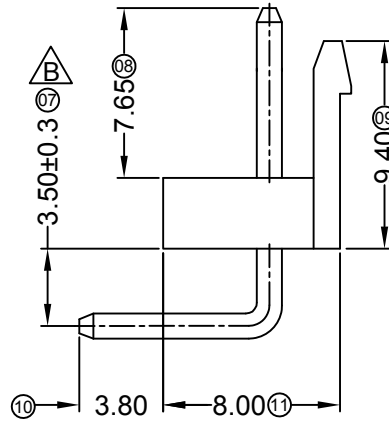
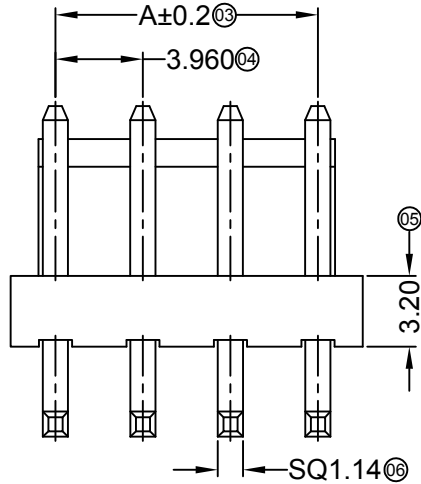

Recommended P.C.B Layout
General Tolerance ± 0.05

Poles	Dimensions(mm)		Poles	Dimensions(mm)	
	A	B		A	B
02	3.96	7.92	08	27.72	31.68
03	7.92	11.88	09	31.68	35.64
04	11.88	15.84	10	35.64	39.60
05	15.84	19.80	11	39.60	43.56
06	19.80	23.76	12	43.56	47.52
07	23.76	27.72			

				TOLERANCE UNLESS OTHERWISE		DRAWN	CK tan	XFCN兴飞连接器有限公司 CONNECTORS XFCN CONNECTORS CO., LTD.		SHEET	1/1
				X.	± 0.30	X°	$\pm 5^\circ$			CHKD	DATE
				.X	± 0.20	.X°	$\pm 2^\circ$	APPD	PRODUCT NAME	3.96mm Crimp Style Connectors	
				.XX	± 0.08	.XX°	$\pm 1^\circ$	VIEW	PART. NO.	M3960R-XX	
				.XXX	± 0.03	.XXX°	$\pm 0.5^\circ$			SCALE	1:1
				AO	MODIFICATION	DATE				DWG NO.	009